

REMOVAL ITEMS

CONTRACT NO. 64178			
F.A.P. RTE.	SECTION	COUNTY	TOTAL SHEETS
549	116RS-1	OGLE	593
SHEET NO.		128	
STA.	TO STA.		
FED. ROAD DIST. NO.	ILLINOIS	FED. AID PROJECT	

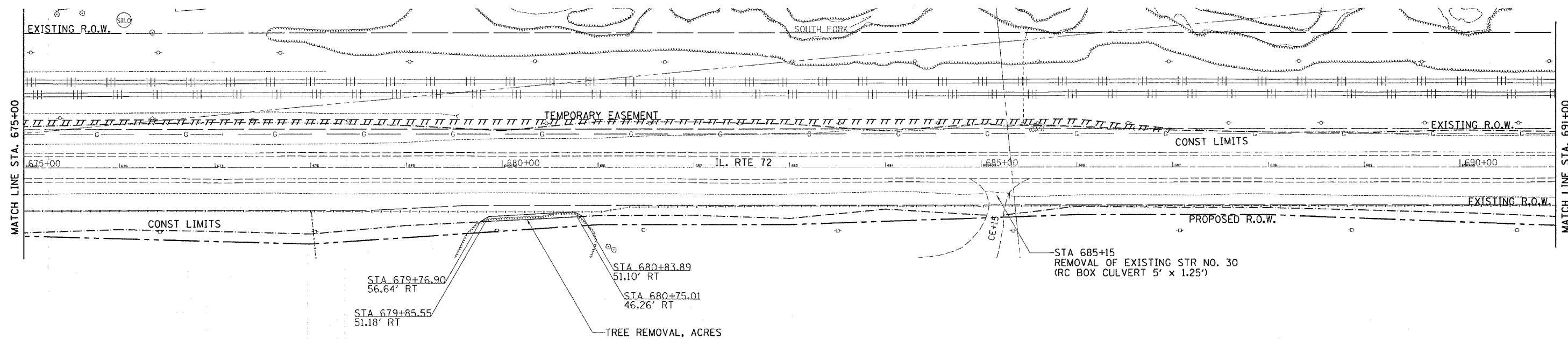

ALL RAILROAD COMMUNICATION POLES LOCATED WITHIN TEMPORARY EASEMENT LIMITS, INCLUDING WIRING AND GUY WIRES, SHALL BE REMOVED BY AND BECOME THE PROPERTY OF THE CONTRACTOR. THIS WORK SHALL BE INCLUDED IN THE UNIT COST PER CUBIC YARD FOR EARTH EXCAVATION. LT. STA. 697+00 TO THE END OF THE PROJECT.

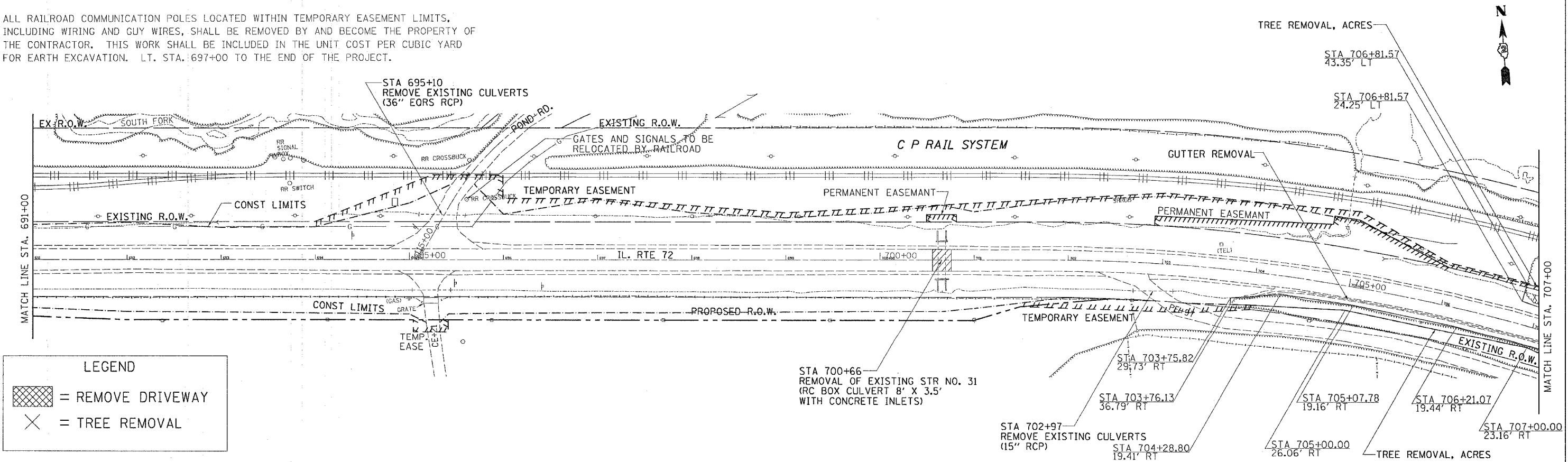

LEGEND	
	= REMOVE DRIVEWAY
	= TREE REMOVAL

PLOT DATE = Wed Feb 09 07:46:21 2005
 FILE NAME = C:\projects\200417\809497rem.dgn
 PLOT SCALE = 50.0000' / IN.
 REFERENCE = BRIG*