

ROUTE	SECTION	COUNTY	TOTAL SHEETS	SHEET NUMBER
FAP 343	531-4HBK-I-2	COOK	10	1

FOR INDEX OF SHEETS SEE SHEET 2

**STATE OF ILLINOIS
DEPARTMENT OF TRANSPORTATION
DIVISION OF HIGHWAYS
DISTRICT ONE
PROPOSED HIGHWAY PLANS**

CONTRACT NO. 62865

D-91-042-05

**IMPROVEMENT IS
LOCATED IN THE VILLAGE
OF PALATINE**

FAP 343: ILLINOIS ROUTE 68
OVER ILLINOIS ROUTE 53
SECTION: 531-4HBK-I-2
BEAM REPLACEMENT
COOK COUNTY
C-91-042-05

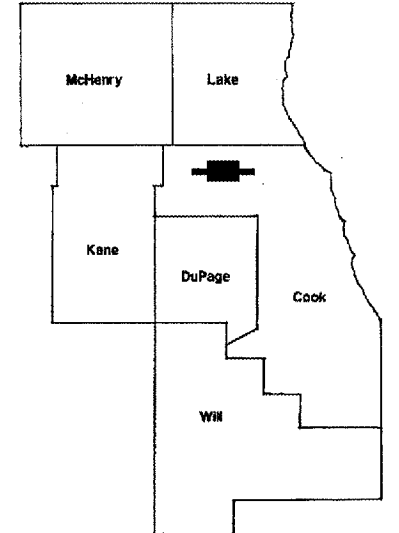

LOCATION OF IMPROVEMENT INDICATED THUS:

**LOCATION OF
IMPROVEMENT AT
S.N.: 016-0961**

TRAFFIC DATA:

IL RTE. 53:
SPEED LIMIT = 55 MPH
2003 ADT = 93,400

IL RTE. 68:
SPEED LIMIT = 45 MPH
2003 ADT = 38,800

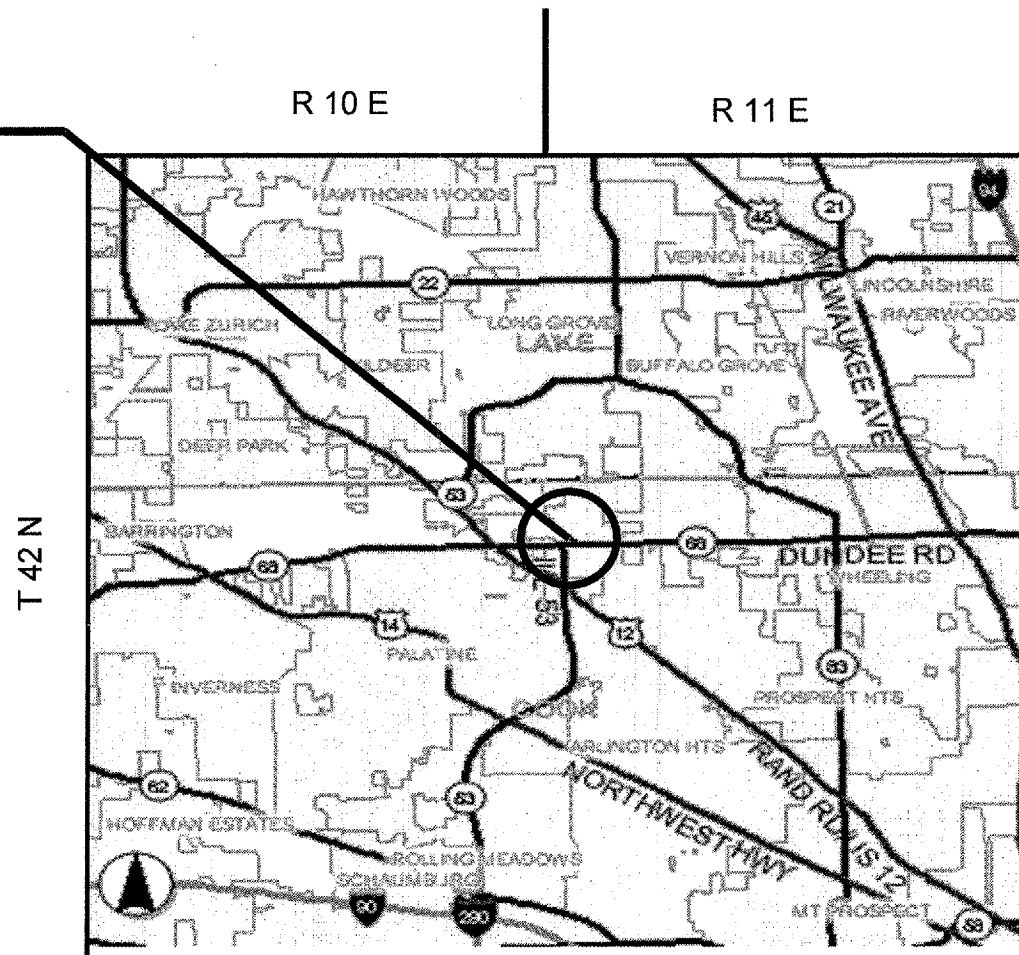

**STATE OF ILLINOIS
DEPARTMENT OF TRANSPORTATION
DIVISION OF HIGHWAYS**

SUBMITTED: March 23, 2005
Diane O'Keefe
DEPUTY DIRECTOR OF HIGHWAYS, REGION ENGINEER

May 13, 2005
Mike Nene
ENGINEER OF DESIGN AND ENVIRONMENT

May 13, 2005
Victor Modesto
DIRECTOR, DIVISION OF HIGHWAYS

**PRINTED BY THE AUTHORITY
OF THE STATE OF ILLINOIS**

**J.U.L.I.E.: JOINT UTILITY LOCATION
INFORMATION FOR EXCAVATION
(312) 744-7000**

DISTRICT ONE - DESIGN - PLAN PREPARATION ENGINEER:
KEN ENG / ROBERT BORO (847) 705-4178

CONTRACT NO. 62865

PALATINE TOWNSHIP