

F. & S. NO.	SECTION	COUNTY	TOTAL SHEETS	SHEET NO.
1581	*		21	9
STA.		TO STA.		
FED. ROAD DIST. NO. 7		ILLINOIS		
		FED. AID PROJECT		

*(0202 & 0208) RS-8
62748

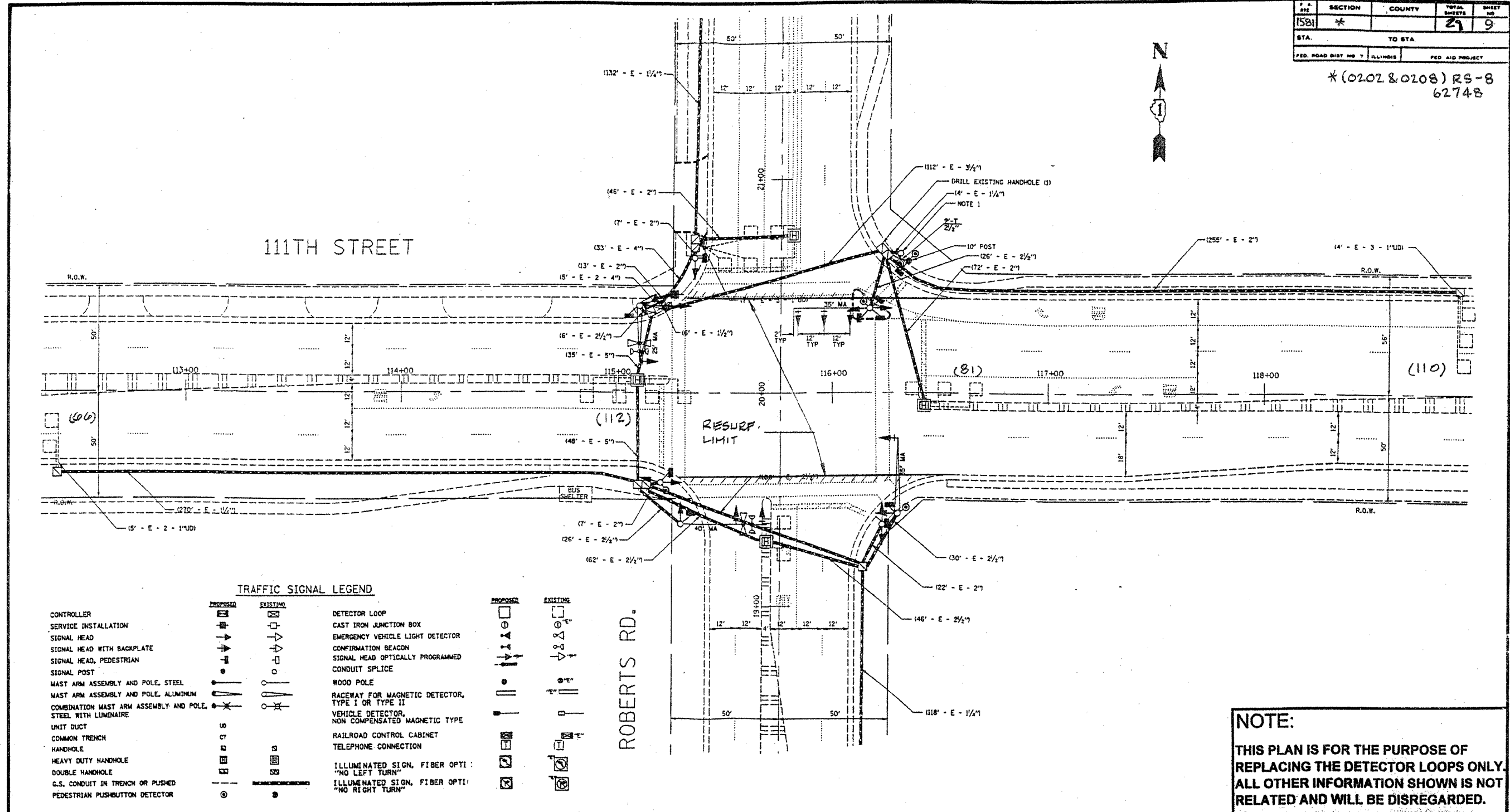

TRAFFIC SIGNAL LEGEND		
PROPOSED	EXISTING	
[Symbol]	[Symbol]	DETECTOR LOOP
[Symbol]	[Symbol]	CAST IRON JUNCTION BOX
[Symbol]	[Symbol]	EMERGENCY VEHICLE LIGHT DETECTOR
[Symbol]	[Symbol]	CONFIRMATION BEACON
[Symbol]	[Symbol]	SIGNAL HEAD OPTICALLY PROGRAMMED
[Symbol]	[Symbol]	CONDUIT SPLICE
[Symbol]	[Symbol]	WOOD POLE
[Symbol]	[Symbol]	RACEWAY FOR MAGNETIC DETECTOR, TYPE I OR TYPE II
[Symbol]	[Symbol]	VEHICLE DETECTOR, NON COMPENSATED MAGNETIC TYPE
[Symbol]	[Symbol]	RAILROAD CONTROL CABINET
[Symbol]	[Symbol]	TELEPHONE CONNECTION
[Symbol]	[Symbol]	ILLUMINATED SIGN, FIBER OPTI: "NO LEFT TURN"
[Symbol]	[Symbol]	ILLUMINATED SIGN, FIBER OPTI: "NO RIGHT TURN"
[Symbol]	[Symbol]	CONTROLLER
[Symbol]	[Symbol]	SERVICE INSTALLATION
[Symbol]	[Symbol]	SIGNAL HEAD
[Symbol]	[Symbol]	SIGNAL HEAD WITH BACKPLATE
[Symbol]	[Symbol]	SIGNAL HEAD, PEDESTRIAN
[Symbol]	[Symbol]	SIGNAL POST
[Symbol]	[Symbol]	MAST ARM ASSEMBLY AND POLE, STEEL
[Symbol]	[Symbol]	MAST ARM ASSEMBLY AND POLE, ALUMINUM
[Symbol]	[Symbol]	COMBINATION MAST ARM ASSEMBLY AND POLE, STEEL WITH LUMINAIRE
[Symbol]	[Symbol]	UNIT DUCT
[Symbol]	[Symbol]	COMMON TRENCH
[Symbol]	[Symbol]	HANDHOLE
[Symbol]	[Symbol]	HEAVY DUTY HANDHOLE
[Symbol]	[Symbol]	DOUBLE HANDHOLE
[Symbol]	[Symbol]	G.S. CONDUIT IN TRENCH OR PUSHED
[Symbol]	[Symbol]	PEDESTRIAN PUSHBUTTON DETECTOR

NOTE:
THIS PLAN IS FOR THE PURPOSE OF REPLACING THE DETECTOR LOOPS ONLY. ALL OTHER INFORMATION SHOWN IS NOT RELATED AND WILL BE DISREGARDED.

REPLACE ALL DETECTOR LOOPS AS SHOWN
(WITHIN THE RESURFACING LIMITS)

CODE NO.	QUANTITY	UNIT	ITEM
86600600	369	Foot	Detector Loop Replacement

REVISIONS	
NAME	DATE

ILLINOIS DEPARTMENT OF TRANSPORTATION
DETECTOR LOOP REPLACEMENT
111TH STREET @ ROBERTS ROAD
SCALE: 1" = 20'
DATE: MAR. 04
DRAWN BY: _____
DESIGNED BY: _____
CHECKED BY: _____