

|                       |            |          |                  |           |
|-----------------------|------------|----------|------------------|-----------|
| F.A.P. RTE.           | SECTION    | COUNTY   | TOTAL SHEETS     | SHEET NO. |
| 330                   | 2004-018TS | COOK     | 28               | 13        |
| STA.                  |            | TO STA.  |                  |           |
| FED. ROAD DIST. NO. 1 |            | ILLINOIS | FED. AID PROJECT |           |
| CONTRACT NO. 62737    |            |          |                  |           |

**EXISTING EQUIPMENT TO BE REMOVED LEGEND**

- ▲ EXISTING SIGNAL HEAD TO BE REMOVED
- "E" EXISTING SERVICE INSTALLATION TO BE REMOVED
- EXISTING SIGNAL POST AND FOUNDATION TO BE REMOVED
- ⊖ EXISTING ALUMINUM MAST ARM POLE AND FOUNDATION TO BE REMOVED
- ⊗ "E" EXISTING CONTROLLER AND FOUNDATION TO BE REMOVED
- ⊠ "E" EXISTING HANDHOLE TO BE REMOVED
- ⊞ EXISTING PEDESTRIAN SIGNAL HEAD TO BE REMOVED
- ⊙ EXISTING PEDESTRIAN PUSHBUTTON TO BE REMOVED
- ⊗ EXISTING EMERGENCY VEHICLE LIGHT DETECTOR TO BE REMOVED
- ⊞ EXISTING CONFIRMATION BEACON TO BE REMOVED
- ⊠ "E" EXISTING HEAVY-DUTY HANDHOLE TO BE REMOVED
- ⊙ EXISTING STEEL MAST ARM POLE AND FOUNDATION TO BE REMOVED
- ⊞ EXISTING JUNCTION BOX TO BE REMOVED

THE FOLLOWING EXISTING TRAFFIC SIGNAL EQUIPMENT SHALL BE REMOVED BY THE CONTRACTOR, SHALL REMAIN THE PROPERTY OF THE STATE AND SHALL BE DELIVERED BY THE CONTRACTOR TO THE STATE'S TRAFFIC SIGNAL MAINTENANCE CONTRACTOR'S MAIN FACILITY AS PER THE TRAFFIC SIGNAL SPECIFICATIONS:

- 1 EACH CONTROLLER AND CABINET (COMPLETE)

THE FOLLOWING ITEMS SHALL BE REMOVED BY THE CONTRACTOR AND SHALL BE DISPOSED OF BY THEM OUTSIDE THE RIGHT-OF-WAY AT THEIR EXPENSE. THE SALVAGE VALUE OF THE REMOVED EQUIPMENT SHALL BE REFLECTED IN THE CONTRACT BID PRICE.

- 1 EACH SERVICE INSTALLATION
- 3 EACH SIGNAL HEAD, 1-FACE
- 3 EACH SIGNAL HEAD, 2-FACE
- 2 EACH MAST ARM ASSEMBLY AND POLE
- 1 EACH TRAFFIC SIGNAL POST

**NOTES:**

1. TREE PRUNING SHALL BE IN ACCORDANCE WITH APPLICABLE PORTIONS OF SECTION 201 OF THE STANDARD SPECIFICATIONS AND AS DIRECTED BY THE ENGINEER.
2. THE EXISTING CONCRETE MEDIAN SHALL BE REMOVED AND REPLACED BY CLASS D PATCHING, TYPE III

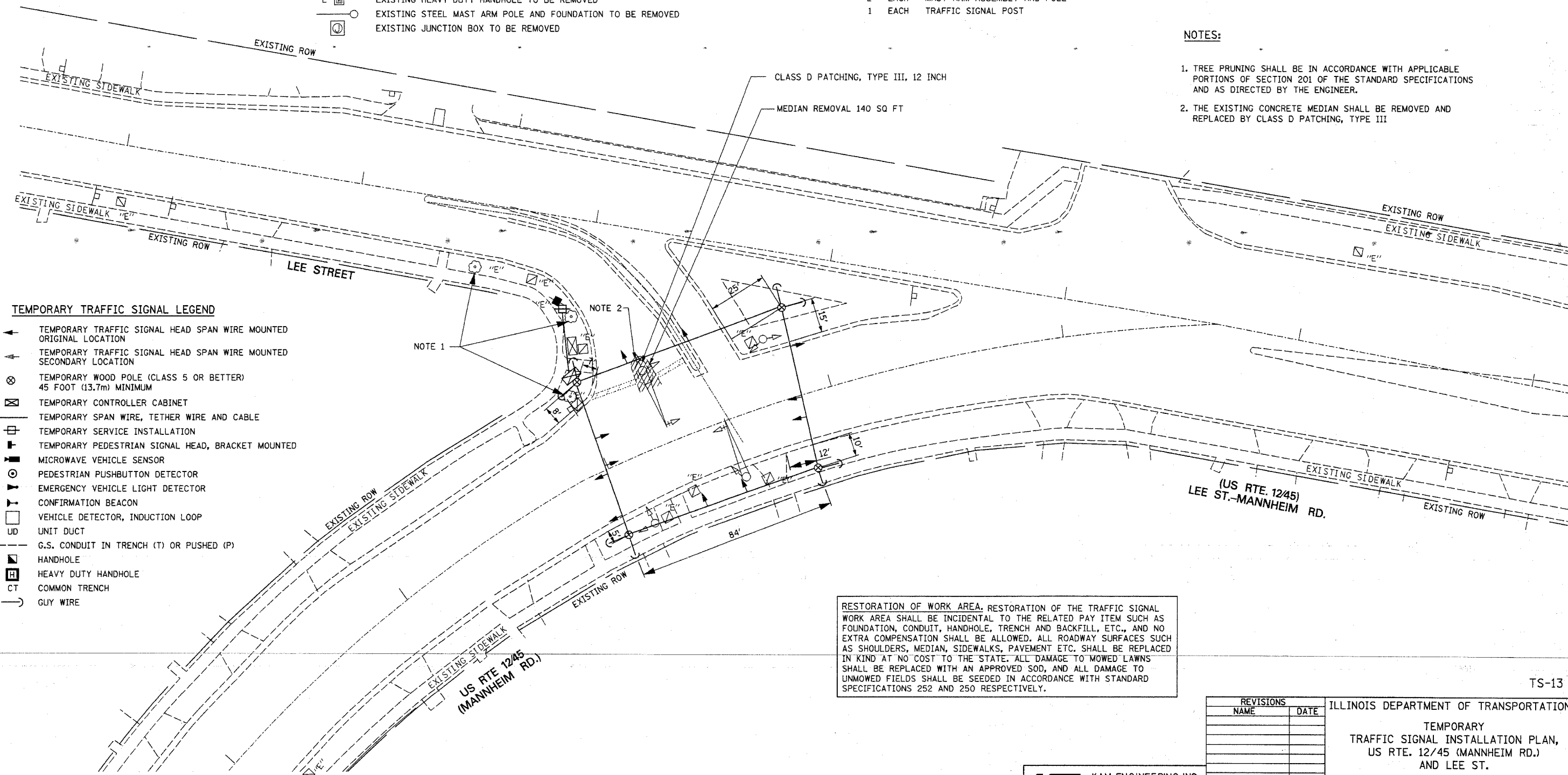

**TEMPORARY TRAFFIC SIGNAL LEGEND**

- ▲ TEMPORARY TRAFFIC SIGNAL HEAD SPAN WIRE MOUNTED ORIGINAL LOCATION
- ▲ TEMPORARY TRAFFIC SIGNAL HEAD SPAN WIRE MOUNTED SECONDARY LOCATION
- ⊗ TEMPORARY WOOD POLE (CLASS 5 OR BETTER) 45 FOOT (13.7m) MINIMUM
- ⊞ TEMPORARY CONTROLLER CABINET
- ⊞ TEMPORARY SPAN WIRE, TETHER WIRE AND CABLE
- ⊞ TEMPORARY SERVICE INSTALLATION
- ⊞ TEMPORARY PEDESTRIAN SIGNAL HEAD, BRACKET MOUNTED
- ⊞ MICROWAVE VEHICLE SENSOR
- ⊞ PEDESTRIAN PUSHBUTTON DETECTOR
- ⊞ EMERGENCY VEHICLE LIGHT DETECTOR
- ⊞ CONFIRMATION BEACON
- ⊞ VEHICLE DETECTOR, INDUCTION LOOP
- UD UNIT DUCT
- G.S. CONDUIT IN TRENCH (T) OR PUSHED (P)
- ⊞ HANDHOLE
- ⊞ HEAVY DUTY HANDHOLE
- CT COMMON TRENCH
- GUY WIRE

**RESTORATION OF WORK AREA:** RESTORATION OF THE TRAFFIC SIGNAL WORK AREA SHALL BE INCIDENTAL TO THE RELATED PAY ITEM SUCH AS FOUNDATION, CONDUIT, HANDHOLE, TRENCH AND BACKFILL, ETC., AND NO EXTRA COMPENSATION SHALL BE ALLOWED. ALL ROADWAY SURFACES SUCH AS SHOULDERS, MEDIAN, SIDEWALKS, PAVEMENT ETC. SHALL BE REPLACED IN KIND AT NO COST TO THE STATE. ALL DAMAGE TO MOWED LAWNS SHALL BE REPLACED WITH AN APPROVED SOD, AND ALL DAMAGE TO UNMOWED FIELDS SHALL BE SEEDED IN ACCORDANCE WITH STANDARD SPECIFICATIONS 252 AND 250 RESPECTIVELY.

| REVISIONS |      |
|-----------|------|
| NAME      | DATE |
|           |      |
|           |      |
|           |      |
|           |      |
|           |      |
|           |      |
|           |      |
|           |      |
|           |      |
|           |      |

ILLINOIS DEPARTMENT OF TRANSPORTATION  
 TEMPORARY TRAFFIC SIGNAL INSTALLATION PLAN,  
 US RTE. 12/45 (MANNHEIM RD.)  
 AND LEE ST.

SCALE: 1"=20'  
 DATE: FEBRUARY, 2005

DRAWN BY: RV/MD  
 DESIGNED BY: DS  
 CHECKED BY: AS/KG

**K&E** KAM ENGINEERING, INC.  
 CONSULTING ENGINEERS  
 707A Davis Road, Suite 205  
 Elgin, Illinois 60123-1369