

F.A.P. RTE.	SECTION	COUNTY	TOTAL SHEETS	SHEET NO.
334	2004-017TS	COOK	38	32
STA.		TO STA.		
FED. ROAD DIST. NO. 1		ILLINOIS FED. AID PROJECT		
CONTRACT #62736				

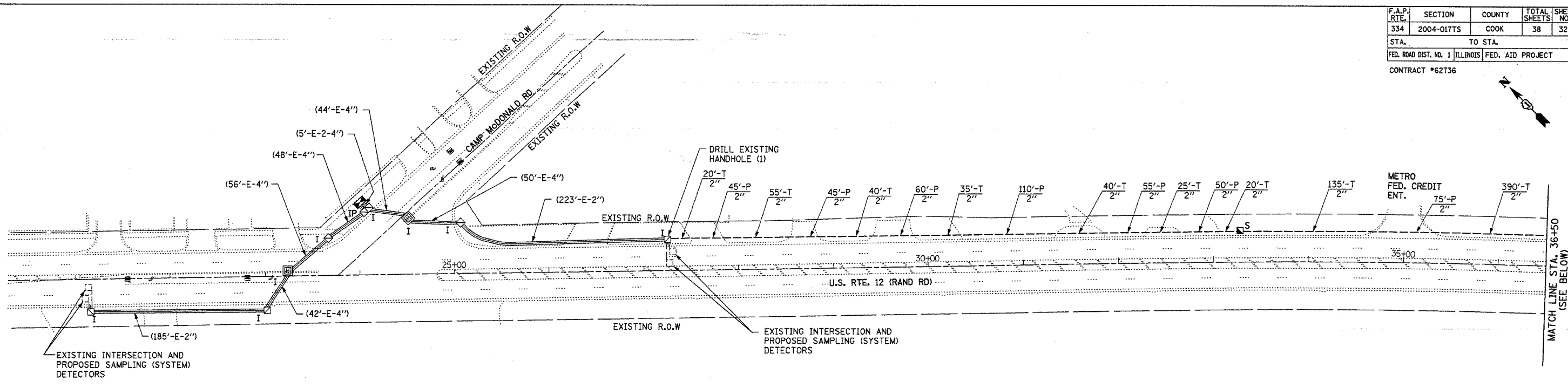

**INTERCONNECT PLAN LEGEND**

PROPOSED	EXISTING	
		CONTROLLER
		HANDHOLE
		DOUBLE HANDHOLE
		HEAVY-DUTY HANDHOLE
		G.S. CONDUIT IN TRENCH (T) OR PUSHED (P)
		DETECTOR LOOP
CT		COMMON TRENCH
UD		UNIT DUCT
S		SYSTEM
IP	I	INTERSECTION

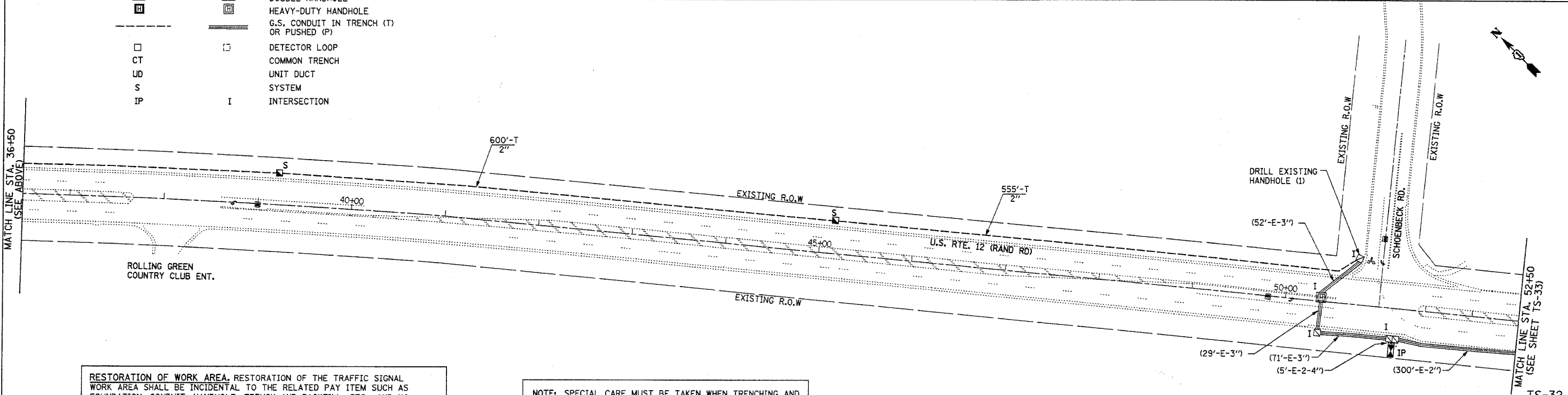

RESTORATION OF WORK AREA, RESTORATION OF THE TRAFFIC SIGNAL WORK AREA SHALL BE INCIDENTAL TO THE RELATED PAY ITEM SUCH AS FOUNDATION, CONDUIT, HANDHOLE, TRENCH AND BACKFILL, ETC., AND NO EXTRA COMPENSATION SHALL BE ALLOWED. ALL ROADWAY SURFACES SUCH AS SHOULDERS, MEDIAN, SIDEWALKS, PAVEMENT ETC. SHALL BE REPLACED IN KIND. ALL DAMAGE TO MOWED LAWNS SHALL BE REPLACED WITH AN APPROVED SOD, AND ALL DAMAGE TO UNMOWED FIELDS SHALL BE SEEDD IN ACCORDANCE WITH STANDARD SPECIFICATIONS 252 AND 250 RESPECTIVELY.

NOTE: SPECIAL CARE MUST BE TAKEN WHEN TRENCHING AND PUSHING CONDUIT, INSTALLING HANDHOLES, ETC. TO AVOID HITTING BURIED CABLES, UTILITIES, TREES, ORNAMENTAL PLANTS, ETC.

REVISIONS	
NAME	DATE

ILLINOIS DEPARTMENT OF TRANSPORTATION  
 INTERCONNECT PLAN  
 U.S. ROUTE 12 (RAND RD.)  
 FROM CAMP McDONALD RD. TO/  
 ILL. RTE. 83 (ELMHURST RD.)  
 SHEET 1 OF 3  
 SCALE: 1"=50'  
 DATE: JUNE 15, 2004  
 DRAWN BY: RV/MD  
 DESIGNED BY: AZ  
 CHECKED BY: AZ

**K&E** KAM ENGINEERING, INC.  
 CONSULTING ENGINEERS  
 707A Davis Road, Suite 205  
 Egin, Illinois 60123-1369

G:\projects\JOB 337\SH1\2\inter-1.sht  
 06/09/2004