

F.A.P. RTE.	SECTION	COUNTY	TOTAL SHEETS	SHEET NO.
334	2004-017TS	COOK	38	23
STA.		TO STA.		
FED. ROAD DIST. NO. 1 ILLINOIS		FED. AID PROJECT		
CONTRACT #62736				

**SCHEDULE OF QUANTITIES**

ITEM	UNIT	QNTY.
TRAFFIC CONTROL AND PROTECTION, STANDARD 701501	L SUM	0.11
TRAFFIC CONTROL AND PROTECTION, STANDARD 701606	L SUM	0.11
TRAFFIC CONTROL AND PROTECTION, STANDARD 701701	L SUM	0.11
TRAFFIC CONTROL AND PROTECTION, STANDARD 701801	L SUM	0.11
MAINTENANCE OF EXISTING TRAFFIC SIGNAL INSTALLATION	EACH	1
FULL-ACTUATED CONTROLLER AND TYPE IV CABINET (SPECIAL)	EACH	1
TRANSCIVER - FIBER OPTIC	EACH	1
ELECTRIC CABLE IN CONDUIT, SERVICE, NO. 6 2 C	FOOT	139
ELECTRIC CABLE IN CONDUIT, GROUNDING, NO. 6 1C	FOOT	139
INDUCTIVE LOOP DETECTOR	EACH	7
REMOVE ELECTRIC CABLE FROM CONDUIT	FOOT	120
REMOVE EXISTING TRAFFIC SIGNAL EQUIPMENT	EACH	1
SERVICE INSTALLATION, POLE MOUNT	EACH	1
SIGNAL HEAD, L.E.D., 1-FACE, 3-SECTION MAST ARM MOUNTED	EACH	1
SIGNAL HEAD, L.E.D., 1-FACE, 5-SECTION MAST ARM MOUNTED	EACH	4
SIGNAL HEAD, L.E.D., 2-FACE, 3-SECTION 1-5 SECTION, BRACKET MOUNTED	EACH	2
SIGNAL HEAD, L.E.D., 3-FACE, 1-3 SECTION, 2-5 SECTION, BRACKET MOUNTED	EACH	2
TRAFFIC SIGNAL BACKPLATE, LOUVERED, ALUMINUM	EACH	8
TRAFFIC SIGNAL POST, GALVANIZED STEEL 16 FT.	EACH	2
PEDESTRIAN SIGNAL HEAD, L.E.D., 1-FACE, BRACKET MOUNTED	EACH	2
PEDESTRIAN PUSH-BUTTON	EACH	2
ELECTRIC CABLE IN CONDUIT, SIGNAL NO. 14 2C	FOOT	210
ELECTRIC CABLE IN CONDUIT, SIGNAL NO. 14 3C	FOOT	216

**CONSTRUCTION NOTES:**

- REMOVE EXISTING CONTROLLER AND CABINET. INSTALL NEW CONTROLLER AND TYPE IV CABINET. RE-USE EXISTING FOUNDATION. RELOCATE EXISTING EMERGENCY VEHICLE PRIORITY SYSTEM PHASING UNIT TO NEW CONTROLLER CABINET INCLUDED IN COST OF THE NEW CONTROLLER AND CABINET.
- REMOVE EXISTING SERVICE CABLE AND SERVICE. INSTALL NEW SERVICE, SERVICE CABLE AND GROUND CABLE.

TS-23

REVISIONS		ILLINOIS DEPARTMENT OF TRANSPORTATION
NAME	DATE	
		CABLE PLAN, PHASE DESIGNATION DIAGRAM, EMERGENCY VEHICLE PREEMPTION SEQUENCE AND SCHEDULE OF QUANTITIES ILL. ROUTE 83 (ELMHURST RD.) AT RANDHURST SOUTH DRIVE/MEADOW LANE
SCALE: NONE		DRAWN BY: BCK
DATE: 3/22/2005		DESIGNED BY: SM
		CHECKED BY: DAD

**CABLE PLAN LEGEND**

- | EXISTING | PROPOSED |   |
|----------|----------|---|
|          |          | 8" (200mm) TRAFFIC SIGNAL SECTION   |
|          |          | 12" (300mm) TRAFFIC SIGNAL SECTION  |
|          |          | 12" (300mm) PEDESTRIAN SIGNAL SECTION   |
|          |          | CONTROLLER CABINET  |
|          |          | SERVICE INSTALLATION  |
|          |          | VEHICLE DETECTOR, INDUCTION LOOP  |
|          |          | TELEPHONE INSTALLATION  |
|          |          | MAGNETIC DETECTOR   |
|          |          | EMERGENCY VEHICLE LIGHT DETECTOR  |
|          |          | CONFIRMATION BEACON   |
|          |          | PUSHBUTTON DETECTOR   |
|          |          | DENOTES NUMBER OF CONDUCTORS. ALL CABLE NO. 14 EXCEPT AS INDICATED. ALL LOOP DETECTOR CABLE TO BE SHIELDED. |
|          |          | GROUND CABLE IN CONDUIT NO. 6 SOLID COPPER (GREEN)  |
|          |          | FIBER OPTIC CABLE IN CONDUIT NO. 62.5/125 2-MMI2F SMI2F   |
|          |          | SIGNAL FACE WITH BACKPLATE "P" INDICATES PROGRAMMED HEAD.   |
|          |          | RAILROAD CONTROL CABINET  |
|          |          | ILLUMINATED SIGN "NO LEFT TURN"   |
|          |          | ILLUMINATED SIGN "NO RIGHT TURN"  |
|          |          | GROUND ROD AT HANDHOLE (H), DOUBLE HANDHOLE (H), OR CONTROLLER (C)  |
|          |          | GROUND ROD AT POST (P) OR MAST ARM POLE (MA)  |
|          |          | GROUND ROD AT ELECTRIC SERVICE INSTALLATION   |

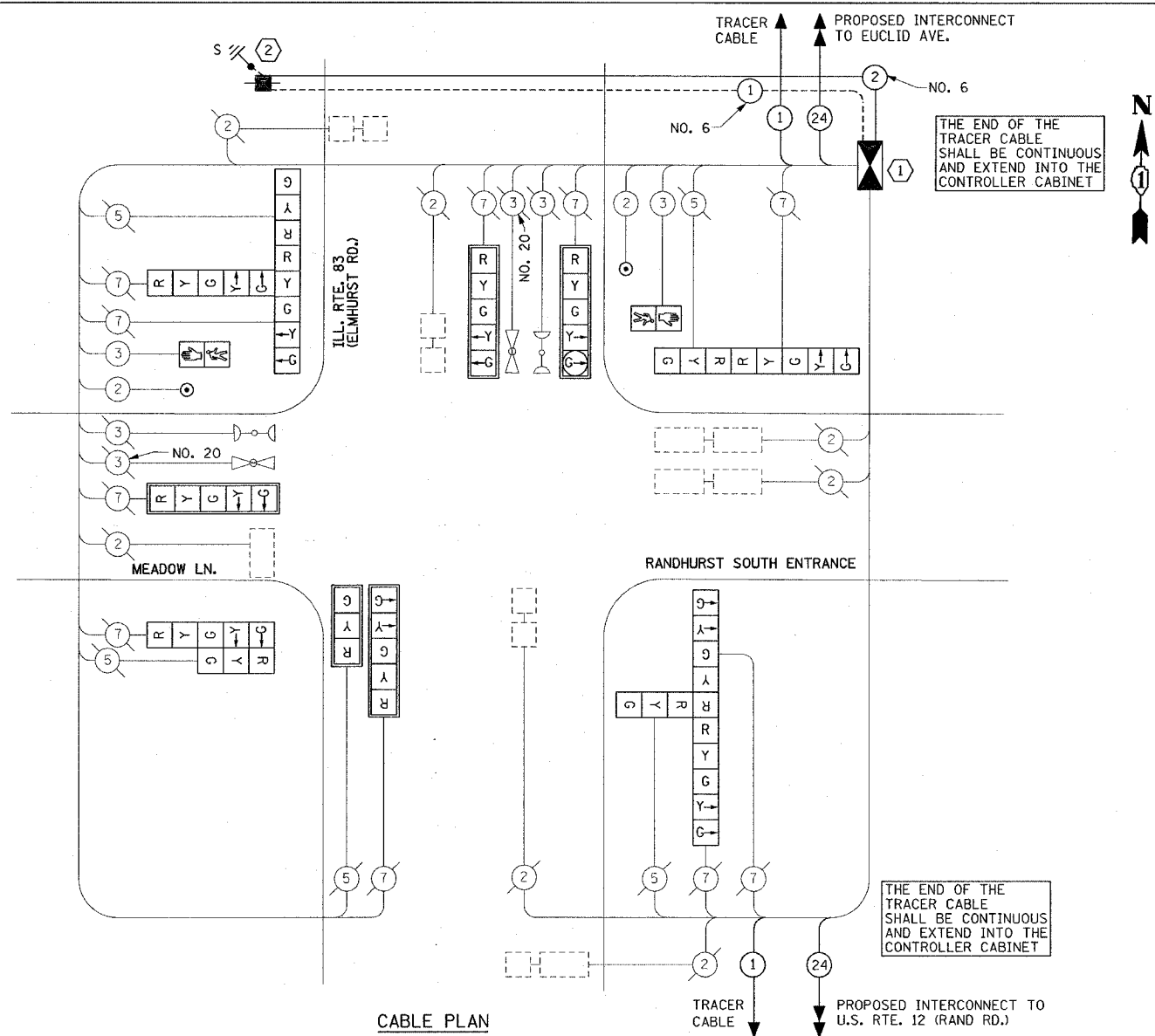

**CABLE PLAN**  
NOT TO SCALE

NOTE: THE PROPOSED TRAFFIC SIGNAL CONTROL EQUIPMENT FOR THIS PROJECT IS "ECONOLITE".

I.D.O.T. TRAFFIC SIGNAL INSTALLATION ELECTRICAL SERVICE REQUIREMENTS					TOTAL WATTAGE
TYPE	NO. LAMPS	WATTAGE INCAND.	WATTAGE LED	% OPERATION	
SIGNAL (RED)	15	135	17	0.50	127.50
(YELLOW)	15	135	25	0.25	93.50
(GREEN)	15	135	15	0.25	56.25
ARROW	20	135	12	0.10	24.00
PED. SIGNAL	2	90	25	1.00	50.00
CONTROLLER	1	100	100	1.00	100.00
ILLUM. SIGN		84	35	0.05	
FLASHER		135	25	0.50	
TOTAL =					451.50

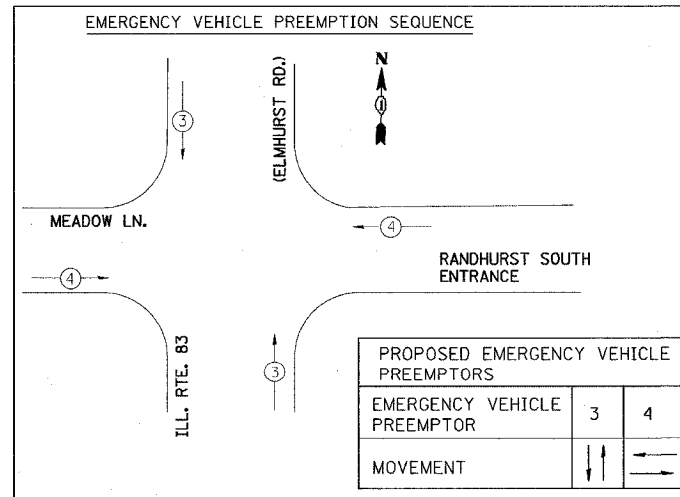
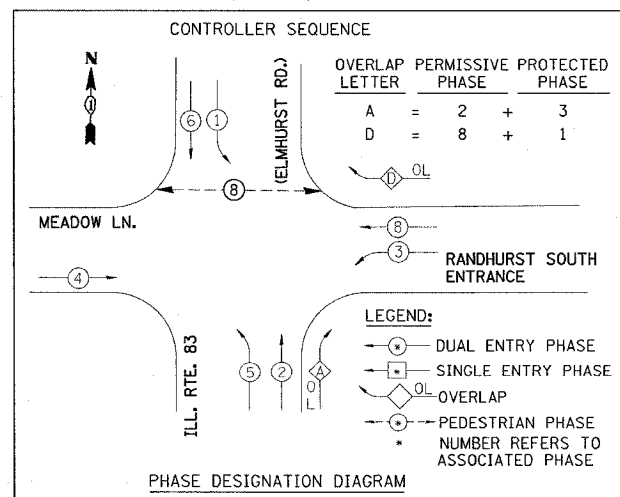

FOUNDATION (DEPTH)	(FT.) (m)	CABLE SLACK	(FT.) (m)	CABLE SLACK	(FT.) (m)
TYPE A - POST	4 (1.2)	HANDHOLE	6.5 (2.0)	ALL FOUNDATIONS	3.5 (1.0)
D - CONTROLLER	4 (1.2)	DOUBLE HANDHOLE	15 (4.0)	MAST ARM (L) POLE	20'-H-2' (6m-HL-0.6m)
E - M. ARM POLE		SIGNAL POST	2 (1.0)	BRACKET MOUNTED	13 (4.0)
24" (600mm)	10 (3.0)	CONTROLLER CAB.	1 (0.5)	PED. PUSHBUTTON	4 (1.2)
30" (750mm)	15 (4.6)	FIBER OPTIC	13 (4.0)	ELECTRIC SERVICE	13.5 (4.1)
		ELECTRIC SERVICE	1 (0.5)	SERVICE TO GROUND	13.5 (4.1)
		GROUND CABLE	1 (0.5)	POST MOUNTED	6 (1.8)

c:\projects\traffic\1013000\1183.m32 3/22/2005

3/22/2005  
c:\projects\traffic\1013000\1183.m32  
kch\hphx\ybc