

REF-  
REF-  
REF-

F.A.U. RTE.	SECTION	COUNTY	TOTAL SHEETS	SHEET NO.
3578	1314 RS-3	COOK	23	10
STA. _____ TO STA. _____		FED. ROAD DIST. NO. 1 ILLINOIS FED. AID PROJECT		

CONTRACT 62673

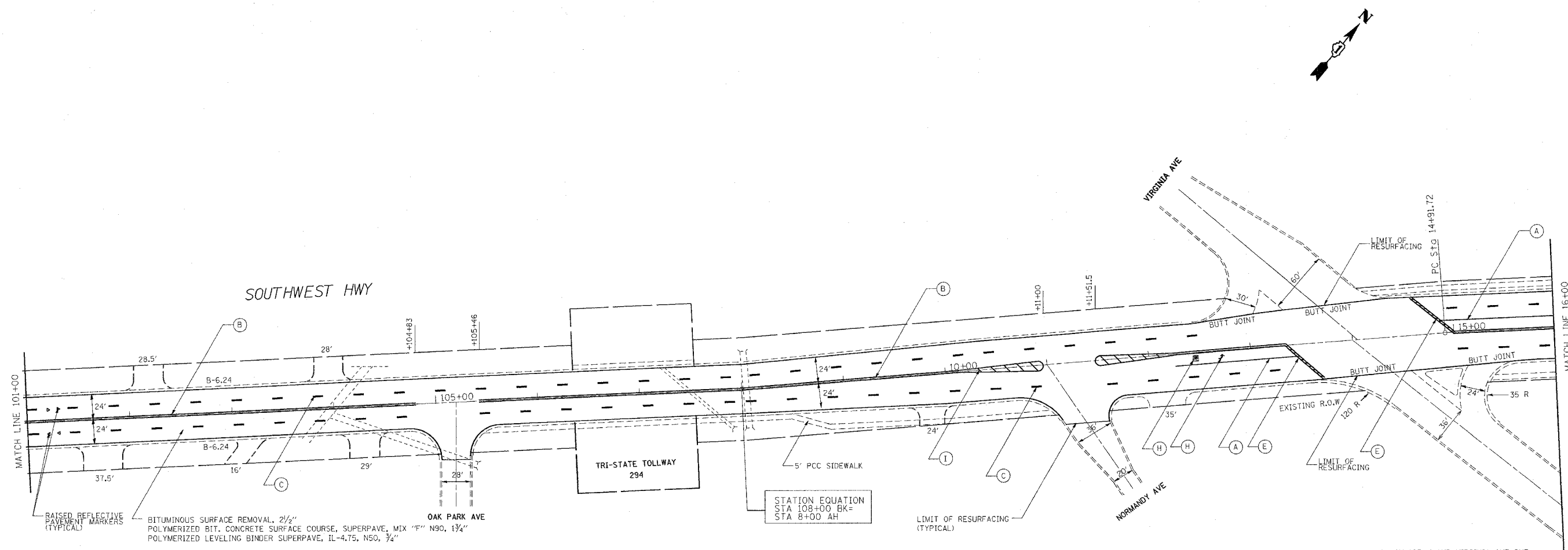

NOTE: PAVEMENT MARKINGS (TYPICAL FOR ALL SHEETS)

- (A) TURN LANE LINE - 6" SOLID WHITE
- (B) CENTERLINE - 4" SOLID YELLOW (2 @ 11" C-C)
- (C) SKIP-DASH LANE LINE - 4" WHITE (10' DASH & 30' SKIP)
- (D) FIRE LANE - 6" SOLID WHITE (RT. 45 DIAGONALS, 4' C-C)
- (E) STOP & TRANSVERSE LINES 24" SOLID WHITE
- (F) CROSSWALK LINE - 6" SOLID WHITE (2 @ 6' C-C)
- (G) DOTTED LANE LINE - 6" WHITE (2' LINE, 6' SPACE)
- (H) LETTERS & SYMBOLS, 8" WHITE (LEFT & RIGHT TURN ONLY)
- (I) 12" SOLID YELLOW (RT. 45 DIAGONALS)
- (J) MEDIAN EDGE LINE - 4" SOLID YELLOW

REVISIONS		ILLINOIS DEPARTMENT OF TRANSPORTATION
NAME	DATE	
		SOUTHWEST HWY PROPOSED ROADWAY & PAVEMENT MARKING PLANS

SCALE: VERT. 1"= 50'  
HORIZ. DATE 3/28/2005

DRAWN BY \_\_\_\_\_  
CHECKED BY \_\_\_\_\_

3/28/2005 03:28/4005

3/28/2005  
c:\p10\p10\ts\p103604\p103604aa.m32  
wlgreendp