

**NOTES:**

ALL LOOPS SHOWN ARE WITHIN THE RESURFACING LIMITS EXCEPT FAR OUTS ON 22nd STREET.

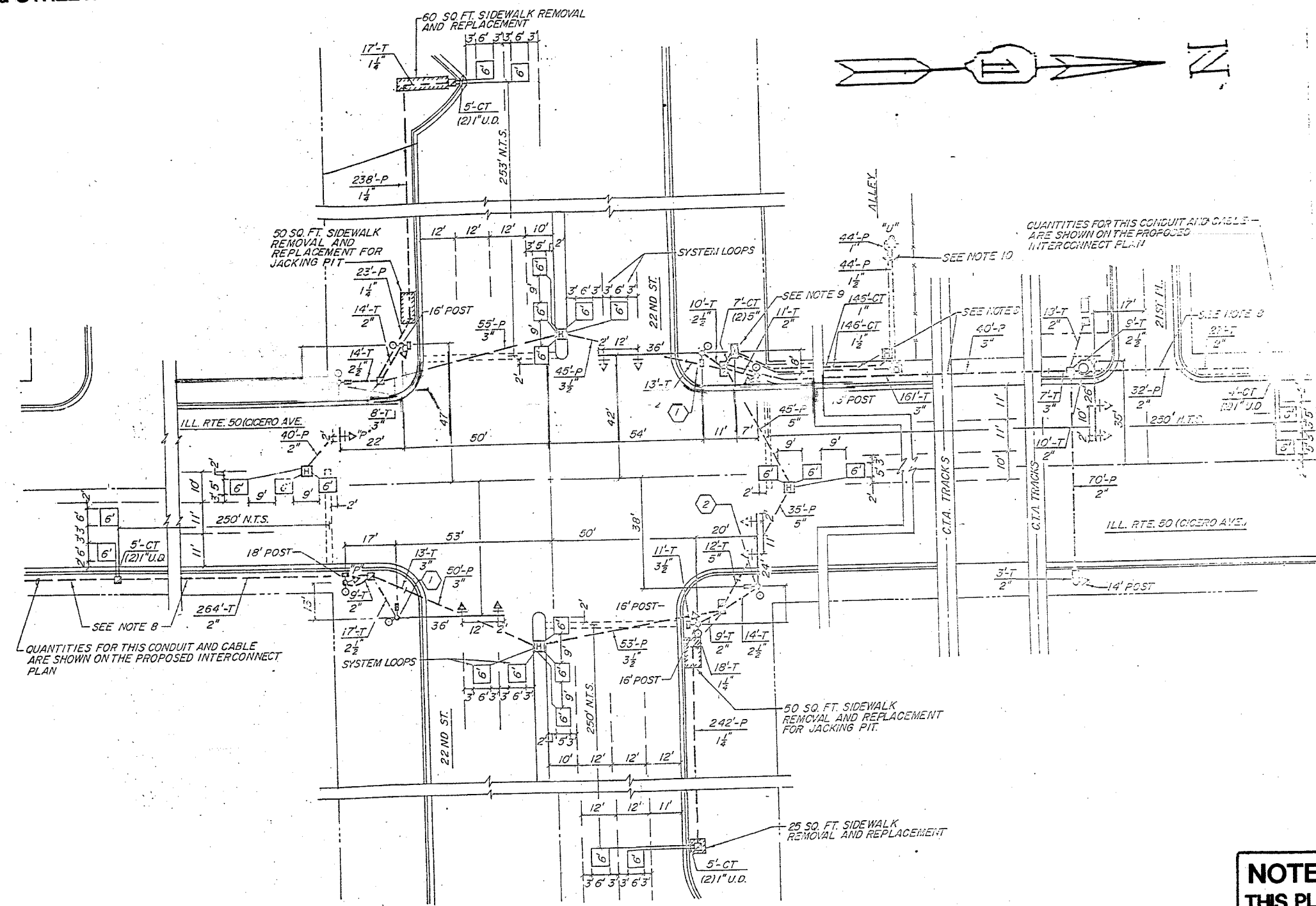

**REPLACE ALL DETECTOR LOOPS AS SHOWN (WITHIN THE RESURFACING LIMITS)**

CODE NO.	QUANTITY	UNIT	ITEM
88600600	688	FOOT	DETECTOR LOOP REPLACEMENT

**NOTE:**  
THIS PLAN IS FOR THE PURPOSE OF REPLACING THE DETECTOR LOOPS. ALL OTHER INFORMATION SHOWN IS NOT RELATED AND WILL BE DISREGARDED.

ILLINOIS DEPARTMENT OF TRANSPORTATION  
DETECTOR LOOPS AT:  
IL RT 50 (CICERO AVE)  
& 22nd STREET

SCALE: 1" =  
DATE  
DESIGNED BY:  
DRAWN BY:  
CHECKED BY:

