

F.A.P. RTE.	SECTION	COUNTY	TOTAL SHEETS	SHEET NO.
337	20R-5	LAKE	562	473
STA. 99+825.000		TO STA. 104+600.00		
FED. ROAD DIST. NO.		ILLINOIS	FED. AID PROJECT	
D-91-552-99		60881		

FINAL SURVEY	SURVEYED	BY	DATE
NO.	PLOTTED		
	AREAS		
	CHECKED		

ORIGINAL SURVEY	SURVEYED	BY	DATE
NO.	PLOTTED		
	AREAS		
	CHECKED		

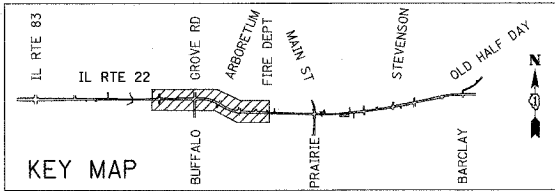
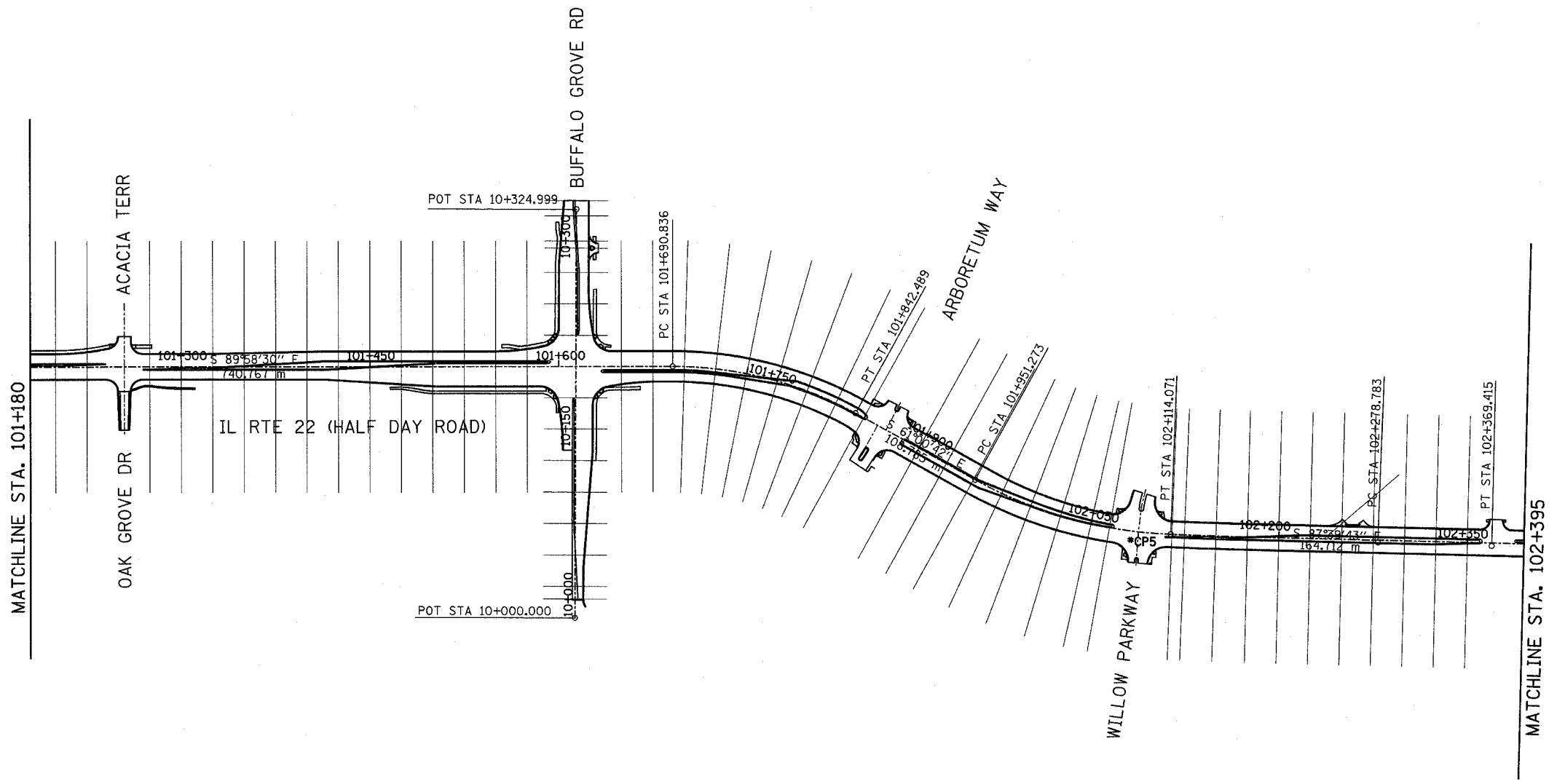

REVISIONS	
NAME	DATE

ILLINOIS DEPARTMENT OF TRANSPORTATION
 IL RTE 22 (FAP 337)
 IL RTE 83 TO US 45 / IL 21 (MILWAUKEE AVE)
CROSS SECTION LOCATIONS
 SHEET 2 OF 4
 SCALE: AS SHOWN DRAWN BY: JNR
 DATE: 03-22-2004 CHECKED BY: JSM