

F.A.P. RTE.	SECTION	COUNTY	TOTAL SHEETS	SHEET NO.
337	20R-5	LAKE	562	375
STA. 101+180		TO STA. 101+800		
FED. ROAD DIST. NO.		ILLINOIS	FED. AID PROJECT	
D-91-552-99		60881		

FINAL SURVEYED	BY	DATE
SURVEY PLOTTED		
NOTE BOOK TEMPLATE		
AREAS CHECKED		
NO.		

ORIGINAL SURVEYED	BY	DATE
SURVEY PLOTTED		
NOTE BOOK TEMPLATE		
AREAS CHECKED		
NO.		

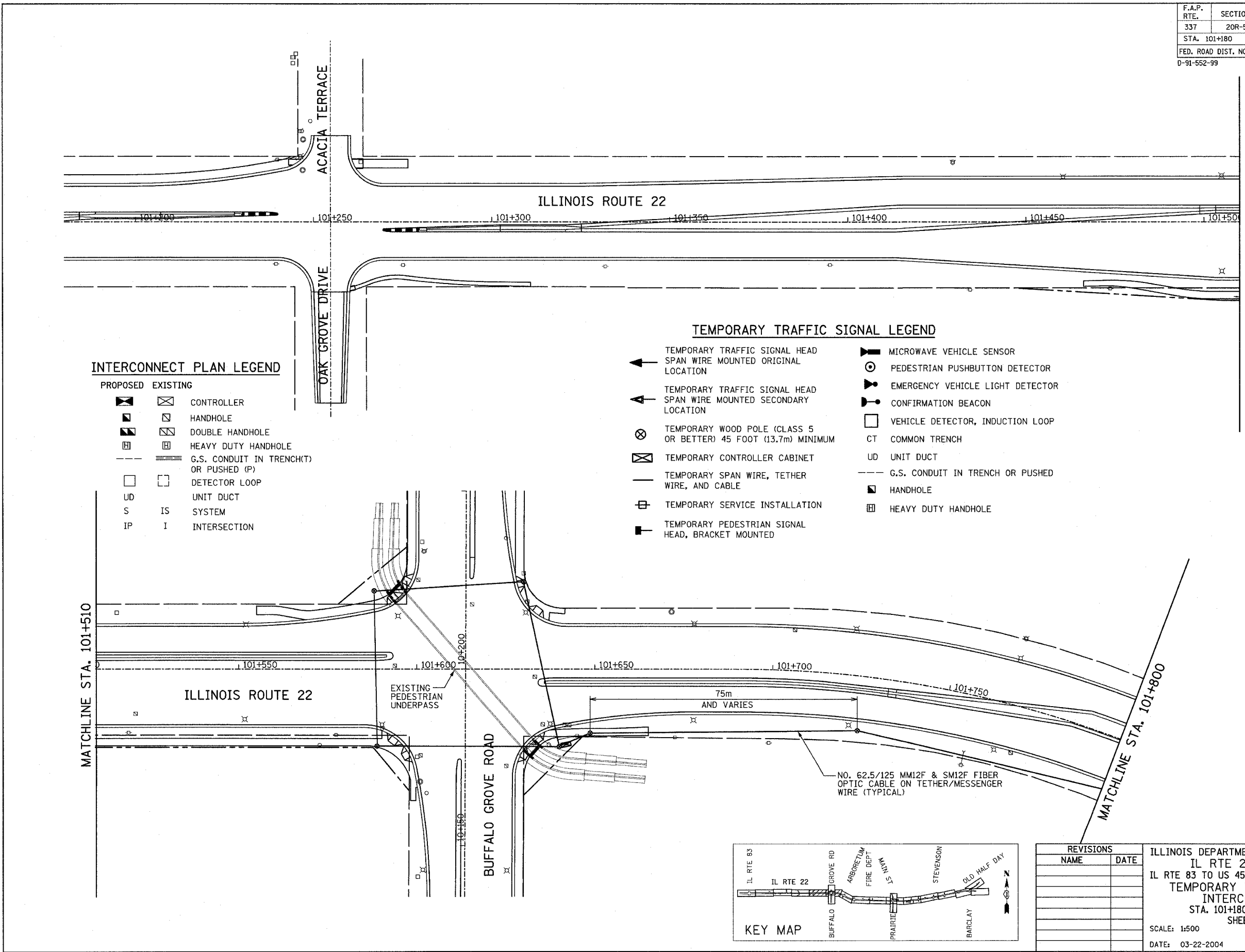

**INTERCONNECT PLAN LEGEND**

PROPOSED	EXISTING	DESCRIPTION
☒	☒	CONTROLLER
◻	◻	HANDHOLE
◻	◻	DOUBLE HANDHOLE
◻	◻	HEAVY DUTY HANDHOLE
---	---	G.S. CONDUIT IN TRENCH(T) OR PUSHED (P)
□	□	DETECTOR LOOP
UD		UNIT DUCT
S		IS SYSTEM
IP		I INTERSECTION

**TEMPORARY TRAFFIC SIGNAL LEGEND**

←	TEMPORARY TRAFFIC SIGNAL HEAD SPAN WIRE MOUNTED ORIGINAL LOCATION	⊞	MICROWAVE VEHICLE SENSOR
←	TEMPORARY TRAFFIC SIGNAL HEAD SPAN WIRE MOUNTED SECONDARY LOCATION	⊙	PEDESTRIAN PUSHBUTTON DETECTOR
⊗	TEMPORARY WOOD POLE (CLASS 5 OR BETTER) 45 FOOT (13.7m) MINIMUM	⊞	EMERGENCY VEHICLE LIGHT DETECTOR
☒	TEMPORARY CONTROLLER CABINET	⊞	CONFIRMATION BEACON
---	TEMPORARY SPAN WIRE, TETHER WIRE, AND CABLE	□	VEHICLE DETECTOR, INDUCTION LOOP
⊞	TEMPORARY SERVICE INSTALLATION	CT	COMMON TRENCH
⊞	TEMPORARY PEDESTRIAN SIGNAL HEAD, BRACKET MOUNTED	UD	UNIT DUCT
		---	G.S. CONDUIT IN TRENCH OR PUSHED
		◻	HANDHOLE
		◻	HEAVY DUTY HANDHOLE

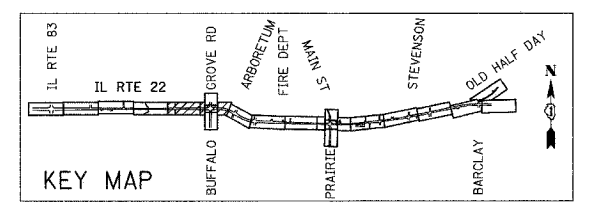

**REVISIONS**

NAME	DATE

ILLINOIS DEPARTMENT OF TRANSPORTATION  
 IL RTE 22 (FAP 337)  
 IL RTE 83 TO US 45 / IL 21 (MILWAUKEE AVE)  
 TEMPORARY TRAFFIC SIGNAL INTERCONNECTION  
 STA. 101+180 TO STA. 101+800  
 SHEET 1 OF 5  
 SCALE: 1:500  
 DATE: 03-22-2004  
 DRAWN BY: AMB  
 DESIGNED BY: AMB  
 CHECKED BY: JPS