

F.A.P. RTE.	SECTION	COUNTY	TOTAL SHEETS	SHEET NO.
337	20R-5	LAKE	562	365
STA.		TO STA.		
FED. ROAD DIST. NO.		ILLINOIS	FED. AID PROJECT	
D-91-552-99		60881		

THE FOLLOWING EXISTING TRAFFIC SIGNAL EQUIPMENT SHALL BE REMOVED BY THE CONTRACTOR, SHALL REMAIN THE PROPERTY OF THE STATE AND SHALL BE DELIVERED BY THE CONTRACTOR TO THE STATE'S TRAFFIC SIGNAL MAINTENANCE CONTRACTOR'S MAIN FACILITY AS PER THE TRAFFIC SIGNAL SPECIFICATIONS.

- 1 EACH CONTROLLER AND CABINET (COMPLETE)
- THE FOLLOWING EXISTING TRAFFIC SIGNAL EQUIPMENT SHALL BE REMOVED BY THE CONTRACTOR AND SHALL REMAIN THE PROPERTY OF THE AGENCY LISTED BELOW. THE CONTRACTOR SHALL SAFELY STORE AND ARRANGE FOR PICKUP OF ALL EQUIPMENT TO BE RETURNED TO THE LISTED AGENCY AS PER THE TRAFFIC SIGNAL SPECIFICATIONS.

AGENCY: VILLAGE OF LINCOLNSHIRE

- 2 EACH LIGHT DETECTOR
- 1 EACH LIGHT DETECTOR AMPLIFIER

THE FOLLOWING ITEMS SHALL BE REMOVED BY THE CONTRACTOR AND SHALL BE DISPOSED OF BY THEM OUTSIDE THE RIGHT-OF-WAY AT THEIR EXPENSE. THE SALVAGE VALUE OF THE REMOVED EQUIPMENT SHALL BE REFLECTED IN THE CONTRACT BID PRICE.

- 4 EACH SIGNAL HEAD, 1-FACE, 3-SECTION
- 7 EACH SIGNAL HEAD, 1-FACE, 5-SECTION
- 8 EACH TRAFFIC SIGNAL BACKPLATE
- 4 EACH STEEL MAST ARM AND POLE
- 3 EACH SIGNAL POST
- 2 EACH PEDESTRIAN SIGNAL HEAD, 1-FACE
- 1 EACH PEDESTRIAN SIGNAL HEAD, 2-FACE
- 3 EACH PEDESTRIAN PUSHBUTTON
- 1 EACH SERVICE INSTALLATION

BY	DATE
FINAL SURVEY PLOTTED	
NOTE BOOK TEMPLATE	
AREAS CHECKED	
NO.	

BY	DATE
ORIGINAL SURVEY PLOTTED	
NOTE BOOK TEMPLATE	
AREAS CHECKED	
NO.	

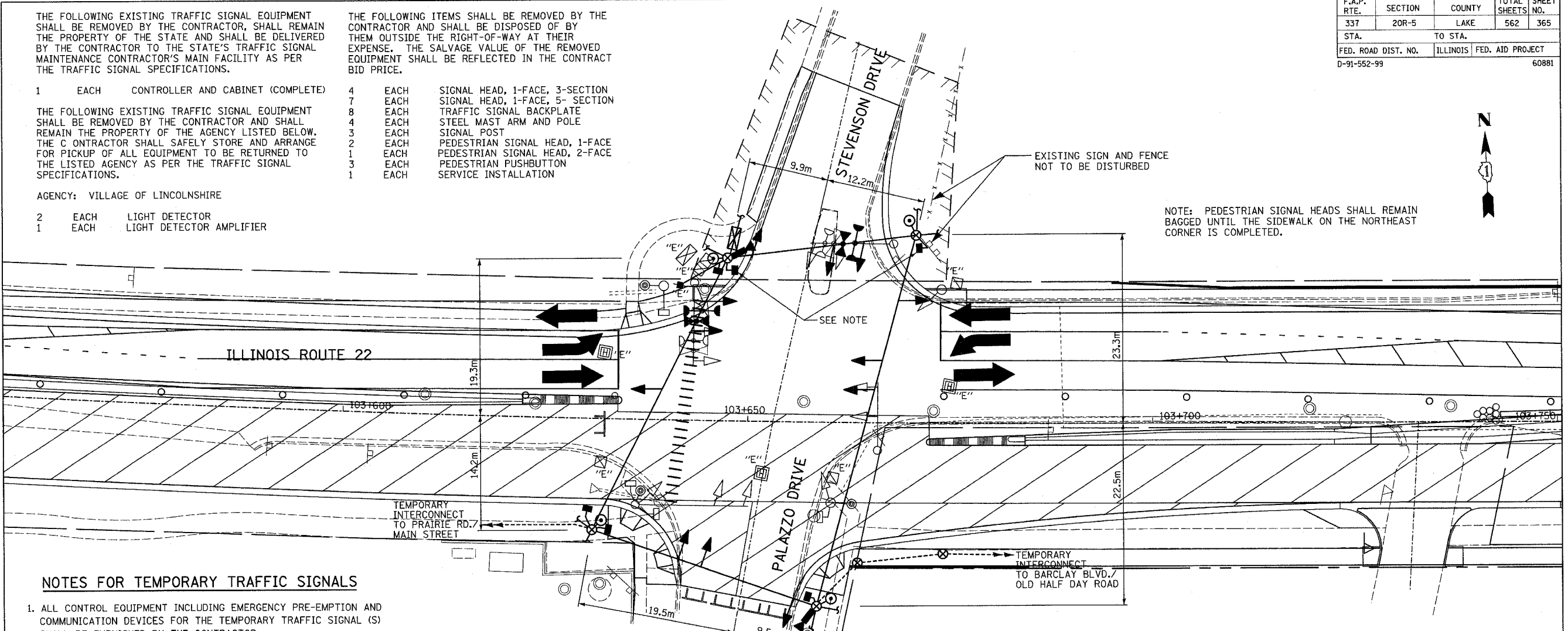

NOTE: PEDESTRIAN SIGNAL HEADS SHALL REMAIN BAGGED UNTIL THE SIDEWALK ON THE NORTHEAST CORNER IS COMPLETED.

**NOTES FOR TEMPORARY TRAFFIC SIGNALS**

- ALL CONTROL EQUIPMENT INCLUDING EMERGENCY PRE-EMPTION AND COMMUNICATION DEVICES FOR THE TEMPORARY TRAFFIC SIGNAL (S) SHALL BE FURNISHED BY THE CONTRACTOR.
- ONLY CONTROLLERS SUPPLIED BY ONE OF THE DISTRICT APPROVED CLOSED LOOP EQUIPMENT MANUFACTURERS WILL BE APPROVED FOR USE AT TEMPORARY SIGNAL LOCATIONS. ALL CONTROLLERS USED FOR TEMPORARY TRAFFIC SIGNALS SHALL BE FULLY ACTUATED NEMA MICROPROCESSOR BASED WITH RS232 DATA ENTRY PORTS COMPATIBLE WITH EXISTING MONITORING SOFTWARE APPROVED BY IDOT DISTRICT 1, INSTALLED IN A NEMA TS1 OR TS2 CABINET. ONLY ONE BRAND OF CONTROLLER WILL BE ACCEPTED FOR ANY ONE CONTRACT.
- ALL TRAFFIC SIGNAL SECTIONS AND PEDESTRIAN SIGNAL SECTIONS SHALL BE 12" (300mm). HEADS SHALL BE PLACED AS INDICATED ON THE TEMPORARY TRAFFIC SIGNAL PLAN OR AS DIRECTED BY THE ENGINEER. THE CONTRACTOR SHALL FURNISH ENOUGH CABLE SLACK TO RELOCATE HEADS TO ANY POSITION ON THE SPAN WIRE OR AT LOCATIONS ILLUSTRATED ON THE PLANS FOR CONSTRUCTION STAGING. THE TEMPORARY TRAFFIC SIGNAL SHALL REMAIN IN OPERATION DURING ALL SIGNAL HEAD RELOCATIONS. EACH TEMPORARY TRAFFIC SIGNAL HEAD SHALL HAVE ITS OWN CABLE FROM THE CONTROLLER CABINET TO THE SIGNAL HEAD.
- ALL EXISTING STREET NAME AND INTERSECTION REGULATORY SIGNS SHALL BE REMOVED FROM EXISTING POLES, RELOCATED AND SECURELY FASTENED TO THE SIGNAL SPAN WIRE OR WOOD POLE AS DIRECTED BY THE ENGINEER.
- ANY TEMPORARY SIGNAL WITHIN AN EXISTING CLOSED LOOP TRAFFIC SIGNAL SYSTEM SHALL BE INTERCONNECTED TO THAT SYSTEM USING SIMILAR BRAND CONTROL EQUIPMENT.
- THE TEMPORARY TRAFFIC SIGNAL SHALL HAVE THE SIGNAL HEAD DISPLAYS, SIGNAL HEAD PLACEMENTS AND CONTROLLER PHASING MATCH THE EXISTING TRAFFIC SIGNAL, AT THE TIME OF THE TURN ON, IF NO TRAFFIC STAGING IS IN PLACE OR WILL NOT BE STAGED ON THE DAY OF THE TURN ON.

**EXISTING EQUIPMENT TO BE REMOVED**

**LEGEND**

	EXISTING SIGNAL HEAD TO BE REMOVED
	EXISTING SERVICE INSTALLATION TO BE REMOVED
	EXISTING CONTROLLER AND FOUNDATION TO BE REMOVED
	EXISTING HANDHOLE TO BE REMOVED
	EXISTING HEAVY DUTY HANDHOLE TO BE REMOVED
	EXISTING EMERGENCY VEHICLE SYSTEM DETECTOR TO BE REMOVED
	EXISTING EMERGENCY VEHICLE SYSTEM BEACON TO BE REMOVED
	EXISTING SIGNAL POST AND FOUNDATION TO BE REMOVED
	EXISTING PEDESTRIAN SIGNAL HEAD TO BE REMOVED
	EXISTING PEDESTRIAN PUSHBUTTON TO BE REMOVED
	EXISTING STEEL MAST ARM POLE AND FOUNDATION TO BE REMOVED
	EXISTING ALUMINUM MAST ARM POLE AND FOUNDATION TO BE REMOVED

**TEMPORARY TRAFFIC SIGNAL LEGEND**

	TEMPORARY TRAFFIC SIGNAL HEAD SPAN WIRE MOUNTED ORIGINAL LOCATION		MICROWAVE VEHICLE SENSOR
	TEMPORARY TRAFFIC SIGNAL HEAD SPAN WIRE MOUNTED SECONDARY LOCATION		PEDESTRIAN PUSHBUTTON DETECTOR
	TEMPORARY WOOD POLE (CLASS 5 OR BETTER) 45 FOOT (13.7m) MINIMUM		EMERGENCY VEHICLE LIGHT DETECTOR
	TEMPORARY CONTROLLER CABINET		CONFIRMATION BEACON
	TEMPORARY SPAN WIRE, TETHER WIRE, AND CABLE		VEHICLE DETECTOR, INDUCTION LOOP
	TEMPORARY SERVICE INSTALLATION		CT COMMON TRENCH
	TEMPORARY PEDESTRIAN SIGNAL HEAD, BRACKET MOUNTED		UD UNIT DUCT
			G.S. CONDUIT IN TRENCH OR PUSHED
			HANDHOLE
			HEAVY DUTY HANDHOLE

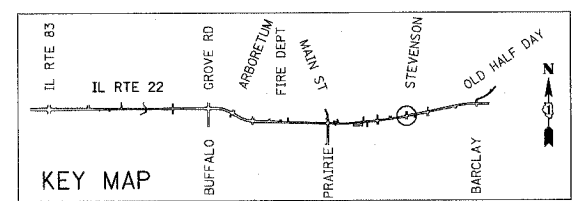

**REVISIONS**

NAME	DATE

ILLINOIS DEPARTMENT OF TRANSPORTATION  
 IL RTE 22 (FAP 337)  
 IL RTE 83 TO US 45 / IL 21 (MILWAUKEE AVE)  
 TEMPORARY TRAFFIC SIGNAL  
 INSTALLATION AND REMOVE EXISTING  
 TRAFFIC SIGNAL EQUIPMENT (STAGE 1)  
 ILLINOIS ROUTE 22 AT STEVENSON DRIVE  
 SCALE: 1:250  
 DATE: 03-22-2004  
 DRAWN BY: AMB  
 DESIGNED BY: AMB  
 CHECKED BY: JPS