

F.A.P. RTE.	SECTION	COUNTY	TOTAL SHEETS	SHEET NO.
337		LAKE	562	166
STA. 100+835		TO STA. 101+180		
FED. ROAD DIST. NO.		ILLINOIS	FED. AID PROJECT	
D-91-552-99		6881		

FINAL SURVEY PLOTTED	BY	DATE
NOTE BOOK TEMPLATE		
AREAS CHECKED		

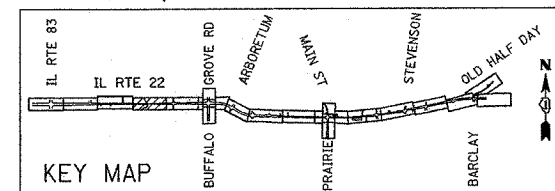
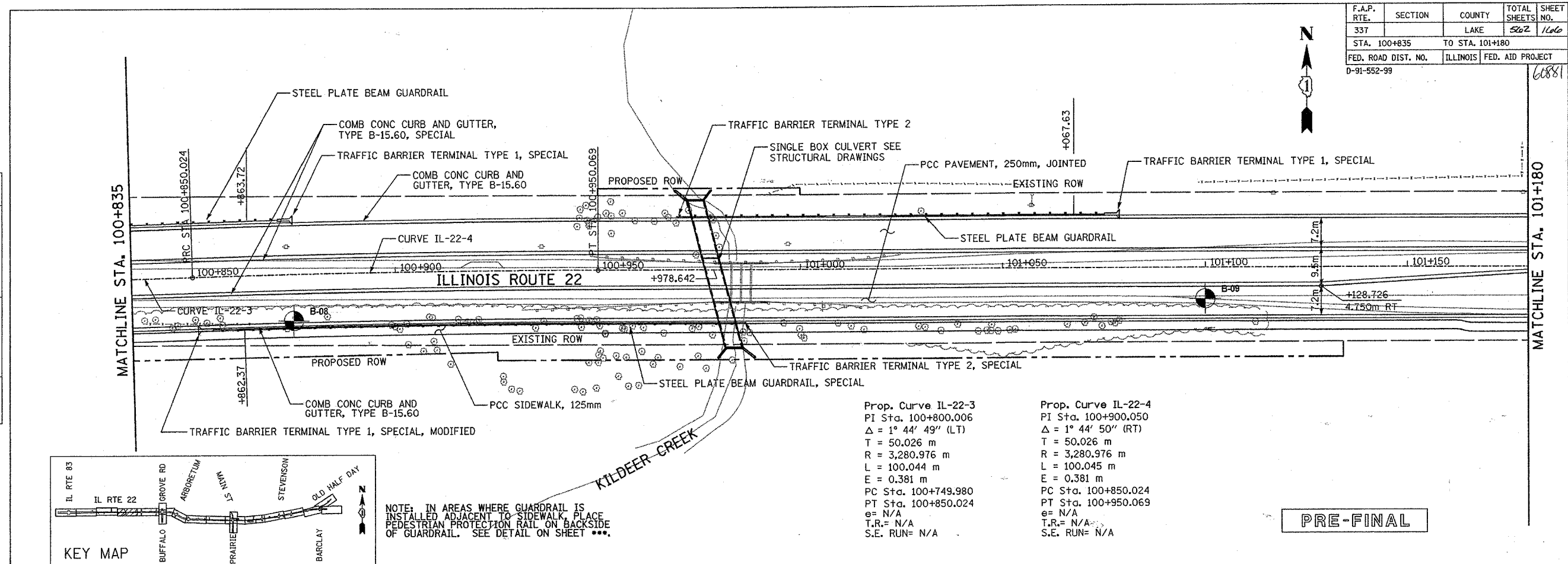

NOTE: IN AREAS WHERE GUARDRAIL IS INSTALLED ADJACENT TO SIDEWALK, PLACE PEDESTRIAN PROTECTION RAIL ON BACKSIDE OF GUARDRAIL. SEE DETAIL ON SHEET ***.

ORIGINAL SURVEY PLOTTED	BY	DATE
NOTE BOOK TEMPLATE		
AREAS CHECKED		

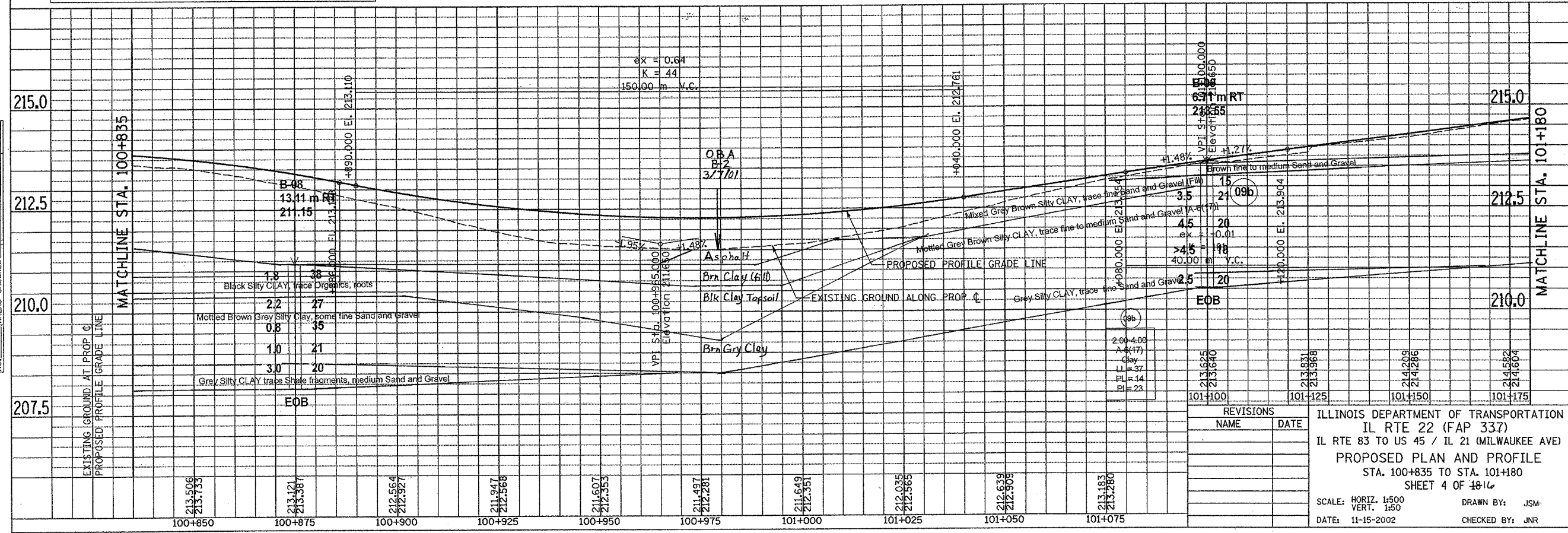

REVISIONS	
NAME	DATE

ILLINOIS DEPARTMENT OF TRANSPORTATION
 IL RTE 22 (FAP 337)
 IL RTE 83 TO US 45 / IL 21 (MILWAUKEE AVE)
 PROPOSED PLAN AND PROFILE
 STA. 100+835 TO STA. 101+180
 SHEET 4 OF 16

SCALE: HORIZ. 1:500
 VERT. 1:50
 DATE: 11-15-2002
 DRAWN BY: JSM
 CHECKED BY: JNR