

F.A.P. RTE.	SECTION	COUNTY	TOTAL SHEETS	SHEET NO.
337		LAKE	522	165
STA. 100+475 TO STA. 100+835				
FED. ROAD DIST. NO.	ILLINOIS	FED. AID PROJECT		
D-91-552-99			6088	

BY	DATE
FINAL SURVEY PLOTTED	
NOTE BOOK TEMPLATE	
AREAS CHECKED	
NO.	

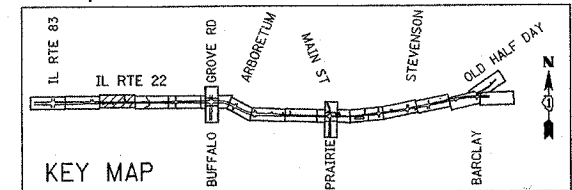
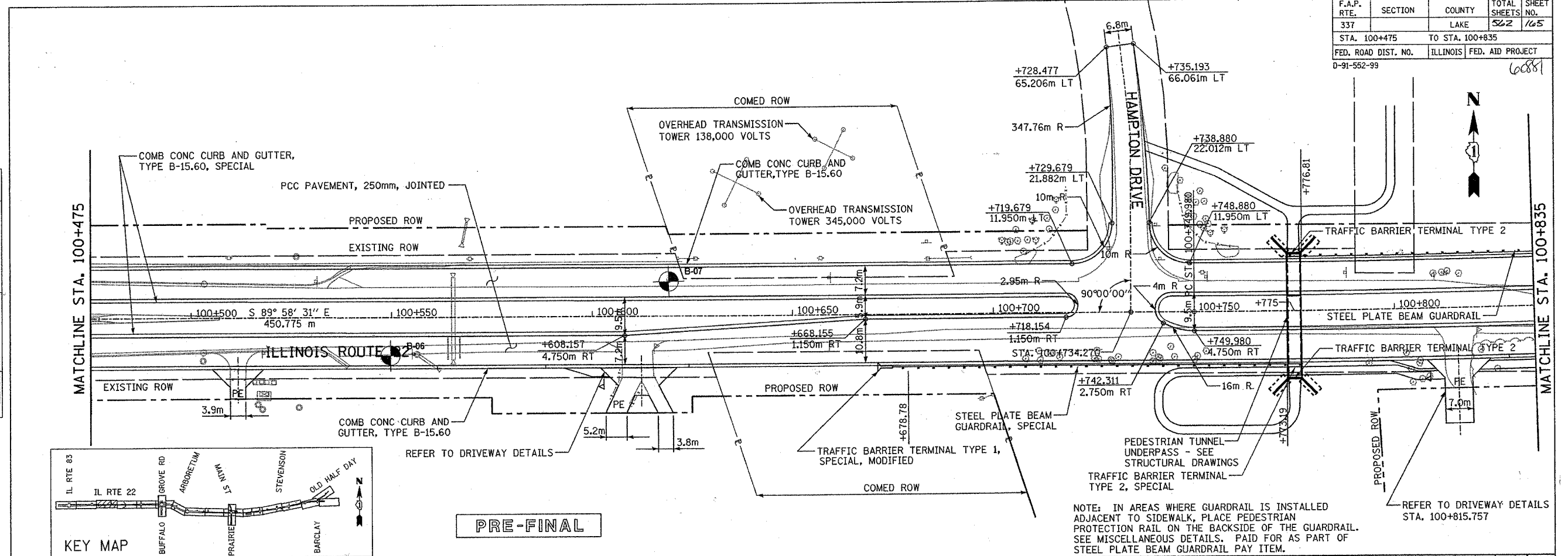

NOTE: IN AREAS WHERE GUARDRAIL IS INSTALLED ADJACENT TO SIDEWALK, PLACE PEDESTRIAN PROTECTION RAIL ON THE BACKSIDE OF THE GUARDRAIL. SEE MISCELLANEOUS DETAILS. PAID FOR AS PART OF STEEL PLATE BEAM GUARDRAIL PAY ITEM.

REFER TO DRIVEWAY DETAILS STA. 100+815.757

BY	DATE
ORIGINAL SURVEY PLOTTED	
NOTE BOOK TEMPLATE	
AREAS CHECKED	
NO.	

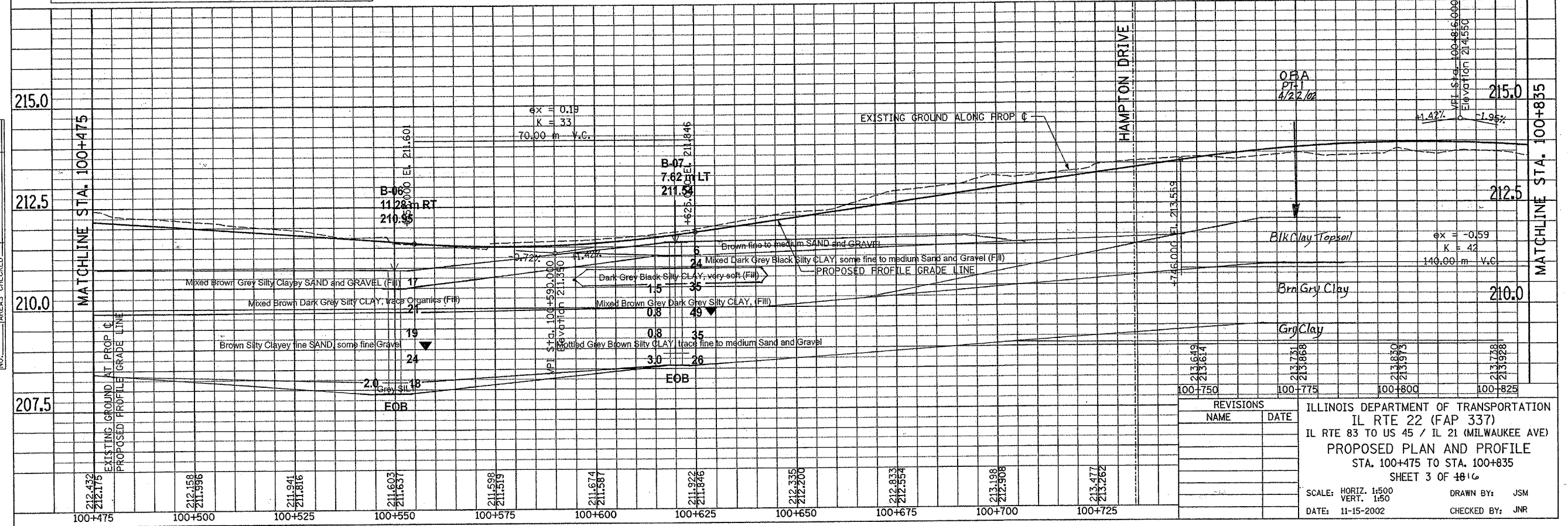

ILLINOIS DEPARTMENT OF TRANSPORTATION
 IL RTE 22 (FAP 337)
 IL RTE 83 TO US 45 / IL 21 (MILWAUKEE AVE)
 PROPOSED PLAN AND PROFILE
 STA. 100+475 TO STA. 100+835
 SHEET 3 OF 4816

SCALE: HORIZ. 1:500
 VERT. 1:50
 DATE: 11-15-2002
 DRAWN BY: JSM
 CHECKED BY: JNR