

F.A.P. RTE.	SECTION	COUNTY	TOTAL SHEETS	SHEET NO.
337		LAKE	522	153
STA. 102+395		TO STA. 103+060		
FED. ROAD DIST. NO.		ILLINOIS	FED. AID PROJECT	
D-91-552-99				

60881

BY	DATE
FINAL SURVEYED	
SURVEY PLOTTED	
NOTE BOOK	
TEMPLATE	
AREAS CHECKED	
NO.	

BY	DATE
ORIGINAL SURVEYED	
SURVEY PLOTTED	
NOTE BOOK	
TEMPLATE	
AREAS CHECKED	
NO.	

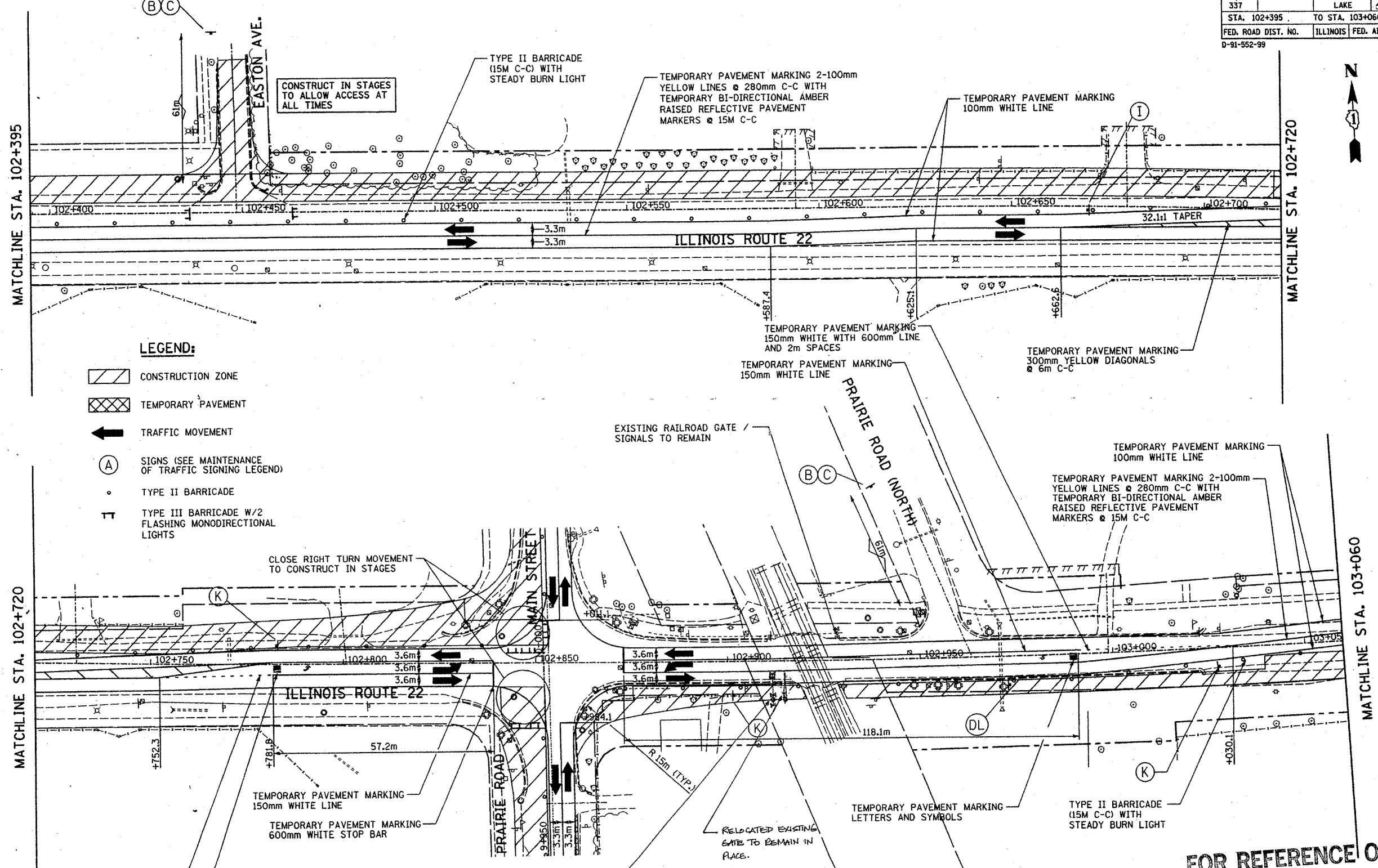

- LEGEND:**
- CONSTRUCTION ZONE
 - TEMPORARY PAVEMENT
 - TRAFFIC MOVEMENT
 - SIGNS (SEE MAINTENANCE OF TRAFFIC SIGNING LEGEND)
 - TYPE II BARRICADE
 - TYPE III BARRICADE W/2 FLASHING MONODIRECTIONAL LIGHTS

FOR REFERENCE ONLY

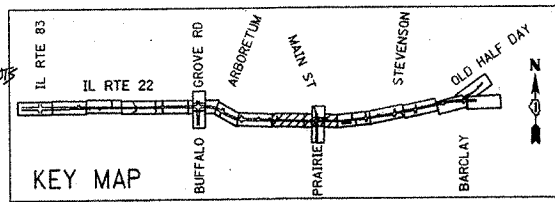

REVISIONS	
NAME	DATE

ILLINOIS DEPARTMENT OF TRANSPORTATION
 IL RTE 22 (FAP 337)
 IL RTE 83 TO US 45 / IL 21 (MILWAUKEE AVE)
 MAINTENANCE OF TRAFFIC
 STAGE 1
 STA. 102+395 TO STA. 103+060
 SHEET 5 OF 9
 SCALE: 1:500
 DATE: 06-12-2003
 DRAWN BY: JPM
 CHECKED BY: JNR