

F. & E. NO.	SECTION	COUNTY	TOTAL SHEETS	SHEET NO.
	1316RS-1	COOK	22	20
STA.	TO STA.			
FED. ROAD DIST. NO.	ILLINOIS	FED. AID PROJECT		

60754

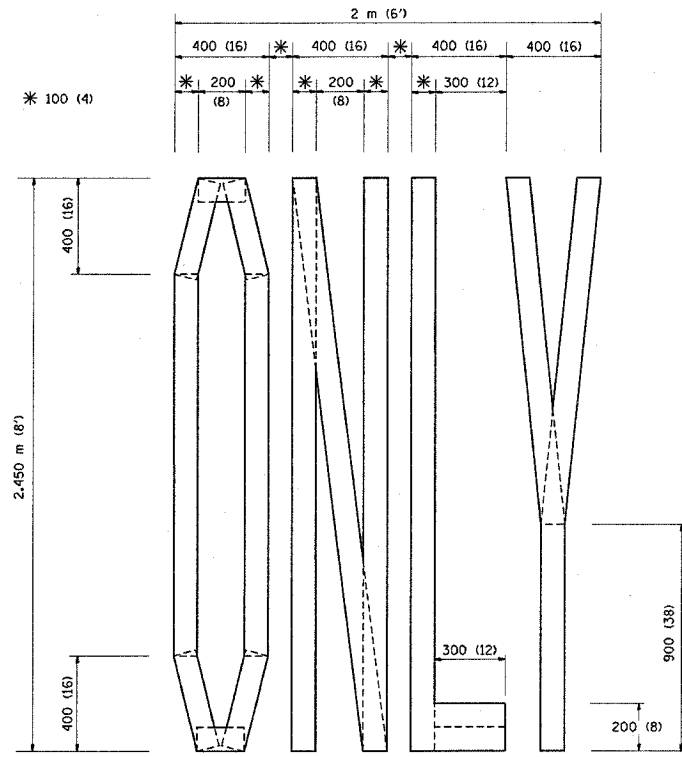

QUANTITY
100 (4) LINE = 19.7 m (64.1 ft.)
1.97 sq. m (21.1 sq. ft.)

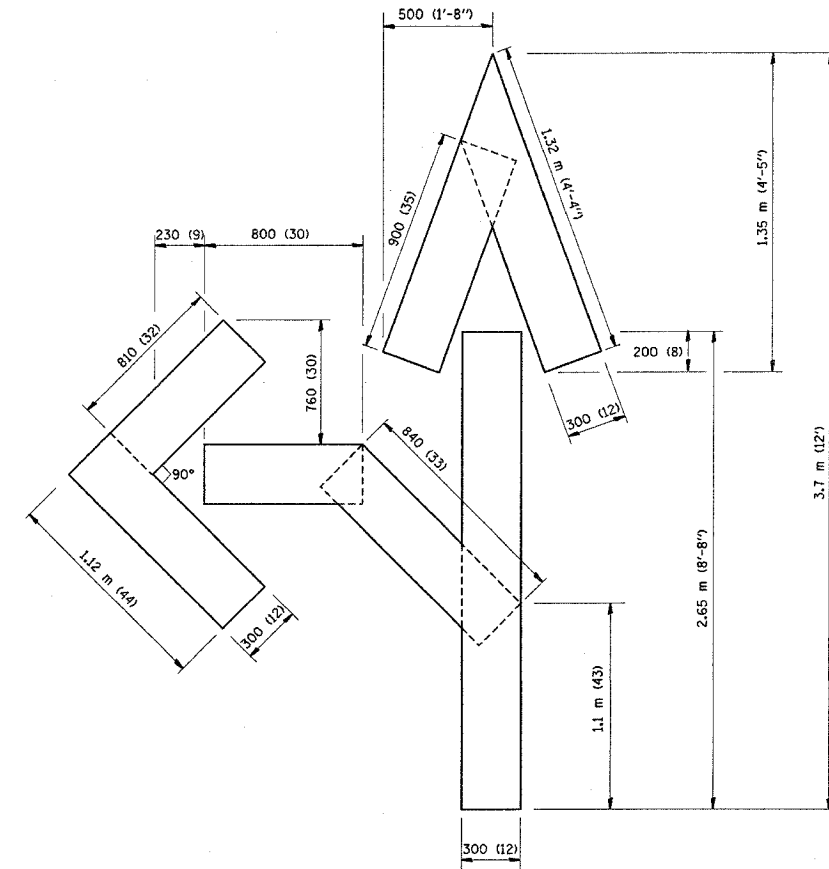

QUANTITY
100 (4) LINE = 25.3 m (82.5 ft.)
2.53 sq. m (27.5 sq. ft.)

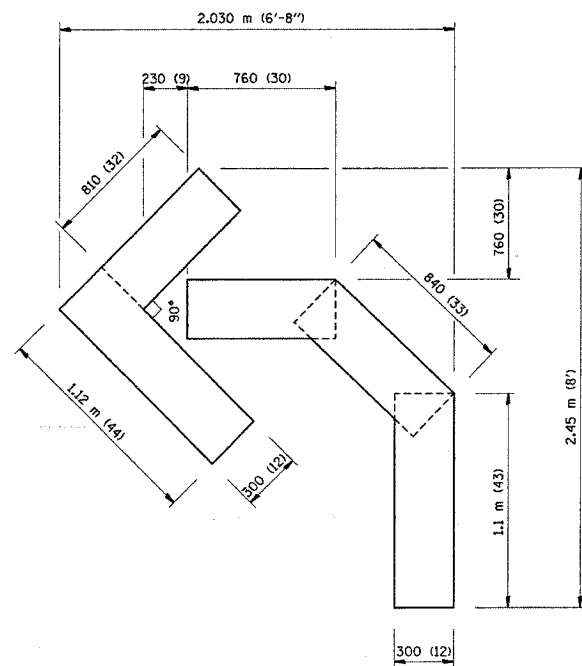

QUANTITY
100 (4) LINE = 13.9 m (45.5 ft.)
1.39 sq. m (15.2 sq. ft.)

All dimensions are in millimeters (inches) unless otherwise shown.

ILLINOIS DEPARTMENT OF TRANSPORTATION

PAVEMENT MARKING
LETTERS AND SYMBOLS
FOR TRAFFIC STAGING

REVISIONS	
NAME	DATE
T. RAMMACHER	09/18/94
J. OBERLE	06/01/96
T. RAMMACHER	06/05/96
T. RAMMACHER	11/04/97
T. RAMMACHER	03/02/98
E. GOMEZ	08/28/00

SCALE: NONE
DATE 3/18/2005

DRAWN BY CADD
CHECKED BY

TC-16

REVISION DATE: 08/28/00