

no.	date	by	ckd	description
0	04/25/08	BJQ	MAR	ISSUED FOR BID

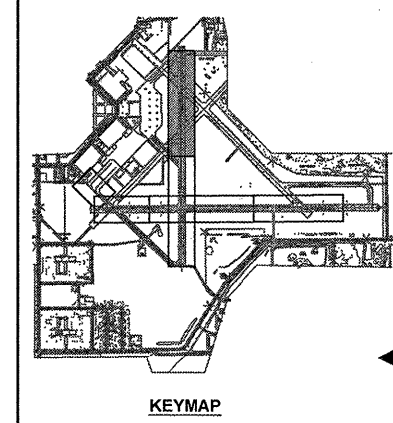

date	02/13/08	detailed	L. TUCKER
designed	B. QUINLAN	checked	A. RAHMAN

RUNWAY 9/27 LIGHTING, NAVAIDS AND SIGNAGE; RUNWAY 18/36 WIND CONES AND SIGNAGE

ELECTRICAL SITE PLAN
RUNWAY 18-36 STA. 125+00 TO STA. 149+00

project	contract
drawing	rev.
E106	0
sheet 14 of 21 sheets	
file 47463E106.DWG	

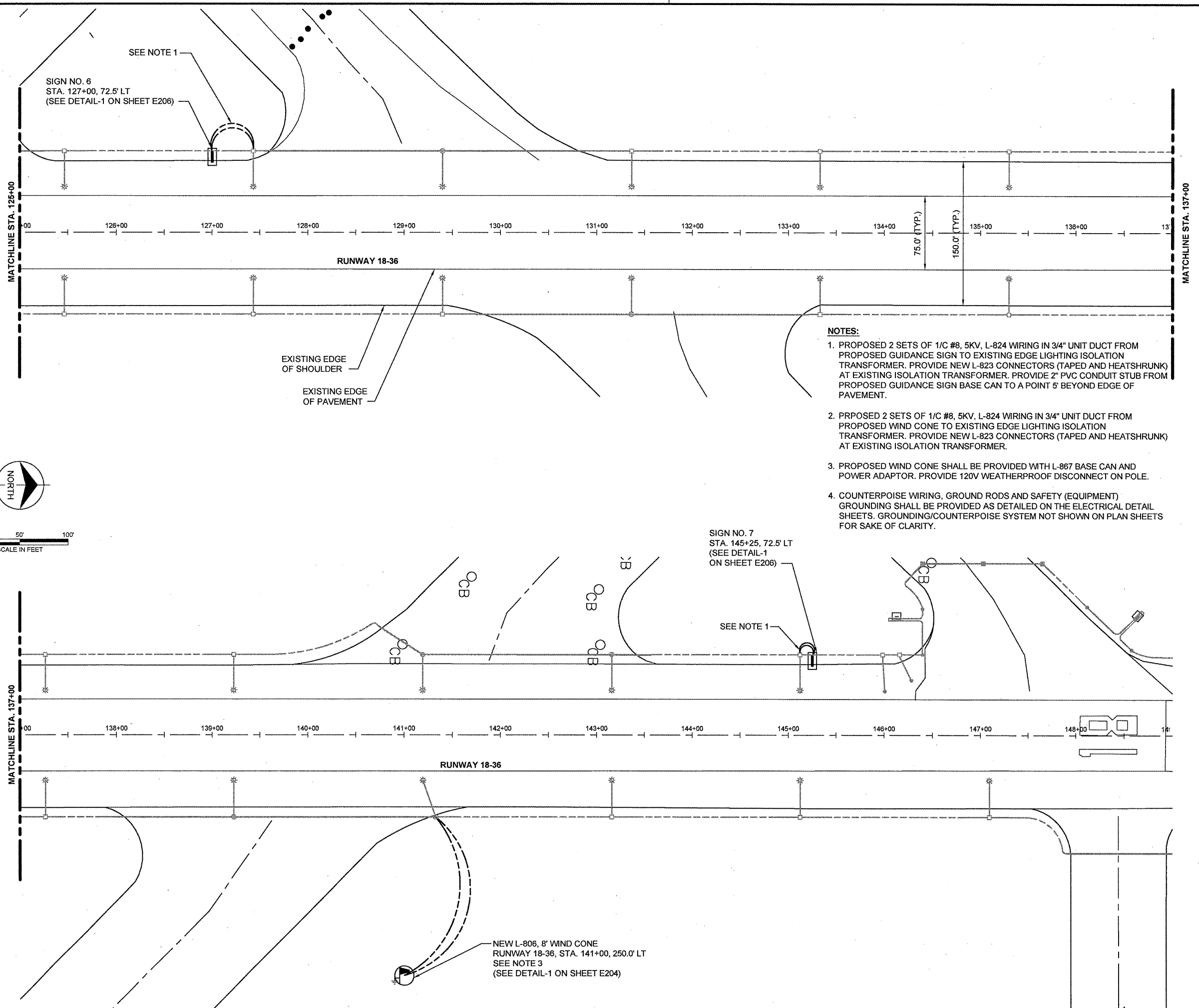

- NOTES:**
1. PROPOSED 2 SETS OF 1/C #8, 5KV, L-824 WIRING IN 3/4" UNIT DUCT FROM PROPOSED GUIDANCE SIGN TO EXISTING EDGE LIGHTING ISOLATION TRANSFORMER. PROVIDE NEW L-823 CONNECTORS (TAPED AND HEATSHRUNK) AT EXISTING ISOLATION TRANSFORMER. PROVIDE 2" PVC CONDUIT STUB FROM PROPOSED GUIDANCE SIGN BASE CAN TO A POINT 5' BEYOND EDGE OF PAVEMENT.
 2. PROPOSED 2 SETS OF 1/C #8, 5KV, L-824 WIRING IN 3/4" UNIT DUCT FROM PROPOSED WIND CONE TO EXISTING EDGE LIGHTING ISOLATION TRANSFORMER. PROVIDE NEW L-823 CONNECTORS (TAPED AND HEATSHRUNK) AT EXISTING ISOLATION TRANSFORMER.
 3. PROPOSED WIND CONE SHALL BE PROVIDED WITH L-867 BASE CAN AND POWER ADAPTOR. PROVIDE 120V WEATHERPROOF DISCONNECT ON POLE.
 4. COUNTERPOISE WIRING, GROUND RODS AND SAFETY (EQUIPMENT) GROUNDING SHALL BE PROVIDED AS DETAILED ON THE ELECTRICAL DETAIL SHEETS. GROUNDING/COUNTERPOISE SYSTEM NOT SHOWN ON PLAN SHEETS FOR SAKE OF CLARITY.

Scale For Microfilming
Millimeters
Inches

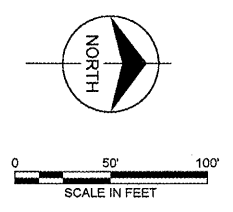

COPYRIGHT © 2008 BURNS & MCDONNELL ENGINEERING COMPANY, INC.