

no.	date	by	ckd	description
0	04/25/08	BJQ	MAR	ISSUED FOR BID

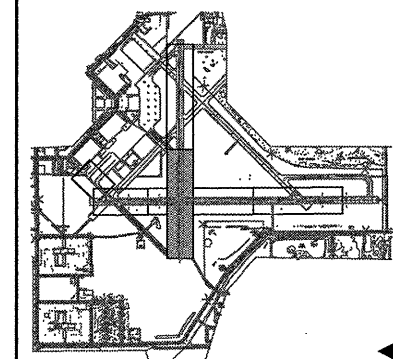

date	02/13/08	detailed	L. TUCKER
designed	B. QUINLAN	checked	A. RAHMAN

RUNWAY 9/27 LIGHTING, NAVAIDS AND SIGNAGE; RUNWAY 18/36 WIND CONES AND SIGNAGE

**ELECTRICAL SITE PLAN
RUNWAY 18-36 STA. 100+00 TO STA. 125+00**

project	contract
---------	----------

drawing **E105** - rev. **0**

sheet 13 of 21 sheets
file 47463E105.DWG

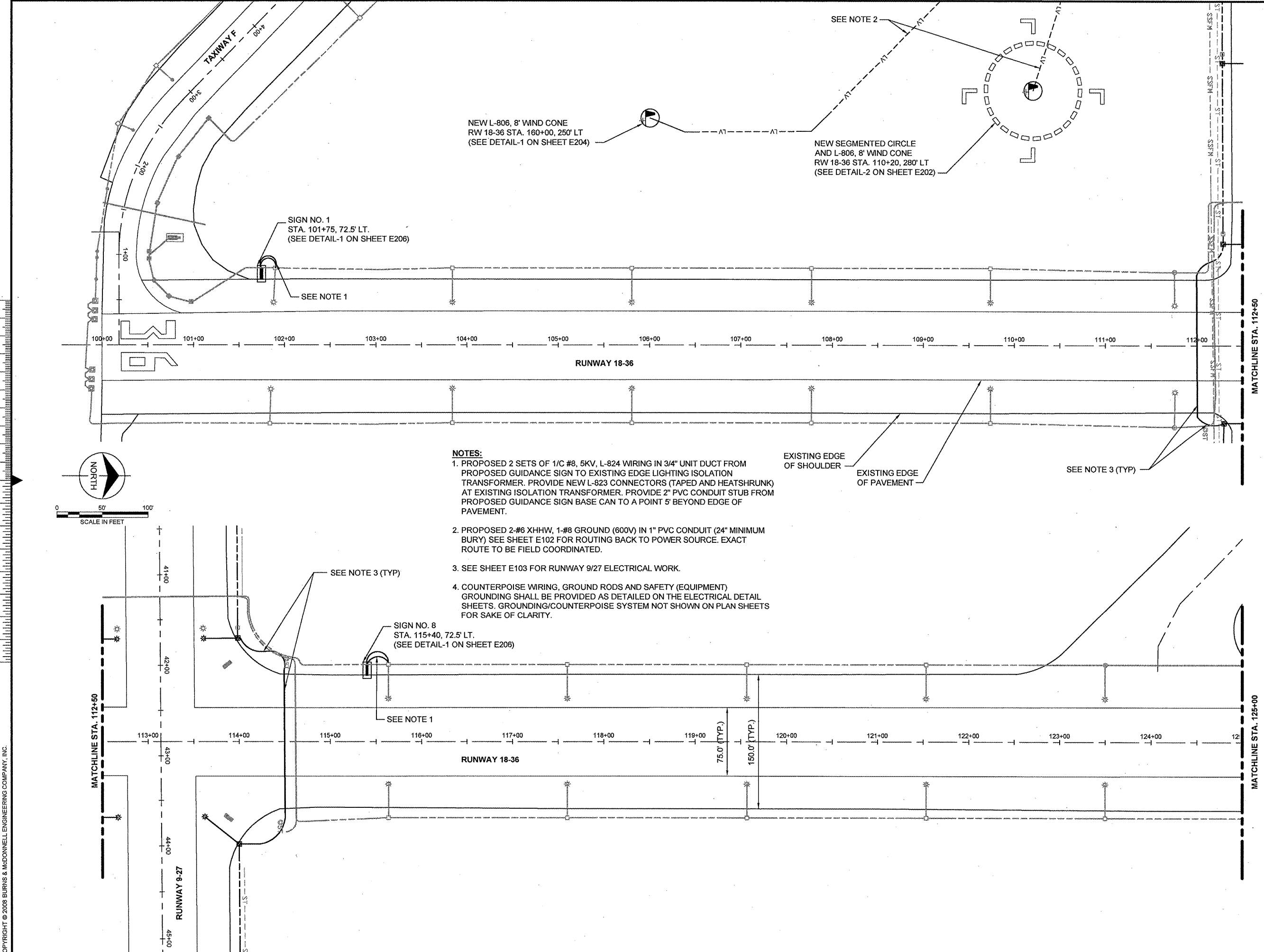

- NOTES:**
1. PROPOSED 2 SETS OF 1/C #8, 5KV, L-824 WIRING IN 3/4" UNIT DUCT FROM PROPOSED GUIDANCE SIGN TO EXISTING EDGE LIGHTING ISOLATION TRANSFORMER. PROVIDE NEW L-823 CONNECTORS (TAPED AND HEATSHRUNK) AT EXISTING ISOLATION TRANSFORMER. PROVIDE 2" PVC CONDUIT STUB FROM PROPOSED GUIDANCE SIGN BASE CAN TO A POINT 5' BEYOND EDGE OF PAVEMENT.
 2. PROPOSED 2-#6 XHHW, 1-#8 GROUND (600V) IN 1" PVC CONDUIT (24" MINIMUM BURY) SEE SHEET E102 FOR ROUTING BACK TO POWER SOURCE. EXACT ROUTE TO BE FIELD COORDINATED.
 3. SEE SHEET E103 FOR RUNWAY 9/27 ELECTRICAL WORK.
 4. COUNTERPOISE WIRING, GROUND RODS AND SAFETY (EQUIPMENT) GROUNDING SHALL BE PROVIDED AS DETAILED ON THE ELECTRICAL DETAIL SHEETS. GROUNDING/COUNTERPOISE SYSTEM NOT SHOWN ON PLAN SHEETS FOR SAKE OF CLARITY.

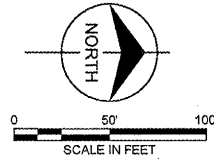

Scale For Microlining
Inches

COPYRIGHT © 2008 BURNS & MCDONNELL ENGINEERING COMPANY, INC.