

EXISTING GROUND IN THIS AREA TO BE COMPLETED BY OTHERS. PROPOSED CONTOURS MEET THESE FUTURE CONTOURS.

REMOVE, REGRADE, REPLACE RIPRAP, INCLUDED IN ITEM #5156544

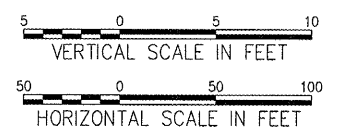

- NOTES:**
- FOR NOTES AND LEGEND, SEE SHEET 11.
 - PROPOSED GRADING TO BE COMPLETED BY OTHERS.
 - DRAINAGE STRUCTURES AND RIPRAP SHALL BE INCLUDED AS ADDITIVE ALTERNATE NO. 1

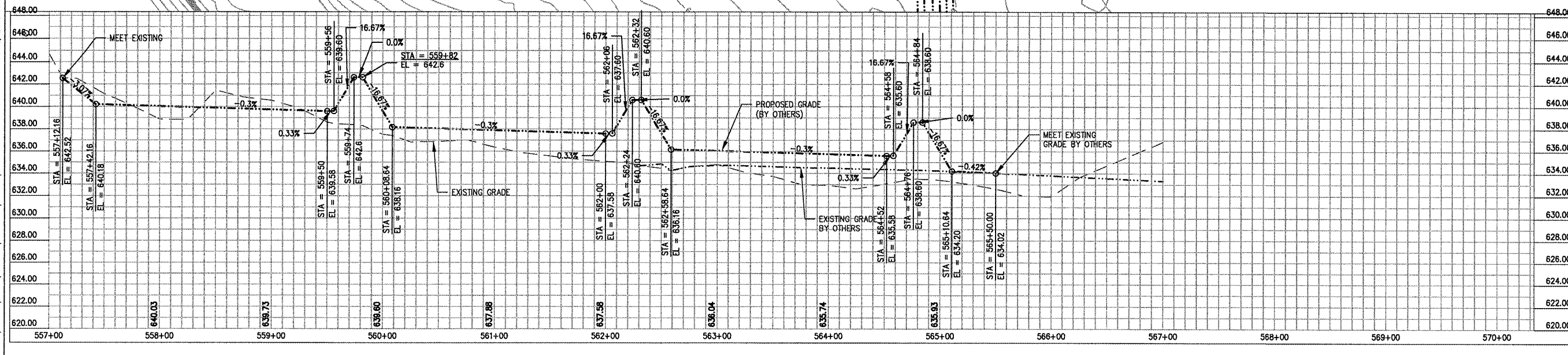

HANSON PROFESSIONAL SERVICES INC.
 815 Commerce Drive, Suite 200
 Oak Brook, Illinois 60523
 Telephone: 630.990.3800
 Fax: 630.990.3801
 Illinois Professional Design Firm
 Registration No. 184-001084
 © Copyright Hanson Professional Service Inc. 2008

Chicago-Romeoville Airport
JOLIET REGIONAL PORT DISTRICT
 1 George Michas Drive
 Romeoville, Illinois 60446
 Telephone: 815.838.9497
 Fax: 815.838.9524

EXTEND RUNWAY 2-20; CONSTRUCT TAXIWAY TURNAROUND
 AIP PROJECT NO. 3-17-0140-B42
 IDA PROJECT NO. LOT-3792

| No. | Drawing Issue Description | Date | By |
|-----|---------------------------|------|----|
| | | | |
| | | | |
| | | | |
| | | | |
| | | | |
| | | | |
| | | | |
| | | | |
| | | | |
| | | | |

Date: APRIL 18, 2008
 Sheet Title:

PLAN AND PROFILE SEDIMENTATION BASIN STA. 557+12.16 THRU STA. 565+54.00

07A0166
 Project Number
 SJM 03/14/08
 Layout By Date
 SJM 03/14/08
 Designed By Date
 RMH 03/20/08
 Reviewed By Date
 SJM
 Drawn By

4: 107.005\02840\07A0166 DRAWINGS SHEETS 18-PLAN & PROFILE 500.LINX APR 18, 2008 10:15AM HANSON0602