

BL064

REVISIONS		
NUMBER	BY	DATE

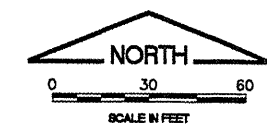
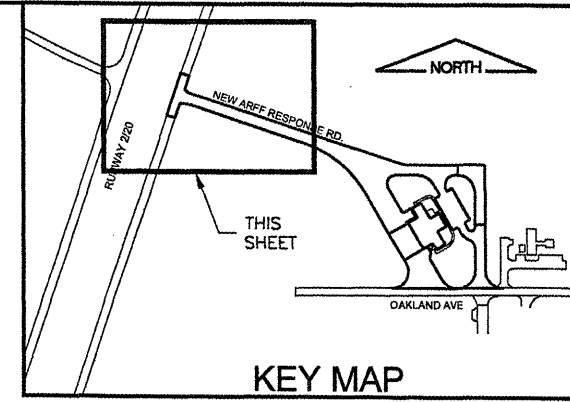
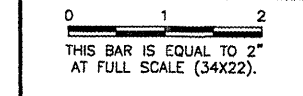

LEGEND

	EXISTING RUNWAY CENTERLINE LIGHTING CABLE
	EXISTING RUNWAY EDGE LIGHTING CABLE
	EXISTING F.A.A. CABLE
	NEW F.A.A. CABLE
	NEW RUNWAY EDGE CABLE
	EXISTING ELECTRICAL HANDHOLE
	NEW ELECTRICAL HANDHOLE
	EXISTING SPLICE CAN
	NEW SPLICE CAN
	EXISTING BUILDING
	EXISTING DUCT/CABLE MARKER
	EXISTING BASE MOUNTED RUNWAY EDGE LIGHT
	EXISTING RUNWAY GUIDANCE/DTG SIGN
	RELOCATED DTG SIGN
	NEW RUNWAY GUIDANCE SIGN AND NO.
	EXISTING RUNWAY CENTERLINE LIGHT
	NEW DUCT BANK
	NEW SPLIT DUCT
	REMOVAL
	NEW 1/C #8 5K IN UNIT DUCT FOR RUNWAY CIRCUIT
	TO BE REMOVED

- NOTES:**
- INTERCEPT EXISTING DUCT SYSTEM AT MH #18. SPLICE NEW 12 PR. CONTROL AND (2) FIBER OPTIC CABLES TO EXISTING.
 - INTERCEPT EXISTING FAA FIBER OPTIC LOOP WITH NEW MANHOLE #18.5 AT EXISTING JUNCTION BOX.
 - THE CONTRACTOR SHALL CONSTRUCT THE NEW 4 WAY DUCT BANK, INSTALL MANHOLES AND INSTALL CABLE TO THE MAXIMUM EXTENT POSSIBLE PRIOR TO REMOVING THE EXISTING CABLES FROM SERVICE. ONCE THE EXISTING CABLES HAVE BEEN TAKEN OUT OF SERVICE, THE CONTRACTOR SHALL HAVE 24 HOURS TO COMPLETE THE WORK AND BRING THE CABLE SYSTEM BACK INTO SERVICE.
 - THE CONTRACTOR SHALL PROVIDE AS MUCH NOTICE AS POSSIBLE TO THE AIRPORT AND FAA TO ALLOW THE NECESSARY COORDINATION RELATED TO THE RUNWAY 2 AND 20 ILS SYSTEMS.

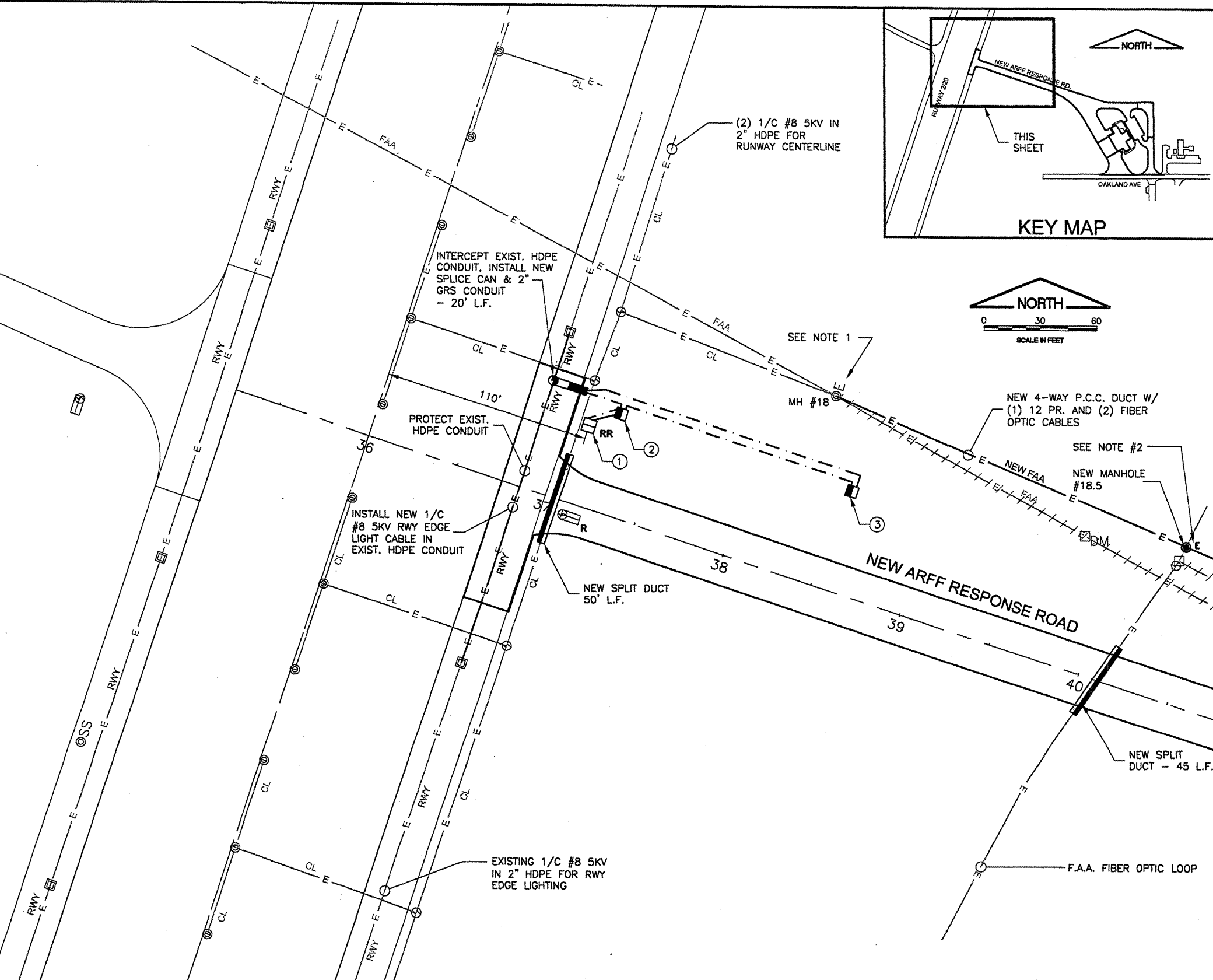

SIGN SCHEDULE

SIGN NO.	SIDE	NEW SIGN LEGEND	WHITE LEGEND WITH BLACK OUTLINE ON RED BACKGROUND	BLACK LEGEND ON YELLOW BACKGROUND	WHITE LEGEND ON BLACK BACKGROUND	NUMBER OF NEW CHARACTERS	REPLACE SIGN FACE	NOTES
①	N S	4 (BLANK)			4		1	RELOCATE DISTANCE REMAINING SIGN. REPLACE SOUTH SIGN PANEL WITH BLANK FACE.
②	NW	(BLANK)	⊖			1		NEW SIGN
③	E W	2-20 	2-20			4		NEW SIGN

**BLOOMINGTON-NORMAL AIRPORT AUTHORITY
 CENTRAL ILLINOIS REGIONAL AIRPORT
 BLOOMINGTON, ILLINOIS**

**CONSTRUCT NEW ARFF FACILITY
 ELECTRICAL PLAN 1**

© Copyright CMT, Inc.
CMT
 CRAWFORD, MURPHY & TILLY, INC.
 CONSULTING ENGINEERS
 License No. 184-000513

DESIGN BY: KLB
 DRAWN BY: DPA
 CHECKED BY: *RW*
 APPROVED BY: *RW*
 DATE: 04/01/2008
 JOB No: 0508509
 IL PROJ. NO. BMI-3797
 AIP PROJ. NO. 3-17-0006-46 & 48
 SHEET 42 OF 66 SHEETS