

K:\Bloomington\0508509_BMI_ARFF\Draw\Sheets
 FILE: DRNPLN2.dwg
 UPDATE BY: Kristy Brod
 PLOT DATE: 4/18/2008 8:33 AM
 BASE_EXISTGEO
 BASE_EXISTTOPO
 SITE_KEYMAP
 BASE_PROPDRAIN
 BASE_PROPGEO

BL064

REVISIONS		
NUMBER	BY	DATE

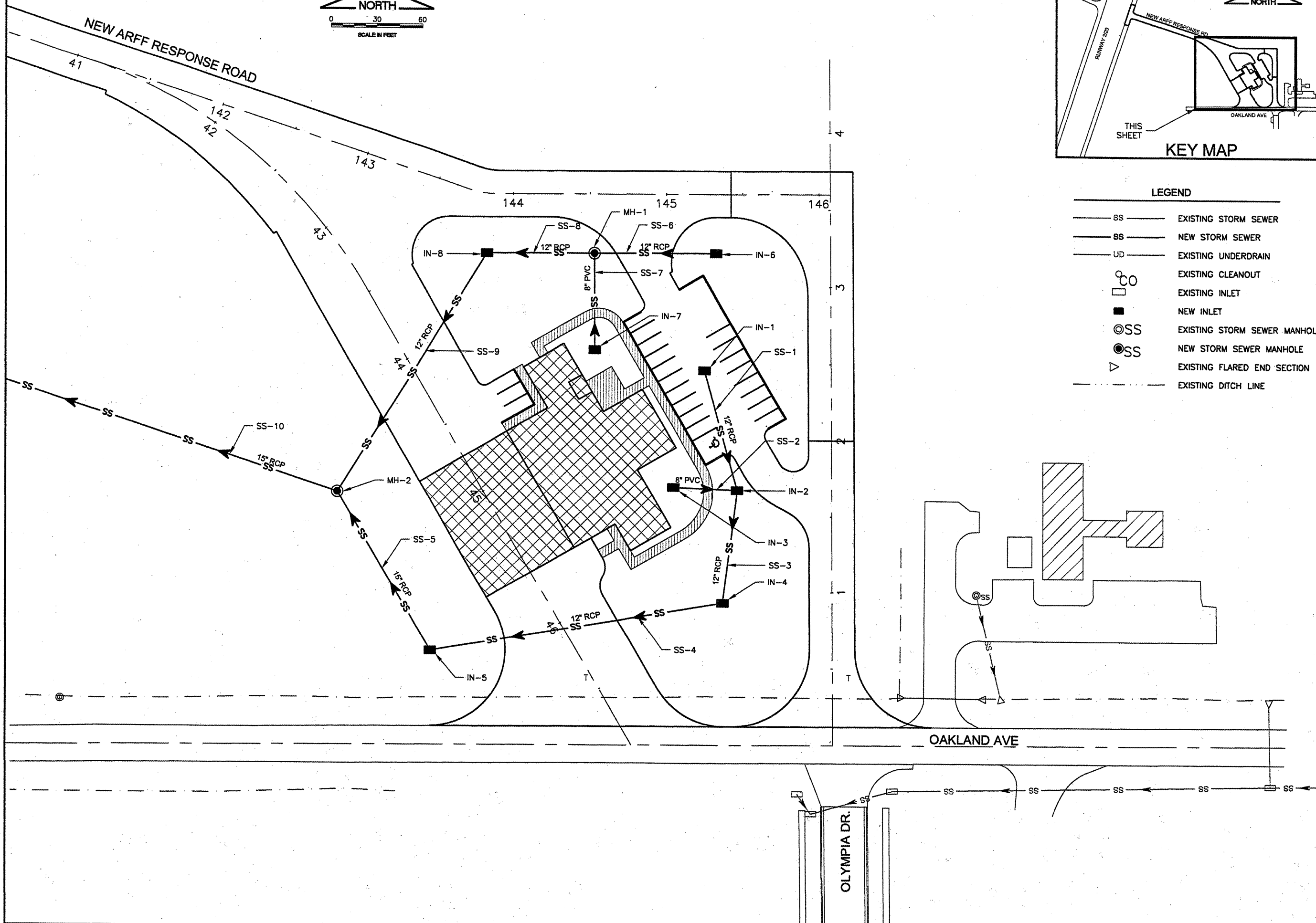
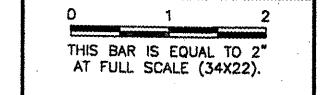

- LEGEND**
- SS — EXISTING STORM SEWER
 - SS — NEW STORM SEWER
 - UD — EXISTING UNDERDRAIN
 - CO — EXISTING CLEANOUT
 - — EXISTING INLET
 - — NEW INLET
 - ⊙ — EXISTING STORM SEWER MANHOLE
 - ⊙ — NEW STORM SEWER MANHOLE
 - ▽ — EXISTING FLARED END SECTION
 - - - EXISTING DITCH LINE

BLOOMINGTON-NORMAL AIRPORT AUTHORITY
CENTRAL ILLINOIS REGIONAL AIRPORT
BLOOMINGTON, ILLINOIS

CONSTRUCT NEW ARFF FACILITY
DRAINAGE PLAN 2

© Copyright CMT, Inc.
CMT
 CRAWFORD, MURPHY & TILLY, INC.
 CONSULTING ENGINEERS
 License No. 984-000613



DESIGN BY:	KLB
DRAWN BY:	DPA
CHECKED BY:	<i>RW</i>
APPROVED BY:	<i>RW</i>
DATE:	04/01/2008
JOB No:	0508509
IL PROJ. NO.	BMI-3797
AIP PROJ. NO.	3-17-0006-46 & 48
SHEET	27 OF 66 SHEETS