

K:\Bloomington\0508509_BMI_ARFF\Draw\Sheets
 FILE: EXCON01.dwg
 UPDATE BY: Kristy Brad
 PLOT DATE: 4/18/2008 8:31 AM
 BASE_EXISTGEO
 PROPGEO
 BASE_EXISTTOPO
 SITE KEYMAP

BL064

REVISIONS		
NUMBER	BY	DATE

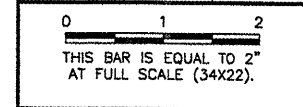

LEGEND

	NEW BUILDING BY OTHERS
	EXISTING DITCHLINE
	EXISTING OVERHEAD ELECTRIC UTILITY
	EXISTING UNDERDRAIN
	EXISTING RUNWAY CENTERLINE LIGHTING CABLE
	EXISTING RUNWAY EDGE LIGHTING CABLE
	EXISTING F.A.A. CABLE
	EXISTING FENCE
	EXISTING GATE
	EXISTING CONTOUR
	EXISTING SANITARY SEWER
	EXISTING SANITARY MANHOLE
	EXISTING STORM SEWER
	EXISTING INLET
	EXISTING END SECTION
	EXISTING UNDERDRAIN
	EXISTING CLEANOUT
	EXISTING FIRE HYDRANT
	EXISTING GAS LINE
	EXISTING ELECTRICAL MANHOLE
	EXISTING LIGHT POLE
	EXISTING SPLICE CAN
	EXISTING UTILITY POLE
	EXISTING GUY WIRE ANCHOR
	EXISTING GATE POST
	EXISTING ROADWAY SIGN
	EXISTING TELEPHONE PEDESTAL
	EXISTING BUILDING
	EXISTING DUCT/CABLE MARKER
	EXISTING BASE MOUNTED RUNWAY EDGE LIGHT
	EXISTING RUNWAY GUIDANCE/DTG SIGN
	EXISTING RUNWAY CENTERLINE LIGHT
	EXISTING CROP LIMITS
	REMOVAL
	RELOCATE
	ADJUST
	REMOVAL PAVEMENT
	SOIL BORING

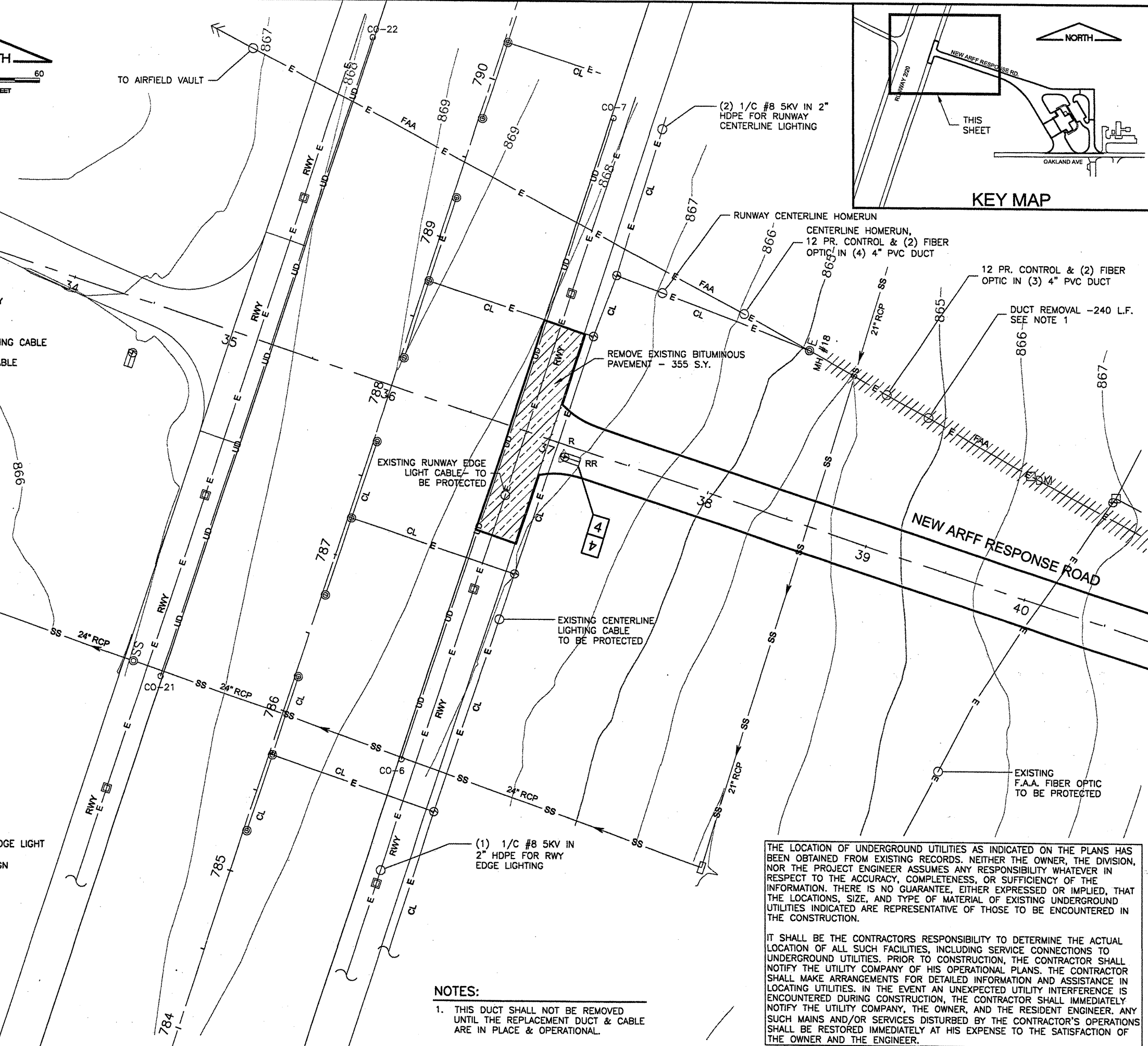

NOTES:
 1. THIS DUCT SHALL NOT BE REMOVED UNTIL THE REPLACEMENT DUCT & CABLE ARE IN PLACE & OPERATIONAL.

THE LOCATION OF UNDERGROUND UTILITIES AS INDICATED ON THE PLANS HAS BEEN OBTAINED FROM EXISTING RECORDS. NEITHER THE OWNER, THE DIVISION, NOR THE PROJECT ENGINEER ASSUMES ANY RESPONSIBILITY WHATEVER IN RESPECT TO THE ACCURACY, COMPLETENESS, OR SUFFICIENCY OF THE INFORMATION. THERE IS NO GUARANTEE, EITHER EXPRESSED OR IMPLIED, THAT THE LOCATIONS, SIZE, AND TYPE OF MATERIAL OF EXISTING UNDERGROUND UTILITIES INDICATED ARE REPRESENTATIVE OF THOSE TO BE ENCOUNTERED IN THE CONSTRUCTION.

IT SHALL BE THE CONTRACTORS RESPONSIBILITY TO DETERMINE THE ACTUAL LOCATION OF ALL SUCH FACILITIES, INCLUDING SERVICE CONNECTIONS TO UNDERGROUND UTILITIES. PRIOR TO CONSTRUCTION, THE CONTRACTOR SHALL NOTIFY THE UTILITY COMPANY OF HIS OPERATIONAL PLANS. THE CONTRACTOR SHALL MAKE ARRANGEMENTS FOR DETAILED INFORMATION AND ASSISTANCE IN LOCATING UTILITIES. IN THE EVENT AN UNEXPECTED UTILITY INTERFERENCE IS ENCOUNTERED DURING CONSTRUCTION, THE CONTRACTOR SHALL IMMEDIATELY NOTIFY THE UTILITY COMPANY, THE OWNER, AND THE RESIDENT ENGINEER. ANY SUCH MAINS AND/OR SERVICES DISTURBED BY THE CONTRACTOR'S OPERATIONS SHALL BE RESTORED IMMEDIATELY AT HIS EXPENSE TO THE SATISFACTION OF THE OWNER AND THE ENGINEER.

**BLOOMINGTON-NORMAL AIRPORT AUTHORITY
 CENTRAL ILLINOIS REGIONAL AIRPORT
 BLOOMINGTON, ILLINOIS**

**CONSTRUCT NEW ARFF FACILITY
 EXISTING CONDITIONS & REMOVALS 1**

CMT
 CRAWFORD, MARRRY & TILLY, INC.
 CONSULTING ENGINEERS
 License No. 184-000813

DESIGN BY:	RLV
DRAWN BY:	DPA
CHECKED BY:	RLV
APPROVED BY:	RLV
DATE:	04/01/2008
JOB No:	0508509
IL PROJ. NO.	BMI-3797
AIP PROJ. NO.	3-17-0006-46 & 48
SHEET	07 OF 66 SHEETS