

CURVE DATA
 $\Delta = 10^{\circ}11'45''$ $T = 230.16'$
 $D = 2^{\circ}13'15''$ $L = 459.11'$
 $R = 2580.00'$ $E = 10.25'$
 $S.E. = 0.043'/ft.$
 Attain Sta. 107+02 to Sta. 108+28
 Remove Sta. 112+30 to Sta. 113+56

ROUTE	SECTION	COUNTY	TOTAL SHEETS	SHEET NO.
FAS 928	05-00060-00-RS	JOHNSON	7	4
PROJECT NO. RS-928 (105)			CONTRACT NO. 99333	

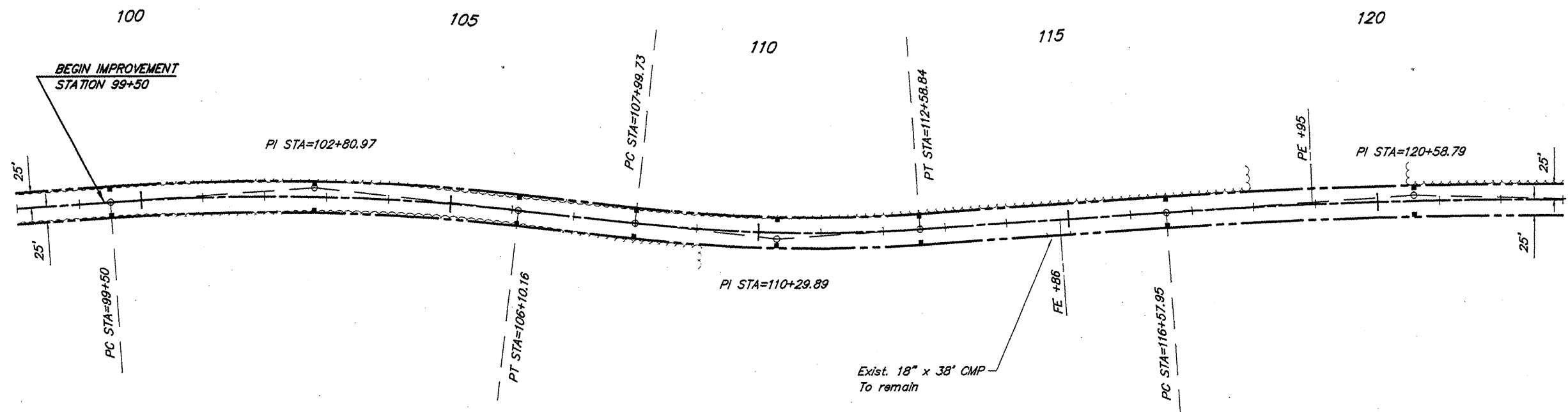

CURVE DATA
 $\Delta = 10^{\circ}17'14''$ $T = 330.97'$
 $D = 1^{\circ}33'30''$ $L = 660.15'$
 $R = 3676.79'$ $E = 14.87'$
 $S.E. = 0.032'/ft.$
 Attain Sta. 98+67 to Sta. 99+71
 Remove Sta. 105+89 to Sta. 106+93

CURVE DATA
 $\Delta = 5^{\circ}14'45''$ $T = 400.84'$
 $D = 0^{\circ}39'17''$ $L = 801.12'$
 $R = 8750.00'$ $E = 9.18'$
 Normal Crown

SCALES:
 1" = 200' HOR
 1" = 10' VER

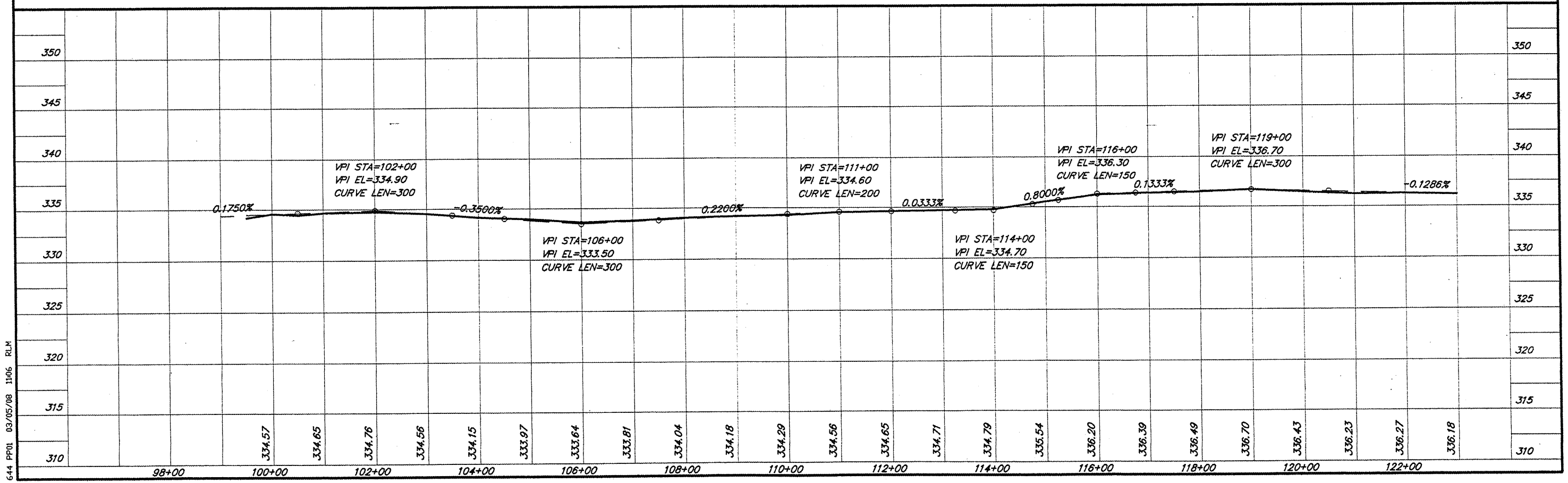

644 PPOI 03/05/08 1106 RLH