

T.R. RTE.	SECTION	COUNTY	TOTAL SHEETS	SHEET NO.
50	05-03104-00-BR	JERSEY	12	1
FED. ROAD DIST. NO. - ILLINOIS FED. AID PROJECT			CONTRACT NO. 97334	

STATE OF ILLINOIS DEPARTMENT OF TRANSPORTATION

PLANS FOR PROPOSED HIGHWAY BRIDGE PROGRAM

PROJECT NO. BROS-0083(041)
T.R. 50 OVER TRIBUTARY OF PHILS CREEK
SECTION 05-03104-00-BR
FIDELITY TOWNSHIP
JERSEY COUNTY
JOB NO. C-98-358-06

- INDEX OF SHEETS**
- 1 - TITLE SHEET
 - 2 - SUMMARY OF QUANTITIES, GENERAL NOTES, DETAILS, & TYPICAL SECTIONS
 - 3 - PLAN & PROFILE
 - 4 - GENERAL PLAN & ELEVATION
 - 5 - SUPERSTRUCTURE
 - 6 - RAILING
 - 7 - SOUTH ABUTMENT
 - 8 - NORTH ABUTMENT
 - 9 - ABUTMENT DETAILS
 - 10 - 12 - CROSS SECTIONS

STANDARDS

STANDARD 515001-02
STANDARD 701901
STANDARD BLR 21-7

LIST OF UTILITIES

Frontier Communications
225 N. Broad Street
Carlinville, Illinois 62626
1-217-854-4013

M.J.M. Electric Cooperative, Inc.
P.O. Box 80
Carlinville, Illinois 62626
1-217-854-3137

Jersey County Rural Water
1009 E. Shipman Road
Jerseyville, Illinois 62052
1-618-498-9534

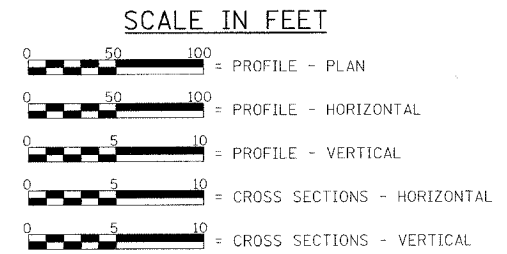

LAND SECTION - 8
LAND QUARTER SECTION - N.E.
FUNCTIONAL CLASSIFICATION: LOCAL ROAD (NON-URBAN)
A.D.T. - 75 (2002)
A.D.T. - 120 (2021)
30 M.P.H. DESIGN SPEED

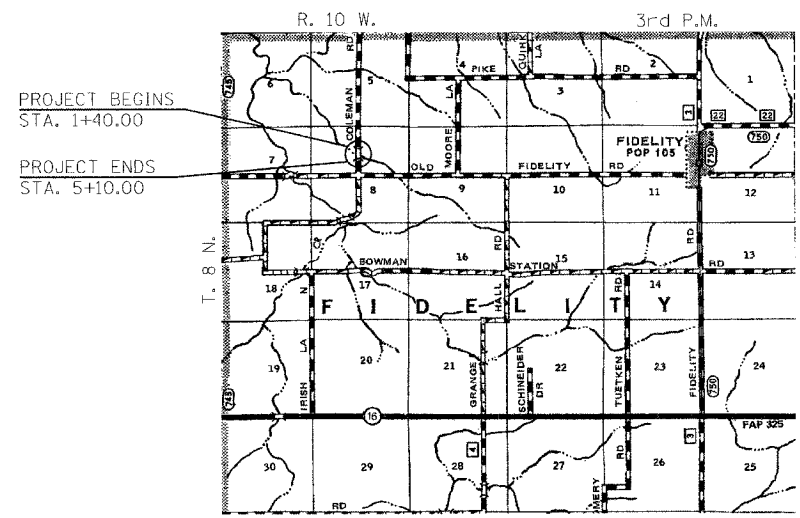

LOCATION PLAN

LENGTH OF SECTION - 370.00 FEET = 0.070 MILES

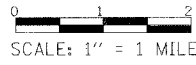

EXISTING STRUCTURE:
SINGLE SPAN POURED CONCRETE DECK ON STEEL STRINGERS FOUNDED ON CLOSED CONCRETE ABUTMENTS. ±20'-0" OUT.-OUT. DECK, ±20'-6" BK.-BK. ABUTMENTS. STEEL CHANNEL RAIL POSTS WITH NO RAILING. 0° SKEW.
EXISTING STRUCTURE NO. 042-3049.

PROPOSED STRUCTURE:
SINGLE SPAN PRECAST PRESTRESSED CONCRETE DECK BEAM (21") BRIDGE ON CLOSED CONCRETE ABUTMENTS. 24'-0" OUT. TO OUT. DECK, 48'-0" BK.-BK. ABUTMENTS. STEEL RAILING TYPE S1. 25° SKEW LT. FORWARD.
PROPOSED STRUCTURE NO. 042-3144.

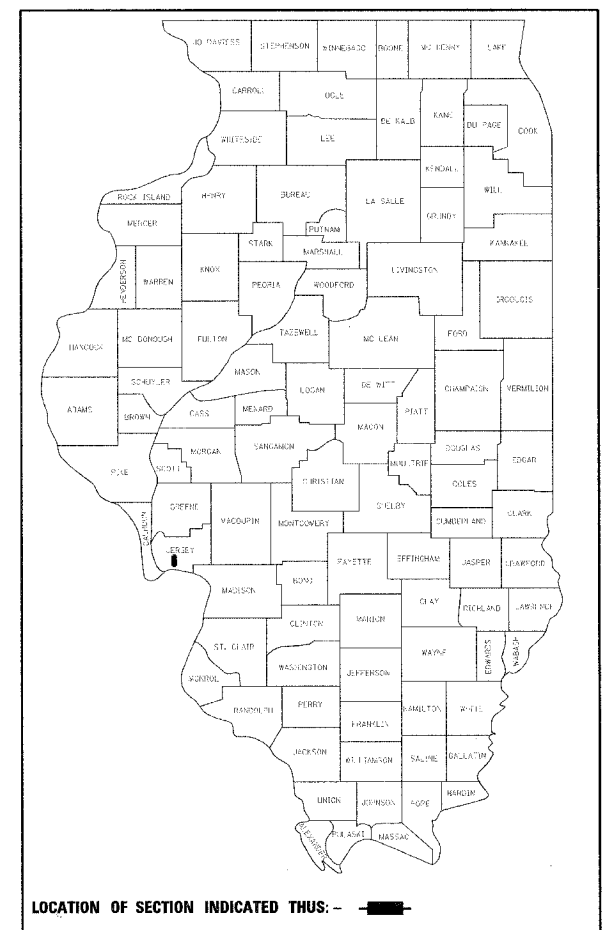

APPROVED: 2/15 2008
Randy Williams
TOWNSHIP HIGHWAY COMMISSIONER

APPROVED: 2/15 2008
Thomas I. Wines
COUNTY ENGINEER

PASSED: 4/9 2008
[Signature]
DISTRICT EIGHT ENGINEER OF LOCAL ROADS & STREETS

Releasing For Bid Based on Limited Review: 4/9 2008
Wayne Lewis
DEPUTY DIRECTOR OF HIGHWAYS, REGION FIVE ENGINEER

STATE OF ILLINOIS
DEPARTMENT OF TRANSPORTATION

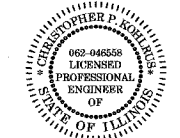

Christopher P. Kohlman 2/19/08
EXPIRATION: 11/30/2009

TOLL FREE
"JOINT UTILITY LOCATION INFORMATION FOR EXCAVATORS"
(CALL I.E.) TELEPHONE NUMBER
1-800-892-0123

FILE NAME: #P0715	USER NAME: #BJCR*	DESIGNED: -	REVISED: -
		DRAWN: -	REVISED: -
	PLC1 SCAL: #BSJWLEP	CHECKED: -	REVISED: -
	PL0F DATE: #DATE*	DATE: -	REVISED: -

Allen Henderson & Associates, Inc.
Civil and Structural Engineers Springfield, IL.
62703 Phone: (217)544-8033 IL Design Firm
No. 184-001907

TITLE SHEET

SCALE: 1" = 1 MILE SHEET NO. 1 OF 12 SHEETS STA. 1+40.00 TO STA. 5+10.00

T.R. RTE.	SECTION	COUNTY	TOTAL SHEETS	SHEET NO.
50	05-03104-00-BR	JERSEY	12	1
FED. ROAD DIST. NO. - ILLINOIS FED. AID PROJECT			CONTRACT NO. 97334	