

**EX. CURVE DATA:**  
 P.I. STA. 388+74.72  
 $\Delta = 30^{\circ}59'41''$   
 $D = 16^{\circ}00'00''$   
 $R = 358.10'$   
 $T = 99.29'$   
 $L = 193.72'$   
 $E = 13.51'$   
 $SE = 0.04\%/FT$  & VARIABLE  
 (NON-UNIFORM DUE TO PREVIOUS RAILROAD CROSSING)

**PR. CURVE DATA:**  
 P.I. STA. 388+77.14  
 $\Delta = 30^{\circ}59'41''$   
 $D = 16^{\circ}00'00''$   
 $R = 358.10'$   
 $T = 99.29'$   
 $L = 193.72'$   
 $E = 13.51'$   
 $SE = R.C. (1.5\%)$   
 $TR = STA. 386+43.69$  TO  $STA. 387+64.15$   
 $SE TRANSITION = STA. 387+64.15$  TO  $STA. 387+84.61$   
 $FULL SE = STA. 387+84.61$  TO  $STA. 389+61.35$   
 $SE TRANSITION = STA. 389+61.35$  TO  $STA. 389+81.81$   
 $TR = STA. 389+81.81$  TO  $STA. 390+02.27$

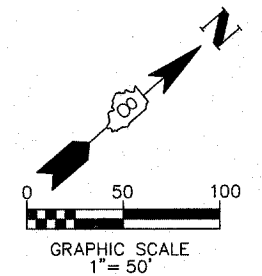

REV	DATE	DESCRIPTION
△	XX/XX/XX	XXXXXXXX
△	XX/XX/XX	XXXXXXXX

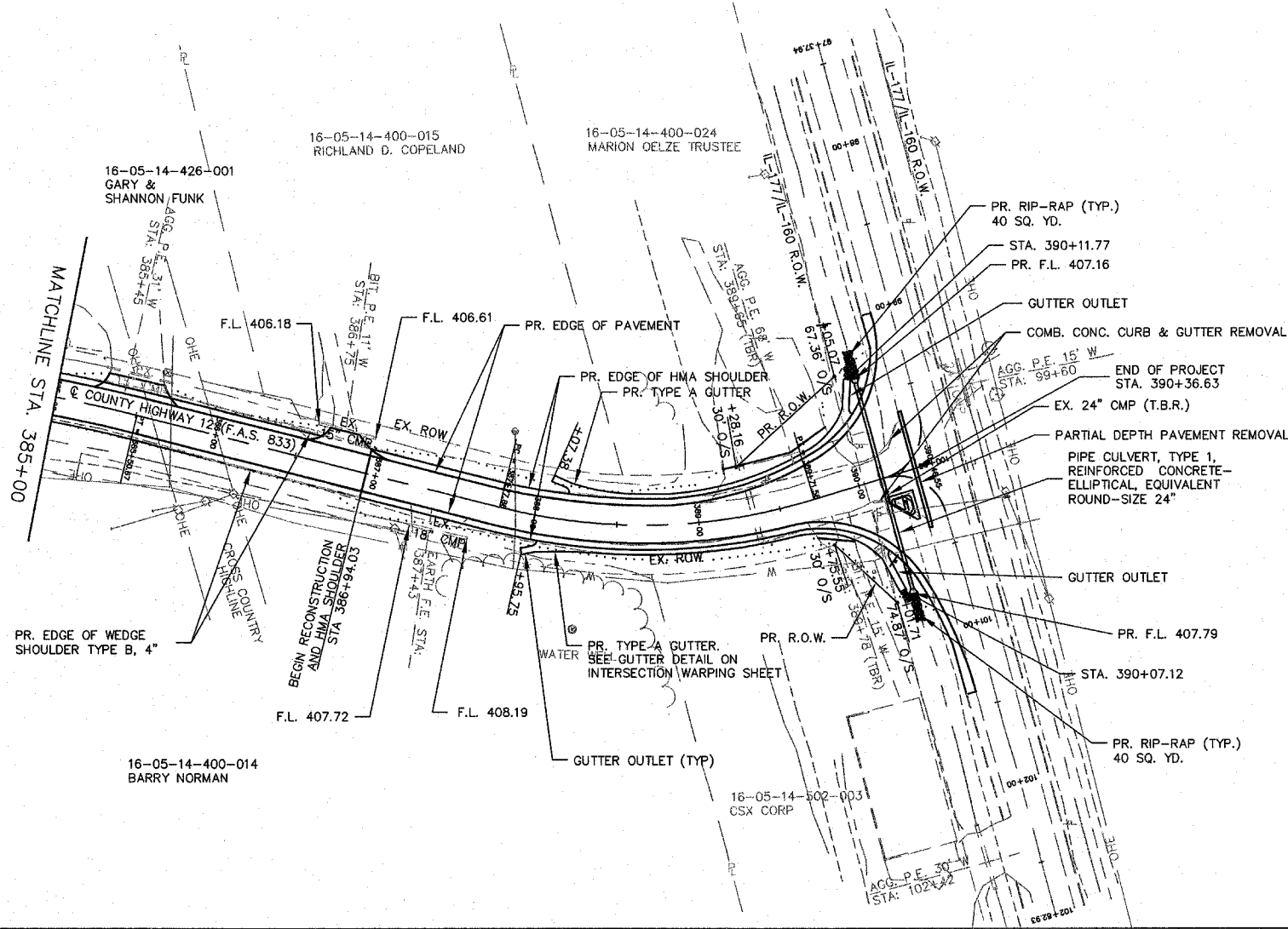
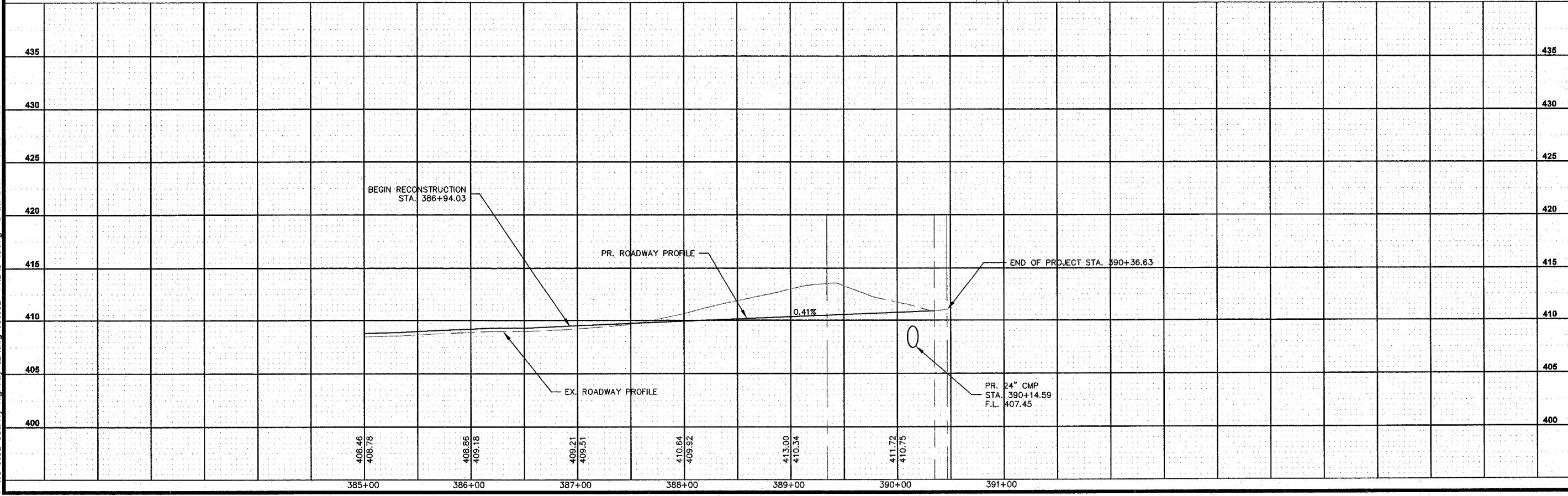

**SHEET TITLE:** ROADWAY PLAN & PROFILE  
 STA. 385+00 TO END STA. 390+46.54

**PROJECT TITLE:** COUNTY HIGHWAY 12 (F.A.S. 833)  
 SECTION 06-00080-00-RS  
 RESURFACING & REHABILITATION  
 WASHINGTON COUNTY, ILLINOIS

DESIGNED BY: CHA	SHEET <b>18</b>
DRAWN BY: CHA	
CHECKED BY: TJM	
DATE OF PRELIMINARY: 11/9/2007	
DATE OF FINAL: 12/28/2007	
SHEET NO. 18 OF 24 SHEETS	
PROJECT NUMBER 06-0032	

**Kaskaskia Engineering Group LLC.**  
 25 Public Square Suite 404  
 Belleville, Illinois 62220  
 Office: (618)-233-5877 Fax: (618)-233-5977  
 www.kaskaskiaeng.com  
 A Disadvantaged Business Enterprise

PREPARED BY: 

PROFESSIONAL REGISTRATIONS LICENSE NO. 18A0073  
 ILLINOIS PROFESSIONAL DESIGN FIRM 20-500086  
 PROFESSIONAL ENGINEERING CORP.

P:\06-0032 County Highway 12.dwg, 060032-PPR01A-D-01.dwg, 2/22/2007 7:07:56 AM CST