

EX./PR. CURVE DATA
 P.I. STA. 305+41.56
 Δ = 01°43'35"R
 D = 00'12.54"
 R = 26632.97'
 T = 401.27'
 L = 802.48'
 E = 3.02'
 SE = NONE

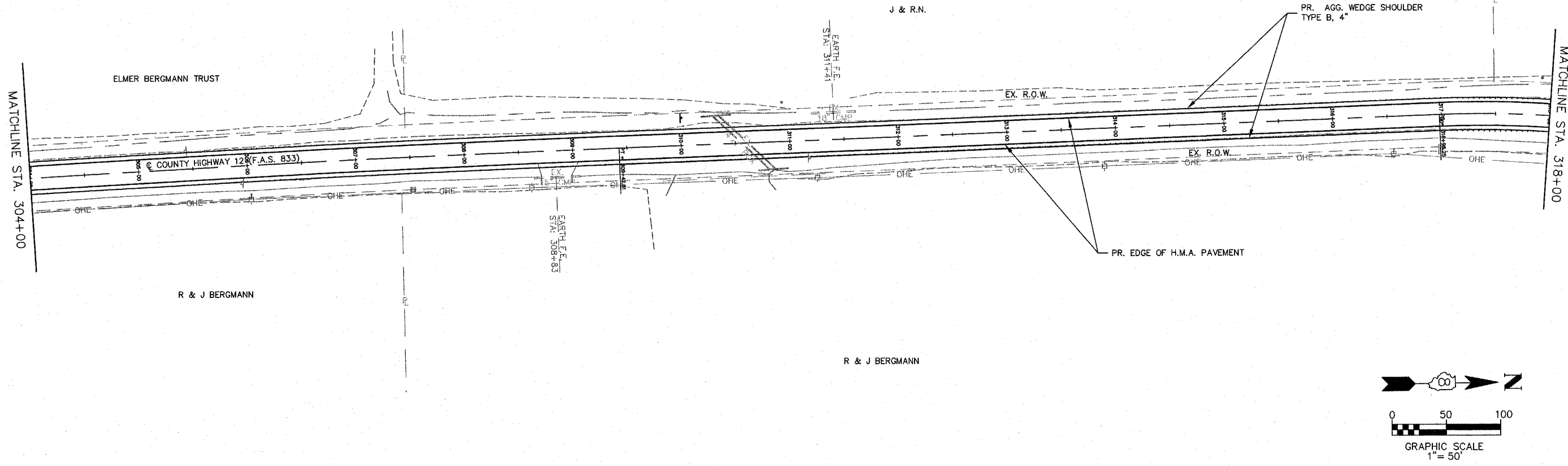

Kaskaskia Engineering Group L.L.C.
 23 Public Square Suite 404
 Belleville, Illinois 62220
 Office: (618) 233-5877 Fax: (618) 233-5977
 www.kaskaskiaeng.com
 A Disadvantaged Business Enterprise

PROFESSIONAL REGISTRATIONS LICENSE NO. 1800073
 ILLINOIS PROFESSIONAL DESIGN FIRM 20-080808
 PROFESSIONAL ENGINEERING CORP.

P:\06-0032 County Highway 12\dwg\060032-PPRIAD-01.dwg 2/22/2007 7:07:56 AM CST

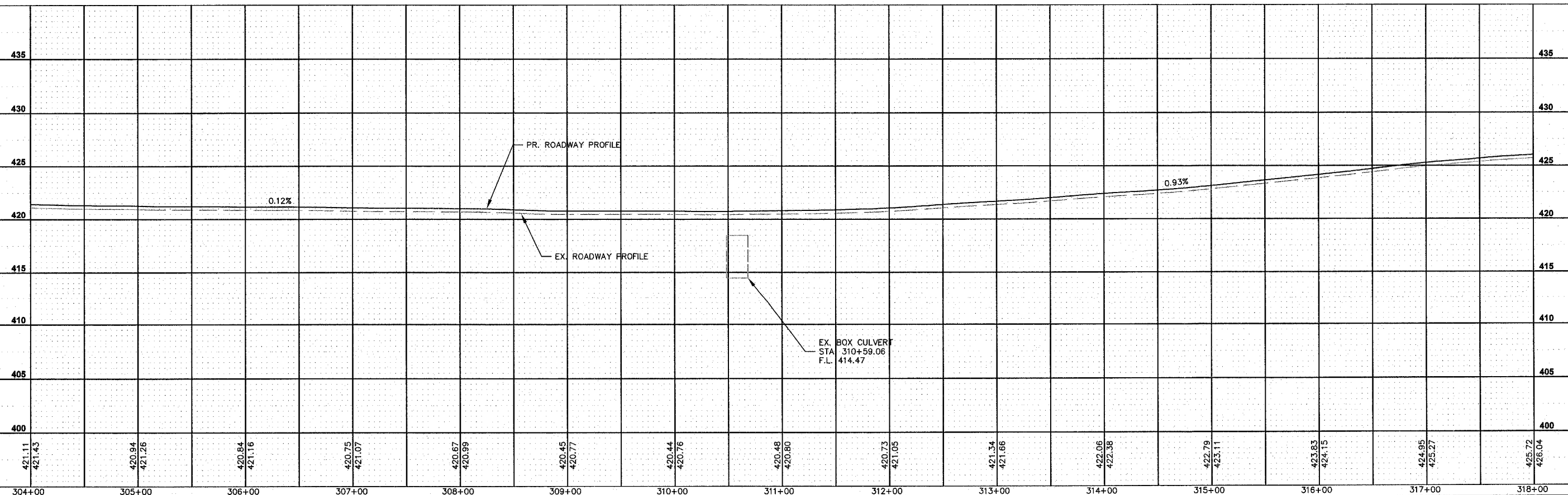

REV	DATE	DESCRIPTION
△	XX/XX/XX	XXXXXXXX
△	XX/XX/XX	XXXXXXXX

SHEET TITLE: ROADWAY PLAN & PROFILE
 STA. 304+00 TO STA. 318+00

PROJECT TITLE: COUNTY HIGHWAY 12 (F.A.S. 833)
 SECTION 06-00080-00-RS
 RESURFACING & REHABILITATION
 WASHINGTON COUNTY, ILLINOIS

DESIGNED BY: CHA	SHEET
DRAWN BY: CHA	12
CHECKED BY: TJM	
DATE OF PRELIMINARY: 11/9/2007	
DATE OF FINAL: 12/28/2007	
SHEET NO. 12 OF 94 SHEETS	
PROJECT NUMBER 06-0032	