

NOTE:
 CLASS SI CONC. SHALL BE USED THROUGHOUT THE SPECIAL OUTLET.
 THIS WORK WILL BE PAID FOR AT THE CONTRACT UNIT PRICE PER FOOT FOR COMBINATION CONC. CURB & GUTTER, TYPE B-6.12
 QUANTITY = 10.0 FEET
 INLET, TYPE A, TYPE 9 FRAME & GRATE WILL BE PAID FOR SEPARATELY.

1 SPECIAL OUTLET

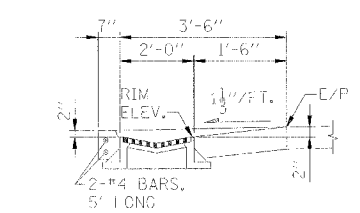

A SECTION

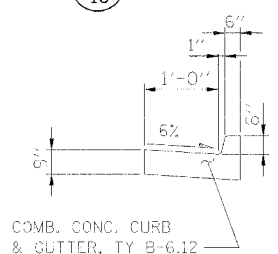

B SECTION

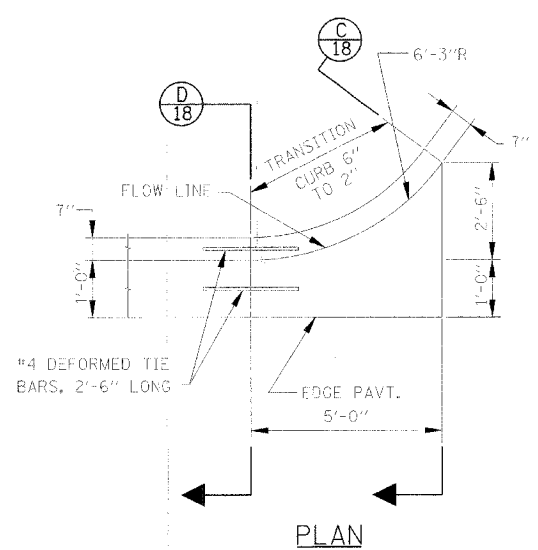

2 CURB & GUTTER OUTLET DETAIL

NOTE:
 CLASS SI CONC. SHALL BE USED THROUGHOUT THE CURB & GUTTER OUTLET.
 THIS WORK WILL BE PAID FOR AT THE CONTRACT UNIT PRICE PER FOOT FOR COMBINATION CONC. CURB & GUTTER, TYPE B-6.12
 QUANTITY = 5.0 FEET

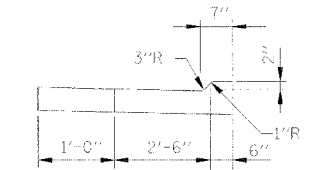

C SECTION

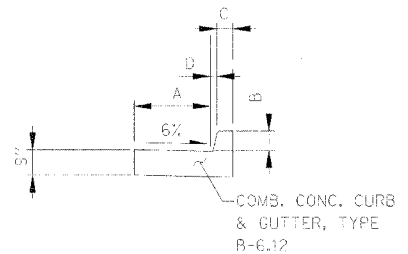

D SECTION

TABLE OF DIMENSIONS				
TYPE	A	B	C	D
B-6.12	1'-0"	6"	6"	1"

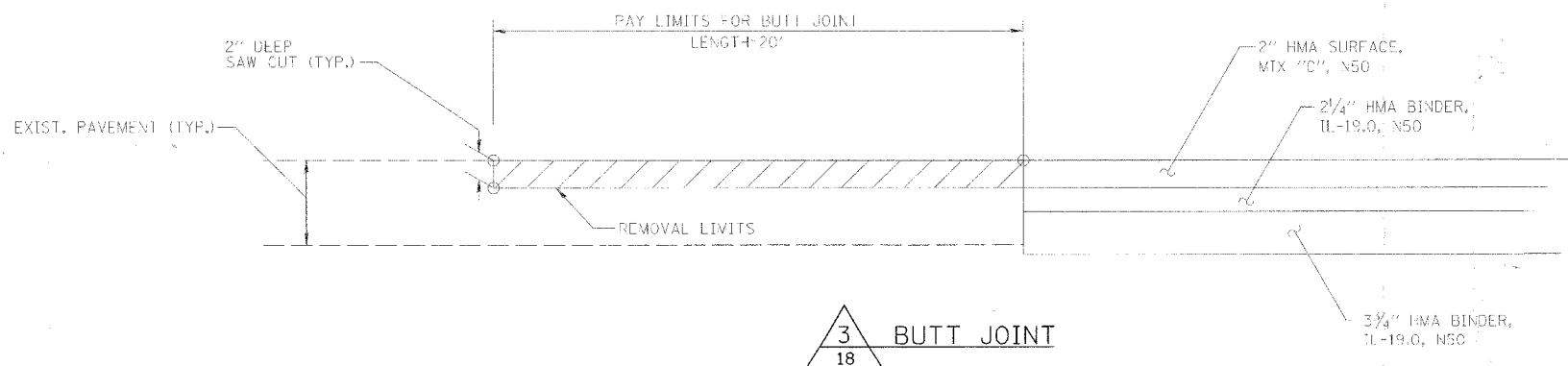

3 BUTT JOINT

FILE NAME = X:\CH\12\2007\07\08\PLANS\MSA.dwg

USER NAME = MJSFR	DESIGNED -	REVISED -
PLOT SCALE = 1/8"=1'	DRAWN -	REVISED -
PLOT DATE = 3/31/2008	CHECKED -	REVISED -
	DATE -	REVISED -

**STATE OF ILLINOIS
 DEPARTMENT OF TRANSPORTATION**

**MISCELLANEOUS
 DETAILS**

SCALE: SHEET NO. OF SHEETS STA. TO STA.

F.A. RTE.	SECTION	COUNTY	TOTAL SHEETS	SHEET NO.
N/A	02-00066-00-PV	CUMBERLAND	32	18
CONTRACT NO. 95553				
FED. ROAD DIST. NO. ILLINOIS FED. AID PROJECT				