

- H1**
RIM=652.90
INF=650.13 (12"E)
INF=650.13 (12"N)
EFF=650.13 (12"S)
- H2**
RIM=653.47
INF=FIELD VERIFY (EX 12"N)
EFF 650.27 (12"S)
- H3**
RIM=653.22
EFF=650.36 (12"W)
- K1**
RIM=656.50
EFF=651.71 (12"S)

	STATION	OFFSET
13	7+01.05	34.0' LT
14	7+71.04	36.0' LT
15	7+01.16	34.5' RT
16	7+71.16	34.5' RT
17	9+32.64	34.4' RT
18	9+72.64	34.4' RT
19	9+32.64	36.0' LT
20	9+72.64	36.0' LT

NOTE:
THE RADII ON ALL
ALLEY ARE 15 FEET.

CONTRACTOR SHALL FIELD VERIFY PROPOSED RIM ELEVATION AND EXIST. INVERTS PRIOR TO CONSTRUCTION/CASTING OF PROPOSED MANHOLES & INLETS AND MAKE NECESSARY ADJUSTMENTS AT NO ADDITIONAL COST.

THE LOCATION OF UTILITIES SHOWN ARE DETERMINED FROM THE BEST AVAILABLE DATA AND ARE FOR INFORMATION ONLY AND ARE NOT INTENDED TO PURPORT THE ACTUAL LOCATION OF SUCH UTILITIES. THE CONTRACTOR SHALL VERIFY THE LOCATION OF THE UTILITIES IN THE FIELD AT THE TIME OF CONSTRUCTION. THE CONTRACTOR SHALL BE RESPONSIBLE FOR PROTECTING ALL UTILITIES AND SHALL BE LIABLE FOR ANY DAMAGES TO THEM RESULTING FROM HIS OPERATIONS.

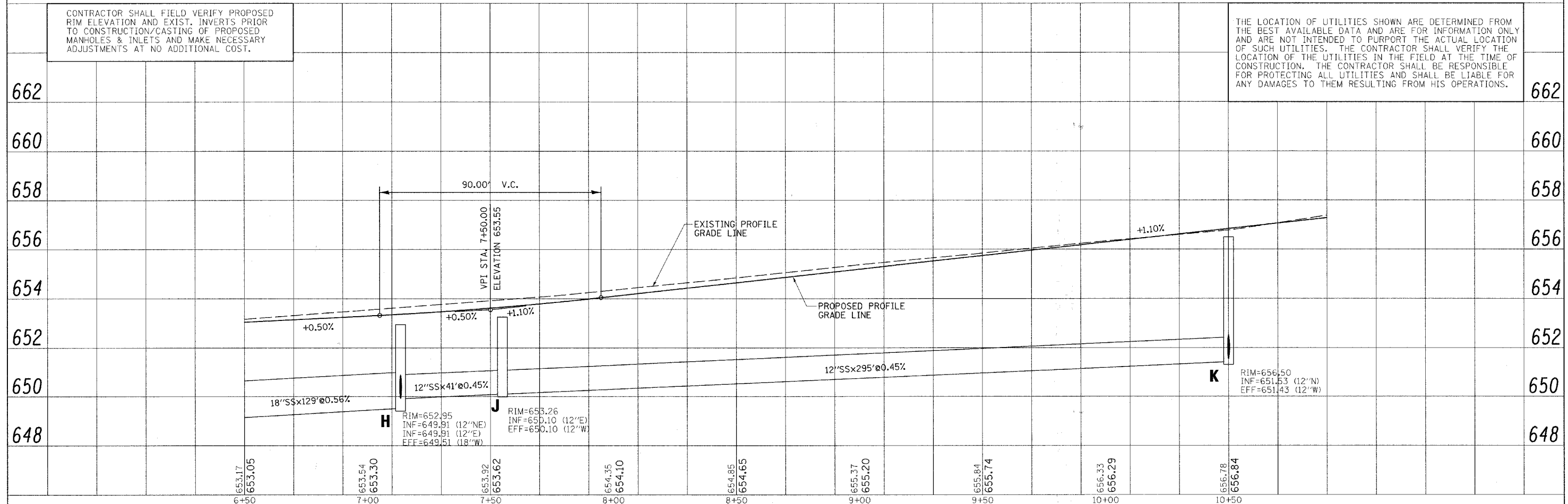

PLAN	SURVEYED	DATE
NOTE BOOK	PLotted	
NO.	FILE NAME	

PROFILE	SURVEYED	DATE
NOTE BOOK	PLotted	
NO.	FILE NAME	