

B.M. - Chisled "□" on top concrete abutment, southeasterly corner of existing bridge SN 069-3172, Elevation 604.87

Existing Structure - Single span concrete deck on steel I-Beams, with concrete abutments and timber piles. Structure to be removed.

Approximate quantities for removal: 40 cu yd of concrete, 90 ft of timber pile, 9.6 kips of structural steel, 68 ft of railing, 34.0' back to back abutments
Bridge width = 24.0' out to out of deck

No Salvage

STATE OF ILLINOIS
DEPARTMENT OF TRANSPORTATION

RTE.	SECTION	COUNTY	TOTAL SHEETS	SHEET NO.
TR-195	06-08117-00-BR	MORGAN	14	6
FED. ROAD DIST. NO.	ILLINOIS	CONTRACT NO.		

SHEET NO. 1
4 SHEETS

93461

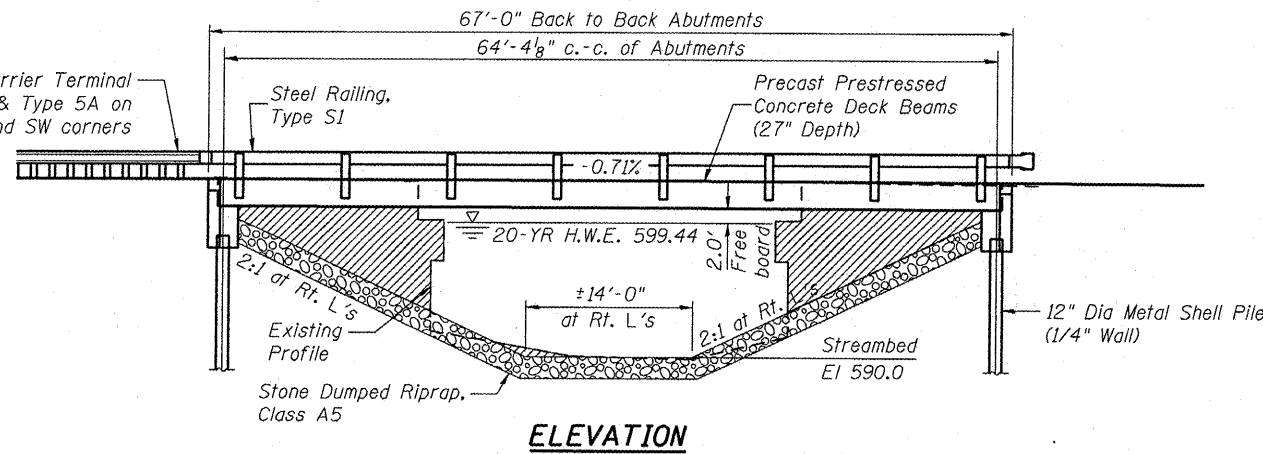

ELEVATION

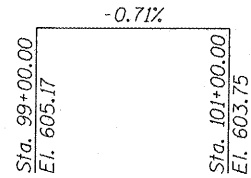

PROFILE GRADE

DESIGN SPECIFICATIONS

2002 AASHTO Standard Specifications - 17th ed.

LOADING HS20-44

Allow 25#/sq. ft. for future wearing surface.

SEISMIC DATA

Seismic Performance Category (SPC) = A
Bedrock Acceleration Coefficient (A) = 4.9

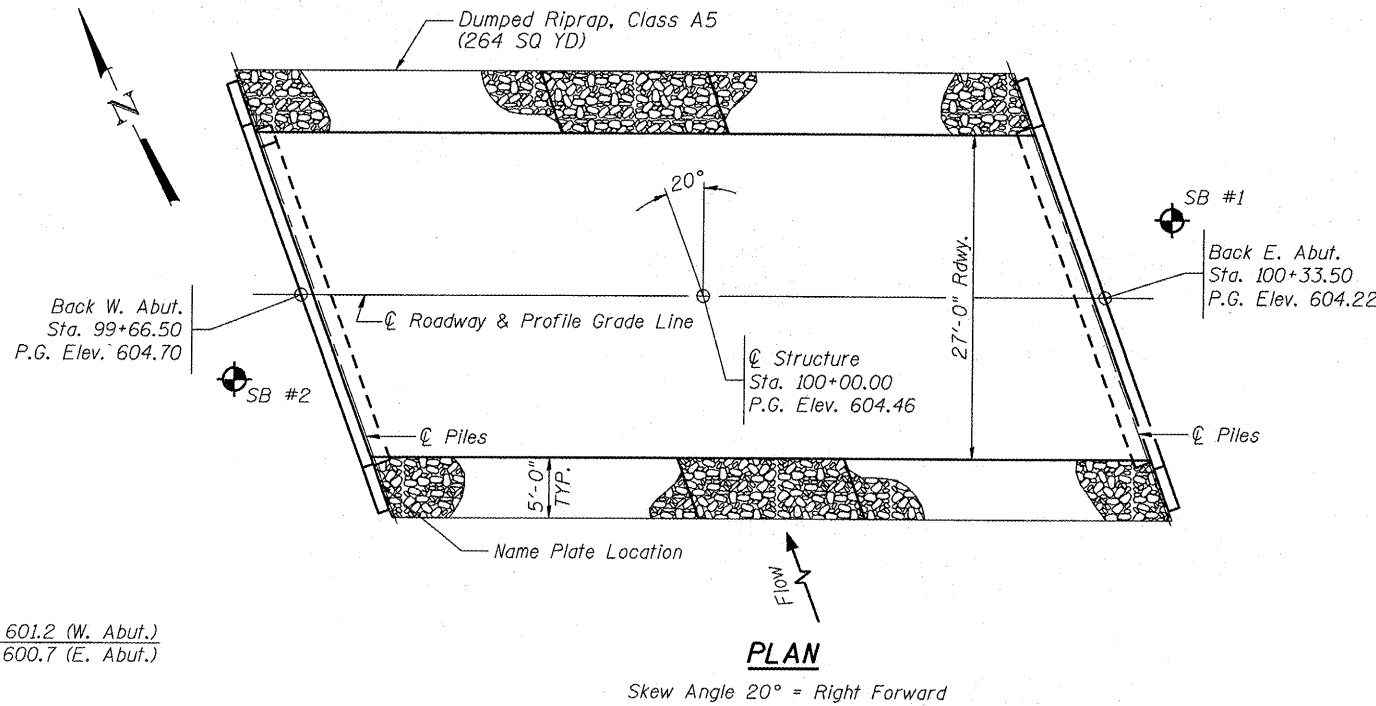

PLAN

Skew Angle 20° = Right Forward

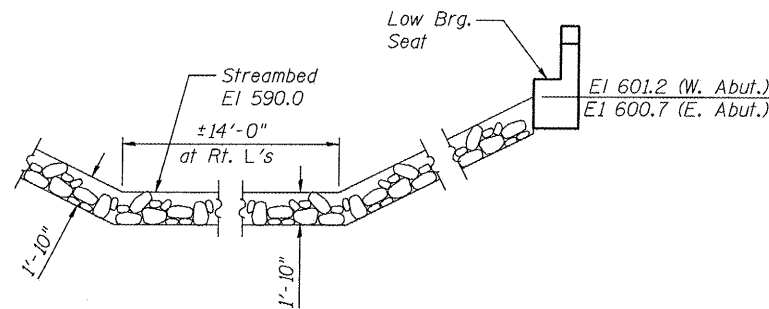

STONE RIPRAP DETAIL

WATERWAY INFORMATION

Drainage Area = 7.2 Sq. Mi.		Low Grade Elev. = 603.4 @ Sta. 102+80.0								
Flood	Freq. Yr.	Q C.F.S.	Opening Sq. Ft.	Nat. H.W.E.	Head - Ft.	Headwater El.	Exist.	Prop.	Exist.	Prop.
Design	20	1800	247	285	599.44	0.32	0.02	599.76	599.46	
Base	100	2700	274	304	601.32	0.74	-0.48	601.06	599.84	
Max. Calc.	500	3500	266	331	600.79	0.68	-0.41	601.47	600.38	

MAUVAISE TERRE CREEK TRIB
BUILT 20__ BY
ROAD DISTRICT NO. 8
MORGAN COUNTY
SECTION 06-08117-00-BR
STATION 100+00.00
STR. NO. 069-3264 LOADING HS20

LETTERING FOR NAME PLATE

Locate Name Plate
in Southwest Wing.

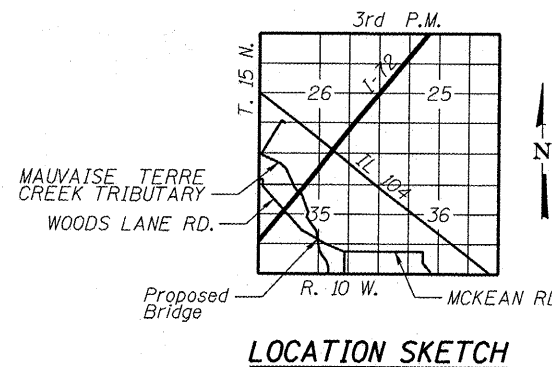

LOCATION SKETCH

GENERAL NOTES

- The Contractor shall drive 1 test pile to 110% of the nominal required bearing, as specified, in a permanent location as directed by the Engineer before ordering the remaining piles.
- See Special Provisions for boring logs.
- A Corrosion inhibitor, according to Article 1020.05(b)(12), shall be used in the concrete for precast prestressed concrete deck beams.

INDEX OF SHEETS

- General Plan & Elevation
- Superstructure Details
- Abutment Details
- Type S-1 Steel Railing

TOTAL BILL OF MATERIAL

Item	Unit	Super	Sub.		Total
			Piers	Abutts.	
Removal of Existing Structures	L. Sum				1
Hot-Mix Asphalt Surface Course, Mix "C", N50	Ton	28			28
Waterproofing Membrane System	Sq. Yd.	196			196
Concrete Structures	Cu. Yd.			23.8	23.8
Precast Prestressed Concrete Deck Beams (27" Depth)	Sq. Ft.	1764			1764
Steel Railing, Type S-1	Foot	133			133
Reinforcement Bars, Epoxy Coated	Pound			3030	3030
Furnishing Metal Shell Piles 12"	Foot			410	410
Driving Piles	Foot			410	410
Test Pile Metal Shells	Each			1	1
Name Plates	Each	1			1
Stone Dumped Riprap, Class A5	Ton			252	252
Structure Excavation	Cu. Yd.			88	88
Channel Excavation	Cu. Yd.			588	588

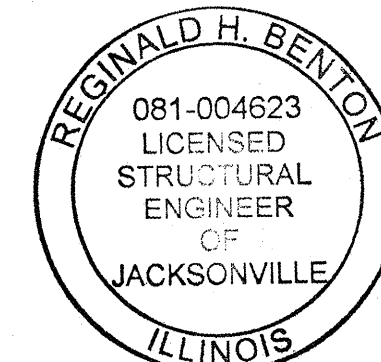

EXPIRES: 11/30/2008
BY: *Reginald H. Benton*
DATE: 3/17/2008

I certify that to the best of my knowledge, information and belief, this bridge design is structurally adequate for the design loading shown on the plans. The design is an economical one for the style of the structure and complies with requirements of the current "AASHTO Standard Specifications for Highway Bridges".

DRAWN BY: JLL	GENERAL PLAN AND ELEVATION		
CHECKED BY: NRF	S.N. 069-3264		
APPROVED BY: REG	BRIDGE TR-195 OVER		
DATE: JANUARY 2008	MAUVAISE TERRE CREEK TRIBUTARY		
MORGAN COUNTY, ILLINOIS			
BENTON & ASSOCIATES, INC.			
Consulting Engineers / Land Surveyors			
1970 West Lafayette Ave. Jacksonville, IL 62650			
Phone: 217-245-4146 Fax: 217-245-4149			
IL Design Firm Registration No. 184-000852			
FIELD BOOK:	SCALE:	JOB NO. 07E1789	SHEET 6 OF 14