

F.A. RTE.	SECTION	COUNTY	TOTAL SHEETS	SHEET NO.
	06-00334-00-SW	MCLEAN	14	C5.0
STA.	TO STA.			
FED. ROAD DIST. NO.	ILLINOIS	FED. AID PROJECT		

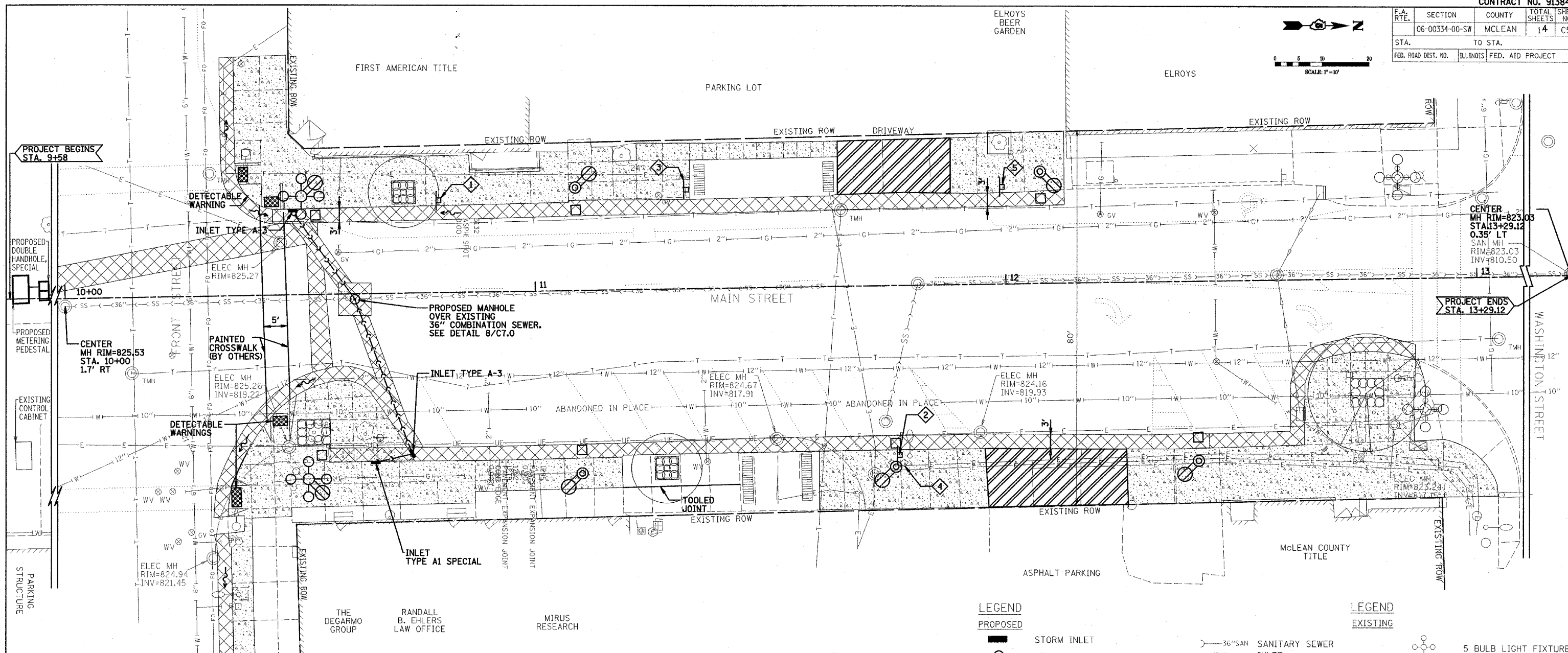
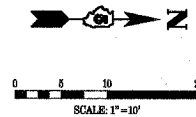

- NOTES**
- THIS CONSTRUCTION SHALL BE IN ACCORDANCE WITH THE SPECIAL PROVISIONS ACCOMPANYING THESE PLANS AND THE FOLLOWING SPECIFICATIONS:
 - "STANDARD SPECIFICATIONS FOR WATER AND SEWER MAIN CONSTRUCTION IN ILLINOIS", 5TH EDITION, DATED MAY, 1996".
 - "STANDARD SPECIFICATIONS FOR ROAD AND BRIDGE CONSTRUCTION", ADOPTED JANUARY, 1, 2007, BY THE ILLINOIS DEPARTMENT OF TRANSPORTATION.
 - "SUPPLEMENTAL SPECIFICATIONS AND RECURRING SPECIAL PROVISIONS", ADOPTED JANUARY 1, 2008, BY THE ILLINOIS DEPARTMENT OF TRANSPORTATION.
 - "MANUAL ON UNIFORM TRAFFIC CONTROL DEVICES FOR STREETS AND HIGHWAYS" AND THE ILLINOIS SUPPLEMENT TO THE MANUAL ON UNIFORM TRAFFIC CONTROL DEVICES.
 - HANDICAP RAMPS SHALL BE BUILT IN ACCORDANCE WITH I.D.O.T. STANDARD 424001-04. HANDICAP RAMPS SHALL BE CONSTRUCTED WHERE THE PROPOSED SIDEWALK INTERSECTS PROPOSED OR EXISTING COMBINATION CURB AND GUTTER FOR DRIVEWAYS, ALLEYS, PAVEMENTS, STREETS OR AS MAY BE INDICATED ON THE DRAWINGS.
 - JOINTS IN PROPOSED SIDEWALK SHALL BE TOOLED AT MINIMUM 5' INTERVALS OR AS MAY CORRESPOND TO EXISTING JOINTS OF ADJACENT SIDEWALKS. JOINT LOCATIONS INDICATED ON THE PLANS ARE FOR REFERENCE ONLY. THE CONTRACTOR SHALL SUBMIT A LAYOUT PLAN OF ALL JOINTS TO THE ENGINEER PRIOR TO CONSTRUCTION OF THE SIDEWALK. NO ADDITIONAL COMPENSATION WILL BE ALLOWED.
 - PROVIDE EROSION CONTROL AROUND ALL EXISTING AND PROPOSED MANHOLES AND INLETS, PER EACH FOR INLET PIPE PROTECTION.
 - THE CONTRACTOR SHALL INSTALL 1/2" EXPANSION JOINTS WHEREVER THE PROPOSED SIDEWALK IS ADJACENT TO THE EXISTING BUILDING, THE EXISTING SIDEWALK THAT WILL REMAIN AND AT OTHER LOCATIONS INDICATED ON THE DRAWINGS.
 - THE CONTRACTOR SHALL MOVE EXISTING PLANTERS, BENCHES OR OTHER ITEMS WHICH ARE TO REMAIN AND WHICH CONFLICT WITH THE CONSTRUCTION. THIS WORK SHALL NOT BE PAID FOR SEPARATELY BUT SHALL BE INCIDENTAL TO THE CONTRACT.
 - NO PROFILE SHOWN HEREIN, GRADES VARY. SEE GRADING AND EROSION CONTROL SHEET AND MATCH EXISTING SIDEWALK ELEVATIONS. SLOPE TO DRAIN AWAY FROM BUILDINGS AND PARKING LOT.

- GENERAL KEYNOTES**
- EXISTING COMPACT CAR PARKING SIGN TO BE REUSED ON NEW TELESCOPING STEEL SIGN SUPPORT.
 - EXISTING SIGN R3-7R TO BE REUSED ON NEW TELESCOPING STEEL SIGN SUPPORT.
 - EXISTING SIGNS FROM LIGHT POLE TO BE REUSED ON NEW TELESCOPING STEEL SIGN SUPPORT.
 - EXISTING NEWSPAPER BOX TO BE REPLACED.
 - EXISTING SIGN R6-2R AND 90 MINUTE PARKING SIGN TO BE REUSED ON NEW TELESCOPING STEEL SIGN SUPPORT.

LEGEND

	PROPOSED STORM INLET		EXISTING 36" SANITARY SEWER		5 BULB LIGHT FIXTURE
	PROPOSED STORM MANHOLE		EXISTING 18" SS STORM SEWER		FENCE
	PROPOSED SIGN		EXISTING UNDERGROUND TELEPHONE		DITCH LINE
	PROPOSED SIDEWALK, SPECIAL		EXISTING GAS MAIN		IRON ROD
	PROPOSED CONCRETE DRIVEWAY		EXISTING GAS VALVE		IRON PIPE
	PROPOSED HOT MIX ASPHALT OVER PCC BASE COURSE		EXISTING WATER SERVICE SHUTOFF SIGN		EVERGREEN TREE
	PROPOSED SINGLE POLE LIGHT FIXTURE AND POLE W/RECEPTACLE		EXISTING UNDERGROUND ELECTRIC		TREE W/DIA.
	PROPOSED 5 BULB LIGHT FIXTURE AND POLE WITH RECEPTACLE		EXISTING POLE DOWN GUY		SAPLING
	PROPOSED TREE		EXISTING TELEPHONE POLE		RAILROAD SPIKE
	PROPOSED DETECTABLE WARNINGS		EXISTING LIGHT POLE		WATER VALVE
	PROPOSED HANDHOLE (SPECIAL)		EXISTING MAST ARM		FIRE HYDRANT MANHOLE
			EXISTING POWER POLE		WATER LINE
			EXISTING TRAFFIC SIGNAL		BUILDING LINE
					PAVEMENT MARKING

REVISIONS

NAME	DATE

ILLINOIS DEPARTMENT OF TRANSPORTATION

LAYOUT PLAN

CITY OF BLOOMINGTON
DOWNTOWN MAIN STREET BEAUTIFICATION
FRONT STREET TO WASHINGTON STREET

SCALE: VERT. _____
HORIZ. _____
DATE: 01-31-08

DRAWN BY: DVH
CHECKED BY: JCB

PLOT DATE = DATE#
PLOT SCALE = SCALE#
PLOT USER = USER#