

ROUTE NO.	SECTION	COUNTY	TOTAL SHEETS	SHEET NO.
C.H. 11	08-00022	PUTNAM	23	6
F.A.S. 254	-00-BR			

ILLINOIS
CONTRACT NO. 89434

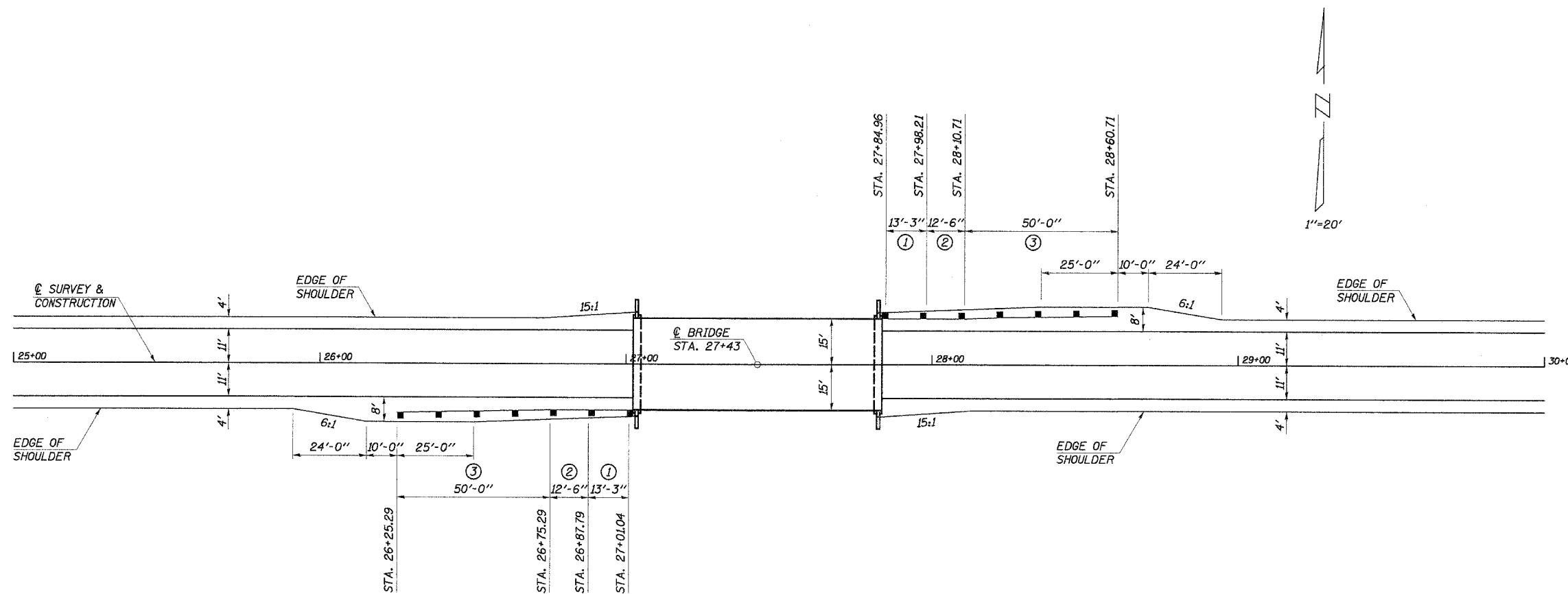

SHOULDER AND GUARDRAIL DETAIL

TRAFFIC BARRIER TERMINAL, TYPE 5A

15' RT. STA. 26+87.79 TO 15' RT. STA. 27+01.04 = 1 EACH
 15' LT. STA. 27+84.96 TO 15' LT. STA. 27+98.21 = 1 EACH
 TOTAL = 2 EACH

SEE STANDARD BLR 27

STEEL PLATE BEAM GUARD RAIL, TYPE A

15' RT. STA. 26+75.29 TO 15' RT. STA. 26+87.79 = 12.5 FOOT
 15' LT. STA. 27+98.21 TO 15' LT. STA. 28+10.71 = 12.5 FOOT
 TOTAL = 25.0 FOOT

SEE STANDARD BLR 26

TRAFFIC BARRIER TERMINAL, TYPE 1, SPECIAL (TANGENT)

16' RT. STA. 26+25.29 TO 15' RT. STA. 26+75.29 = 1 EACH
 15' LT. STA. 28+10.71 TO 16' LT. STA. 28+60.71 = 1 EACH
 TOTAL = 2 EACH

SEE HIGHWAY STANDARD 630301

LEGEND

NOTE: ALL DIMENSIONS REFER TO FRONT FACE OF PROPOSED RAILING

- ① TRAFFIC BARRIER TERMINAL, TYPE 5A
- ② STEEL PLATE BEAM GUARD RAIL, TYPE A
- ③ TRAFFIC BARRIER TERMINAL, TYPE 1, SPECIAL (TANGENT)

SHOULDER AND GUARDRAIL DETAIL

SECTION 08-00022-00-BR
 PUTNAM COUNTY
 COUNTY HIGHWAY 11
 STATION 27+43

4440 ASH GROVE
 SPRINGFIELD, IL 62711
 (217) 793-8800
 www.tehr-graham.com

FEHR-GRAHAM & ASSOCIATES, LLC
 ENGINEERING AND SCIENCE CONSULTANTS
REGISTERED PROFESSIONAL ENGINEERS AND SURVEYORS

DRAWN: S.A.P.
 DATE: 1/30/07

CHECKED: G.J.C.
 DATE: 2/2/07

JOB NO.: 46856
 FILE: 46856SHLDR.DGN
 DATE: 04/17/07