

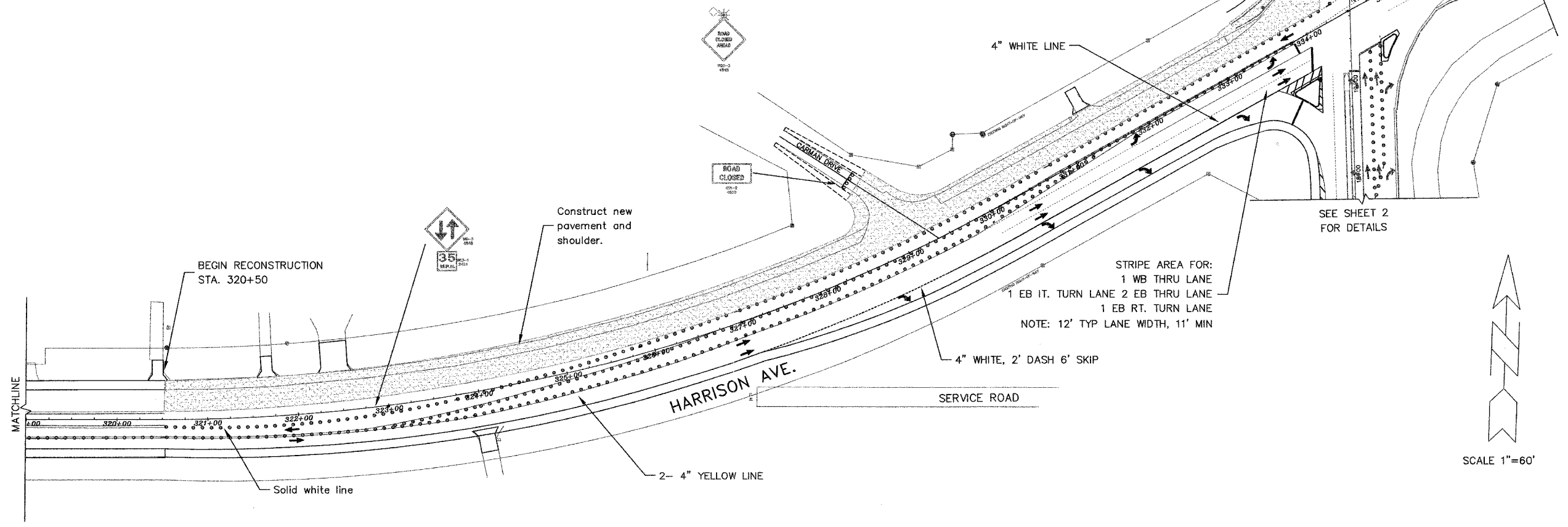

ROUTE	SECTION	SHEET
43	04-00355-00-RS	12 OF 43
HARRISON AVE & PERRYVILLE RD		

LEGEND

- PROP RECONSTRUCTION AREAS
- EXISTING CURB LINE
- PROPOSED CURB LINE
- TRAFFIC BARRICADES
- MEDIAN REMOVAL AREAS
- TEMPORARY PAVEMENT MARKING

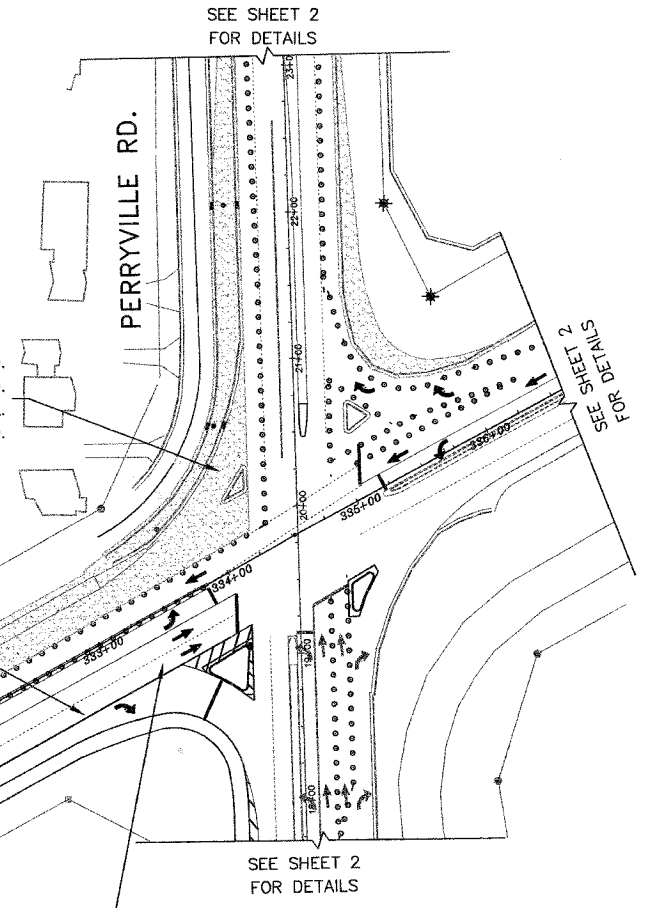
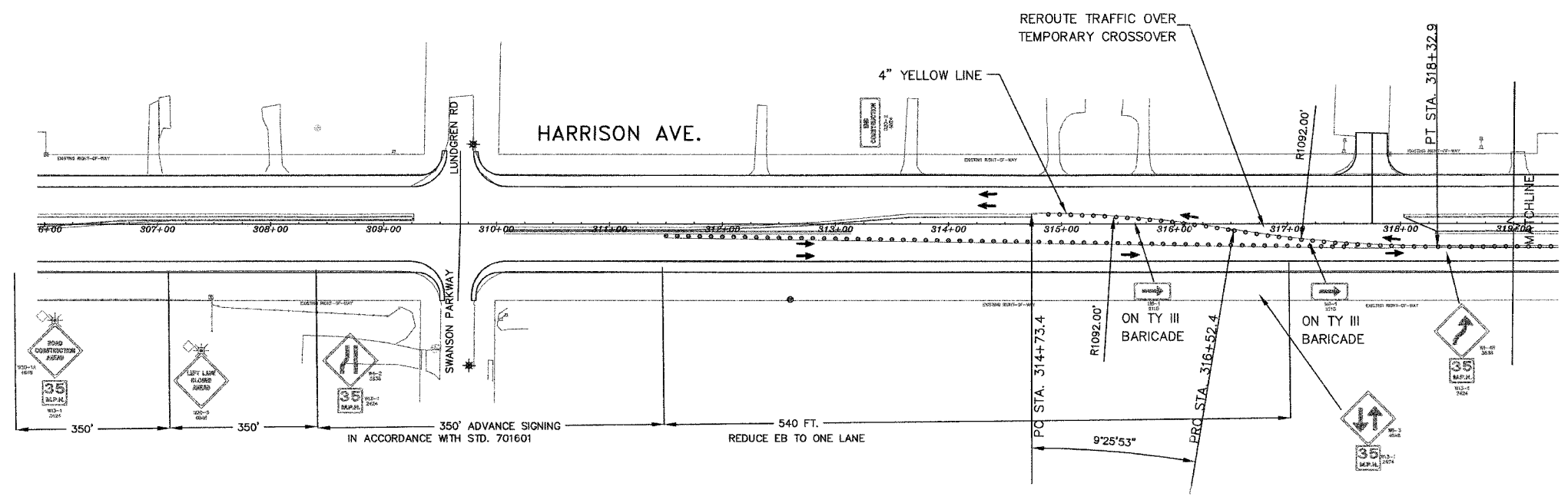

PHASING

1. PLACE SIGNING, FLAGGERS AND TRAFFIC CONTROL DEVICES PER STD. 701601, 701701, 701901, 701606 AND IDOT DIST II DETAIL # 94.2 (ALL TEMPORARY TRAFFIC CONTROL PLACEMENT BASED ON 45 MPH DESIGN)
2. CONSTRUCT NEW NW ISLAND AND RELOCATE TRAFFIC SIGNAL AND LIGHTING TO NEW ISLAND.
3. REMOVE EXISTING WB PAVEMENT AS INDICATED AND CONSTRUCT NEW PAVEMENT AND SHOULDERS. INCLUDE CARMAN DRIVE APPROACH. (CARMAN DRIVE WILL CONTINUE TO REMAIN CLOSED AFTER THIS STAGE)
4. CONSTRUCT NEW RIGHT TURN LANE ON NORTH LEG OF PERRYVILLE, INCLUDING NEW ISLAND.
5. WIDEN NB PERRYVILLE PAVEMENT AND CONSTRUCT ISLAND AS SHOWN.

\\hwf602\county\_shared\_folders\Highway Dept\Projects\04-00355-00-RS (Harrison & Perryville)Staging.dwg, 4/15/2008 12:53:01 PM, Doc: TC5400.pcs, WCHD, Joe Bluetek

