

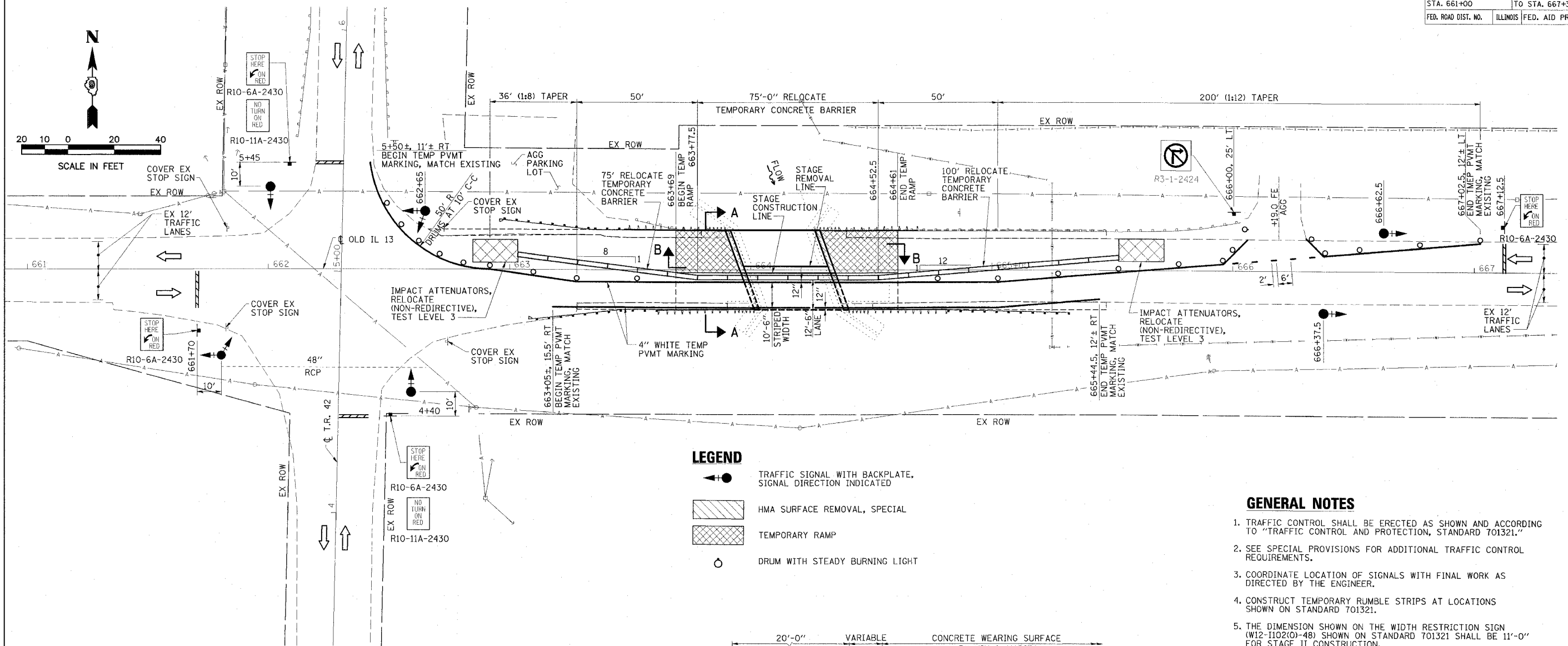

FAS RTE	SECTION	COUNTY	TOTAL SHEETS	SHEET NO.
899	BBR-1	SALINE	75	10
STA. 661+00		TO STA. 667+30		
FED. ROAD DIST. NO.		ILLINOIS FED. AID PROJECT		



LEGEND

- (with arrow) TRAFFIC SIGNAL WITH BACKPLATE, SIGNAL DIRECTION INDICATED
- ▨ (diagonal lines) HMA SURFACE REMOVAL, SPECIAL
- ▩ (cross-hatch) TEMPORARY RAMP
- DRUM WITH STEADY BURNING LIGHT

- GENERAL NOTES**
- TRAFFIC CONTROL SHALL BE ERECTED AS SHOWN AND ACCORDING TO "TRAFFIC CONTROL AND PROTECTION, STANDARD 701321."
 - SEE SPECIAL PROVISIONS FOR ADDITIONAL TRAFFIC CONTROL REQUIREMENTS.
 - COORDINATE LOCATION OF SIGNALS WITH FINAL WORK AS DIRECTED BY THE ENGINEER.
 - CONSTRUCT TEMPORARY RUMBLE STRIPS AT LOCATIONS SHOWN ON STANDARD 701321.
 - THE DIMENSION SHOWN ON THE WIDTH RESTRICTION SIGN (W12-1102(O)-48) SHOWN ON STANDARD 701321 SHALL BE 11'-0" FOR STAGE II CONSTRUCTION.
 - TRAFFIC CONTROL BEYOND THE STOP BARS ON THE T.R. 42 SHALL BE ERECTED AS SHOWN ON STANDARD 701321 FOR THE MAIN ROADWAY. THIS INCLUDES SIGNS, DETECTOR LOOPS, AND RUMBLE STRIPS. ADDITIONALLY, AN ADVANCE ARROW SIGN (W6-5) SHALL BE MOUNTED UNDER EACH WIDTH RESTRICTION SIGN ON T.R. 42. THE COST OF THIS WORK SHALL BE INCLUDED IN THE COST OF TRAFFIC CONTROL AND PROTECTION, STANDARD 701321 (SPECIAL).

SCHEDULE OF QUANTITIES

STATION	TO	STATION	FEET
663+02		665+52	250
			TOTAL - 250
IMPACT ATTENUATORS, RELOCATE (NON-REDIRECTIVE), TEST LEVEL 3 - 2 EACH			

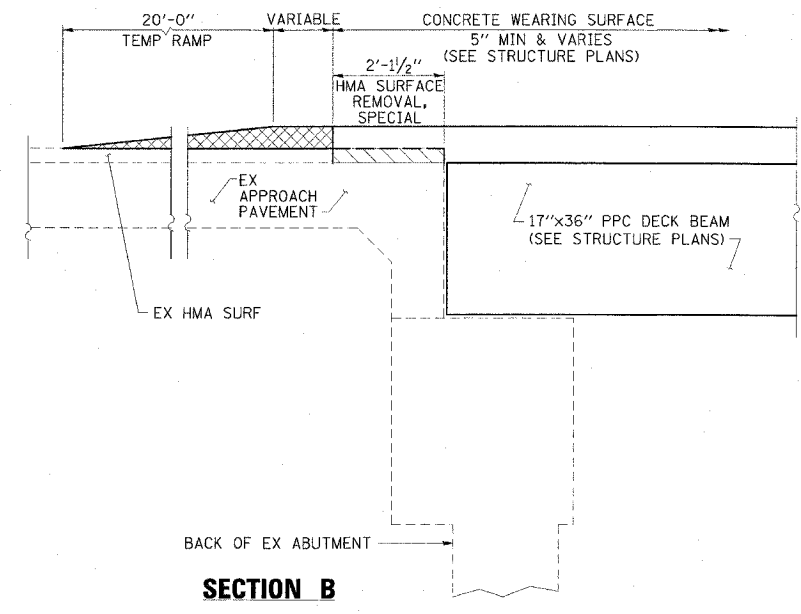
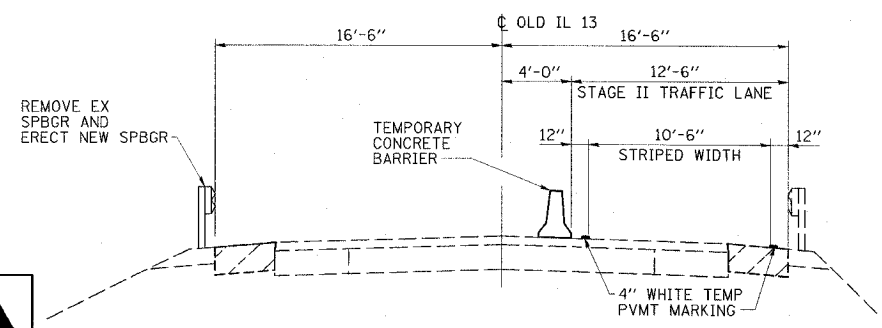

ESCA
CONSULTANTS, INC.

DESIGNED BY:	JMS	10/07
DRAWN BY:	CJ/HAS	10/07
CHECKED BY:	DAJ/MTD	01/08
APPROVED BY:	RDP	02/08

STAGE II CONSTRUCTION
FAS RTE 899 (OLD IL 13)
SECTION 8BR-1
SALINE COUNTY