

F.A.P. RTE.	SECTION	COUNTY	TOTAL SHEETS	SHEET NO.
304	5BR-2	CALHOUN	68	8
STA.		TO STA.		
FED. ROAD DIST. NO.		ILLINOIS FED. AID PROJECT		

ALL TIES MAG
NAILIN EOP

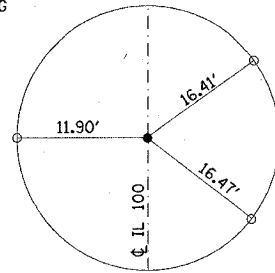

TIE POINT
PT STA 460+04.56
MAG NAIL (SET)

ALL TIES MAG
NAILIN EOP

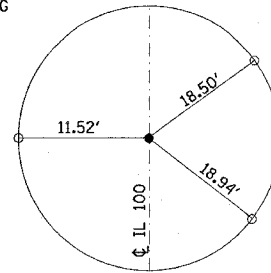

TIE POINT
PT STA 462+20.81
MAG NAIL (SET)

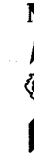

ALL TIES MAG
NAILIN EOP

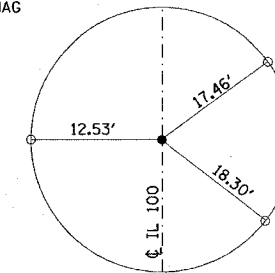

TIE POINT
PT STA 467+16.30
MAG NAIL (SET)

ALL TIES MAG
NAILIN EOP

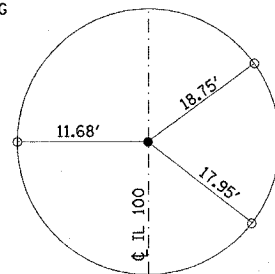

TIE POINT
PT STA 463+25.21
MAG NAIL (SET)

ALL TIES MAG
NAILIN EOP

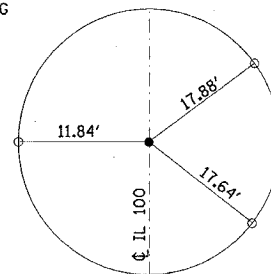

TIE POINT
PT STA 463+66.65
MAG NAIL (SET)

BENCHMARKS

BM 205 - RR SPIKE IN WEST SIDE OF GUY POLE ON EAST SIDE OF
RT 100 @ STA 493+50
ELEVATION = 435.89

BM 206 - CHISELED " " ON TOP OF THE NORTH END OF WEST
CONCRETE BRIDGE CURB FOR RTE 100 BRIDGE (SN
007-0004) OVER CRAWFORD CREEK
ELEVATION = 438.26

NOTE: ALL TIES PULLED DIRECT

REVISIONS		ILLINOIS DEPARTMENT OF TRANSPORTATION
NAME	DATE	
		TIES & BENCHMARKS FAP ROUTE 304 SECTION 5BR-2 CALHOUN COUNTY SCALE: VERT. _____ HORIZ. _____ DATE _____
DRAWN BY _____		CHECKED BY _____

PLOT DATE = 1/18/2008
 FILE NAME = c:\projects\76948\planning\76948.dgn
 PLOT SCALE = 50,000 / IN.
 REFERENCE = REF