

F.A.P. RITE.	SECTION	COUNTY	TOTAL SHEETS	SHEET NO.
776	(01)RS-1	WAYNE	21	6
STA.	TO STA.			
FED. ROAD DIST. NO.	ILLINOIS	FED. AID PROJECT		

PAVING SCHEDULE

STATION TO STATION		LENGTH	EXISTING PAVEMENT WIDTH	AREA	BITUMINOUS MATERIALS (PRIME COAT)	AGGREGATE (PRIME COAT)	BITUMINOUS SURFACE COURSE, SUPERPAVE, MIX "C", N70, 1 1/2"	LEVELING BINDER, MACHINE METHOD SUPERPAVE, N70, 3/4"	HOT MIX ASPHALT SURFACE REMOVAL - BUTT JOINT	HOT MIX ASPHALT SURFACE REMOVAL - 1 1/2"	HOT MIX ASPHALT SURFACE REMOVAL (VARIABLE DEPTH)	AGGREGATE SHOULDERS, TYPE B	TEMPORARY RAMP
		LIN FT	FEET	SQ YD	GALLON	TON	TON	TON	SQ YD	SQ YD	SQ YD	TON	SQ YD
1+00.00 TO 13+72.00	13+72.00	1,272.0	40.0	5,653.3	565.3	11.3	474.9			100	5,553.3		22.2
13+72.00 TO 14+02.00	14+02.00	30.0	26.0	86.7	8.7	0.2	7.3				86.7	2.4	
14+02.00 TO 29+53.00	29+53.00	1,551.0	26.0	4,480.7	448.1	9.0	376.4				4,480.7	125.4	
29+53.00 TO 29+83.00	29+83.00	30.0	26.0	86.7	8.7	0.2	7.3				86.7	2.4	
29+83.00 TO 30+83.00	30+83.00	100.0	26.0	288.9	28.9	0.6	24.3			288.9		8.1	
30+83.00 TO 31+13.00	31+13.00	30.0	26.0	86.7	8.7	0.2	7.3				86.7	2.4	
31+13.00 TO 65+10.00	65+10.00	3,397.0	26.0	9,813.6	981.4	19.6	824.3				9,813.6	274.7	14.4
65+10.00 TO 65+40.00	65+40.00	30.0	26.0	86.7	8.7	0.2	7.3				86.7	2.4	
65+40.00 TO 69+76.00	69+76.00	436.0	26.0	1,259.6	126.0	2.5	105.8			1259.6		35.3	14.4
69+76.00 TO 70+06.00	70+06.00	30.0	26.0	86.7	8.7	0.2	7.3				86.7	2.4	
70+06.00 TO 141+75.50	141+75.50	7,169.5	26.0	20,711.9	2,071.2	41.4	1739.8				20,711.9	579.7	
141+75.50 TO 142+05.50	142+05.50	30.0	26.0	86.7	8.7	0.2	7.3	87				2.4	
142+05.50 TO 143+94.50	143+94.50	189.0											
143+94.50 TO 144+24.50	144+24.50	30.0	26.0	86.7	8.7	0.2	7.3	87				2.4	
144+24.50 TO 158+30.00	158+30.00	1,405.5	26.0	4,060.3	406.0	8.1	341.1				4,060.3	113.7	
158+30.00 TO 158+60.00	158+60.00	30.0	26.0	86.7	8.7	0.2	7.3				86.7	2.4	
158+60.00 TO 159+60.00	159+60.00	100.0	26.0	288.9	28.9	0.6	24.3			288.9		8.1	
159+60.00 TO 159+90.00	159+90.00	30.0	26.0	86.7	8.7	0.2	7.3				86.7	2.4	
159+90.00 TO 180+50.70	180+50.70	2,060.7	26.0	5,953.1	595.3	11.9	500.1				5,953.1	166.6	
180+50.70 = 181+08.90	181+08.90												
181+08.90 TO 203+72.50	203+72.50	2,263.6	26.0	6,539.3	653.9	13.1	549.3				6,539.3	183.0	
203+72.50 TO 204+02.50	204+02.50	30.0	26.0	86.7	8.7	0.2	7.3				86.7	2.4	
204+02.50 TO 204+52.50	204+52.50	50.0	26.0	144.4	14.4	0.3	12.1			144.4		4.0	
204+52.50 TO 204+83.50	204+83.50	31.0	26.0	89.6	9.0	0.2	7.5			89.6		2.4	
204+83.50 TO 205+33.50	205+33.50	50.0	26.0	144.4	14.4	0.3	12.1			144.4		4.0	
205+33.50 TO 205+63.50	205+63.50	30.0	26.0	86.7	8.7	0.2	7.3				86.7	2.4	
205+63.50 TO 210+61.00	210+61.00	497.5	26.0	1,437.2	143.7	2.9	120.7				1,437.2	40.2	14.4
210+61.00 TO 210+91.00	210+91.00	30.0	26.0	86.7	8.7	0.2	7.3				86.7	2.4	
210+91.00 TO 211+91.00	211+91.00	100.0	26.0	288.9	28.9	0.6	24.3			288.9		8.1	
211+91.00 TO 212+21.00	212+21.00	30.0	26.0	86.7	8.7	0.2	7.3				86.7	2.4	
212+21.00 TO 256+41.00	256+41.00	4,420.0	26.0	12,768.9	1,276.9	25.5	1072.6				12,768.9	357.4	
256+41.00 TO 256+71.00	256+71.00	30.0	26.0	86.7	8.7	0.2	7.3				86.7	2.4	
256+71.00 TO 257+71.00	257+71.00	100.0	26.0	288.9	28.9	0.6	24.3			288.9		8.1	
257+71.00 TO 258+01.00	258+01.00	30.0	26.0	86.7	8.7	0.2	7.3				86.7	2.4	
258+01.00 TO 284+86.00	284+86.00	2,685.0	26.0	7,756.7	775.7	15.5	651.6				7,756.7	217.1	
284+86.00 TO 285+16.00	285+16.00	30.0	26.0	86.7	8.7	0.2	7.3				86.7	2.4	
285+16.00 TO 286+16.00	286+16.00	100.0	26.0	288.9	28.9	0.6	24.3			288.9		8.1	
286+16.00 TO 286+46.00	286+46.00	30.0	26.0	86.7	8.7	0.2	7.3				86.7	2.4	
286+46.00 TO 321+10.00	321+10.00	3,464.0	26.0	10,007.1	1,000.7	20.0	840.6				10,007.1	280.1	
321+10.00 TO 321+40.00	321+40.00	30.0	26.0	86.7	8.7	0.2	7.3				86.7	2.4	
321+40.00 TO 322+40.00	322+40.00	100.0	26.0	288.9	28.9	0.6	24.3			288.9		8.1	
322+40.00 TO 322+70.00	322+70.00	30.0	26.0	86.7	8.7	0.2	7.3				86.7	2.4	
322+70.00 TO 325+92.00	325+92.00	322.0	26.0	930.2	93.0	1.9	78.1				930.2	26.0	
325+92.00 TO 326+22.00	326+22.00	30.0	26.0	86.7	8.7	0.2	7.3	86.7				2.4	
PROJECT TOTALS		32,464		95,217	9,522	190	7,998		360	3371	91486	2504	65
ADJUSTED TOTALS												2355	

PAVEMENT MARKING SCHEDULE

STATION TO STATION	LENGTH	SHORT TERM PAVEMENT MARKING	WORK ZONE PAVEMENT MARKING REMOVAL	PAINT PAVEMENT MARKING - LINE 4"	RAISED REFLECTIVE PAVEMENT MARKER	TEMPORARY PAINT PAVEMENT MARKING LINE 4"	PAINT PAVEMENT MARKING - LINE 6"	TEMPORARY PAINT PAVEMENT MARKING - LINE 6"	TEMPORARY PAVEMENT MARKING - LETTERS & SYMBOLS	PAINT PAVEMENT MARKING - LETTERS & SYMBOLS
	FEET	FT.	SQ. FT.	FT.	EACH	FT.	FT.	FT.	SQ. FT.	SQ. FT.
1+00.00 TO 13+72.00	1,272.0	381.6	42.4	318.0	16	318.0	0	0	0	0
13+72.00 TO 142+05.50	12,833.5	3,850.1	427.8	28,682.4	160	28,682.4	0	0	0	0
142+05.50 TO 143+94.50	BRIDGE			425.3	2					
143+94.50 TO 180+50.70	3,656.2	1,096.9	121.9	7,986.5	46	7,986.5	0	0	0	0
180+50.70 = 181+08.90	STATION EQUATION									
181+08.90 TO 326+22.00	14,513.1	4,353.9	483.8	38,229.0	181	38,229.0				
DOWNTOWN PARKING LANES				544						
PROJECT TOTALS	32,275	9,683	1,076	76,185	406	75,216	0	0	0	0

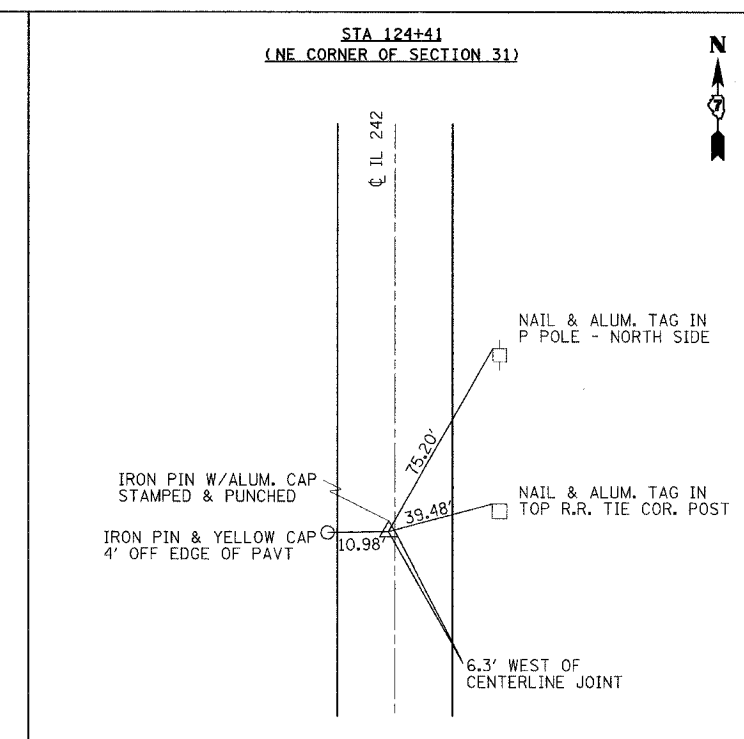
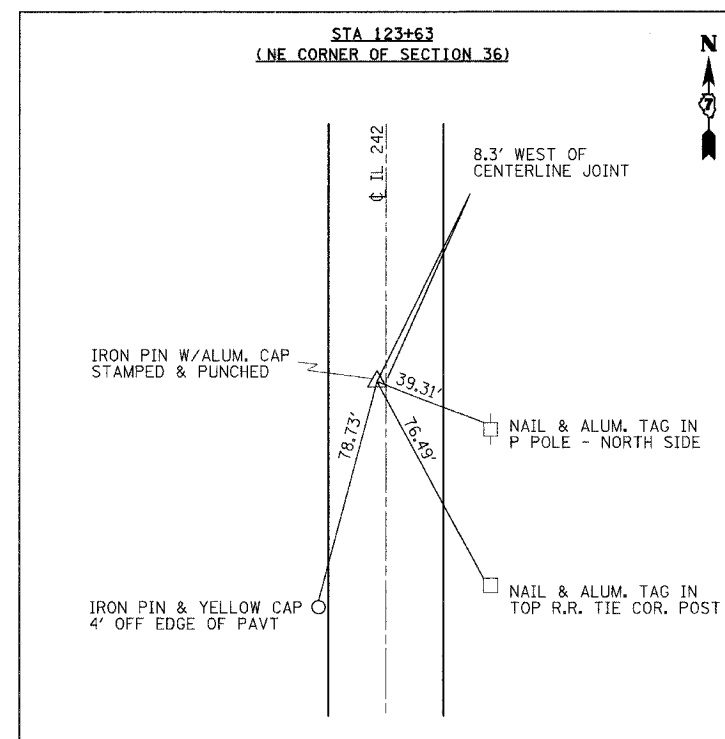

PATCHING SCHEDULE

DIRECTION	TYPE II SQ YD	TYPE III SQ YD	TYPE IV SQ YD
NBL	113.0	49.0	26.0
SBL	29.3	0.0	0.0
TOTAL	142.3	49.0	26.0

REVISIONS	
NAME	DATE

ILLINOIS DEPARTMENT OF TRANSPORTATION

SCHEDULES & TIES

SCALE: VERT. HORIZ. DATE

DRAWN BY CHECKED BY