

STATE OF ILLINOIS
DEPARTMENT OF TRANSPORTATION
DIVISION OF HIGHWAYS

F.A.P. RTE.	SECTION	COUNTY	TOTAL SHEETS	SHEET NO.
717	*	LOGAN	12	1
FED. ROAD DIST. NO.		ILLINOIS CONTRACT NO. 72B94		

*D-6 SHLDR RUMBLE STRIPS 2008-5

D-96-059-08



LOCATION OF SECTION INDICATED THUS: - ■ -

PROPOSED
HIGHWAY PLANS

FAP ROUTE 717 (IL 10)
SECTION D-6 SHLDR RUMBLE STRIPS 2008-5
PROJECT : ACHSIP-0717(030)
LOGAN COUNTY
C-96-059-08

FOR INDEX OF SHEETS, SEE SHEET NO. 2

HIGHWAY CLASSIFICATION

F.A.P. Route 717 (IL 10)
 MINOR ARTERIAL

A.D.T. - 1,600 (2008)	PV = 90.70%
A.D.T. - 1,900 (2028)	SU = 1.50%
DESIGN SPEED - 55 mph	MU = 7.80%
POSTED SPEED - 55 mph	

SECTION D-6 SHLDR RUMBLE STRIPS 2008-5
 BEGINS AT STA. 303+00.00

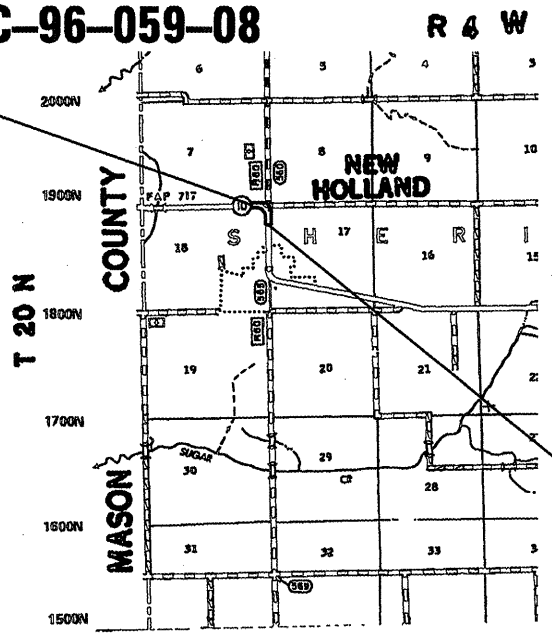

SECTION D-6 SHLDR RUMBLE STRIPS 2008-5
 ENDS AT STA. 315+00.00

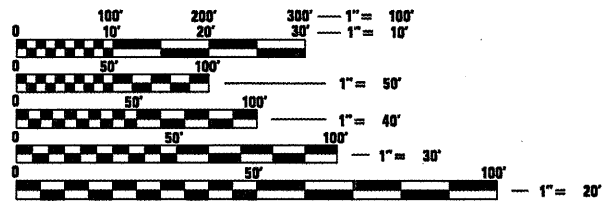

FULL SIZE PLANS HAVE BEEN PREPARED USING STANDARD ENGINEERING SCALES. REDUCED SIZED PLANS WILL NOT CONFORM TO STANDARD SCALES. IN MAKING MEASUREMENTS ON REDUCED PLANS, THE ABOVE SCALES MAY BE USED.

J.U.L.I.E.
 JOINT UTILITY LOCATION INFORMATION FOR EXCAVATION
 1-800-892-0123
 OR 811

PROJECT ENGINEER: SAL MADONIA (217) 782-4761
SQUAD LEADER: RENE CABRERA (217) 557-9062
TECHNICIAN: JONATHAN COX
CONTRACT NO. 72B94

LOCATION MAP

GROSS LENGTH = 1,200 ft. = 0.23 mi.
 NET LENGTH = 1,200 ft. = 0.23 mi.

STATE OF ILLINOIS
 DEPARTMENT OF TRANSPORTATION
 DIVISION OF HIGHWAYS

SUBMITTED MAR. 13, 2008
Christina M. Reed
 DEPUTY DIRECTOR OF HIGHWAYS, REGION ENGINEER

May 9, 2008
Eric E. Horn
 ENGINEER OF DESIGN AND ENVIRONMENT

May 9, 2008
Christina M. Reed
 DIRECTOR OF HIGHWAYS, CHIEF ENGINEER

PRINTED BY THE AUTHORITY
OF THE STATE OF ILLINOIS