

STATE OF ILLINOIS  
DEPARTMENT OF TRANSPORTATION  
DIVISION OF HIGHWAYS

# PROPOSED HIGHWAY PLANS

F.A.P. ROUTE 326 (IL 47)  
SECTION 2008 BEAM BRACING (SN 010-0055)  
CHAMPAIGN COUNTY  
C-95-007-08  
BEAM BRACING  
SANGAMON RIVER SW OF MAHOMET

F.A.P. RTE.	SECTION	COUNTY	TOTAL SHEETS	SHEET NO.
326		CHAMPAIGN	5	1
FED. ROAD DIST. NO.	ILLINOIS	CONTRACT NO. 70720		

\* 2008 BEAM BRACING (SN 010-0055)

D-95-007-08

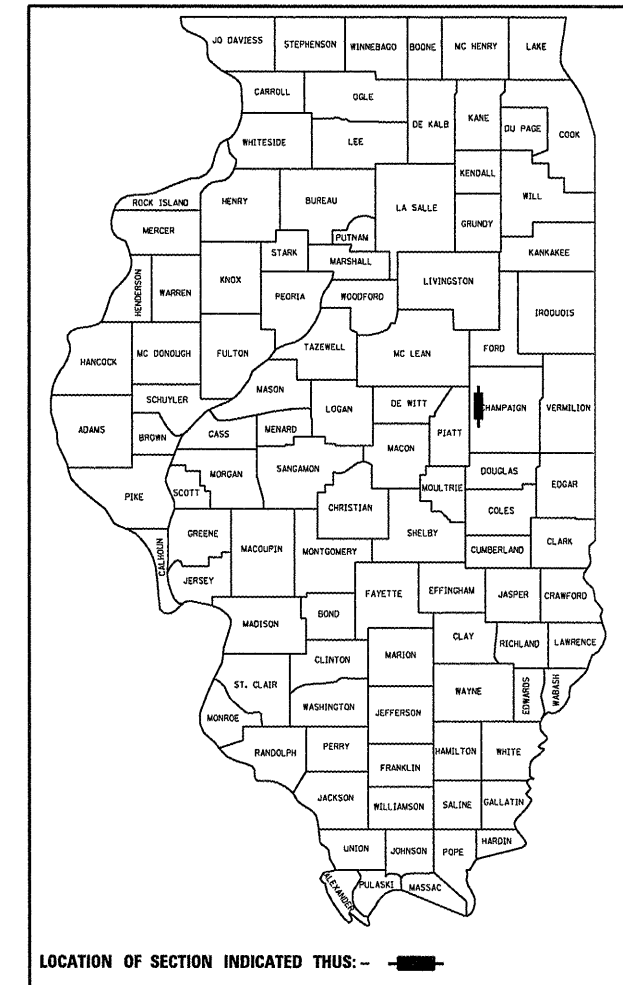

FOR INDEX OF SHEETS, SEE SHEET NO. 2  
FOR SUMMARY OF QUANTITIES, SEE SHEET NO. 3

**CURRENT ADT**

5,000 (2007)

**DESIGN DESIGNATION**

N/A

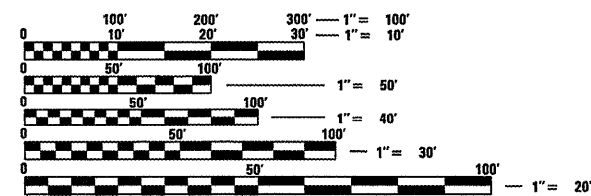

FULL SIZE PLANS HAVE BEEN PREPARED USING STANDARD ENGINEERING SCALES. REDUCED SIZED PLANS WILL NOT CONFORM TO STANDARD SCALES. IN MAKING MEASUREMENTS ON REDUCED PLANS, THE ABOVE SCALES MAY BE USED.

J.U.L.I.E.  
JOINT UTILITY LOCATION INFORMATION FOR EXCAVATION  
1-800-892-0123  
OR 811

PROJECT ENGINEER: NANCY FASIG (217)465-4181  
SQUAD LEADER: CORY SHEEHY (217)465-4181

CONTRACT NO. 70720

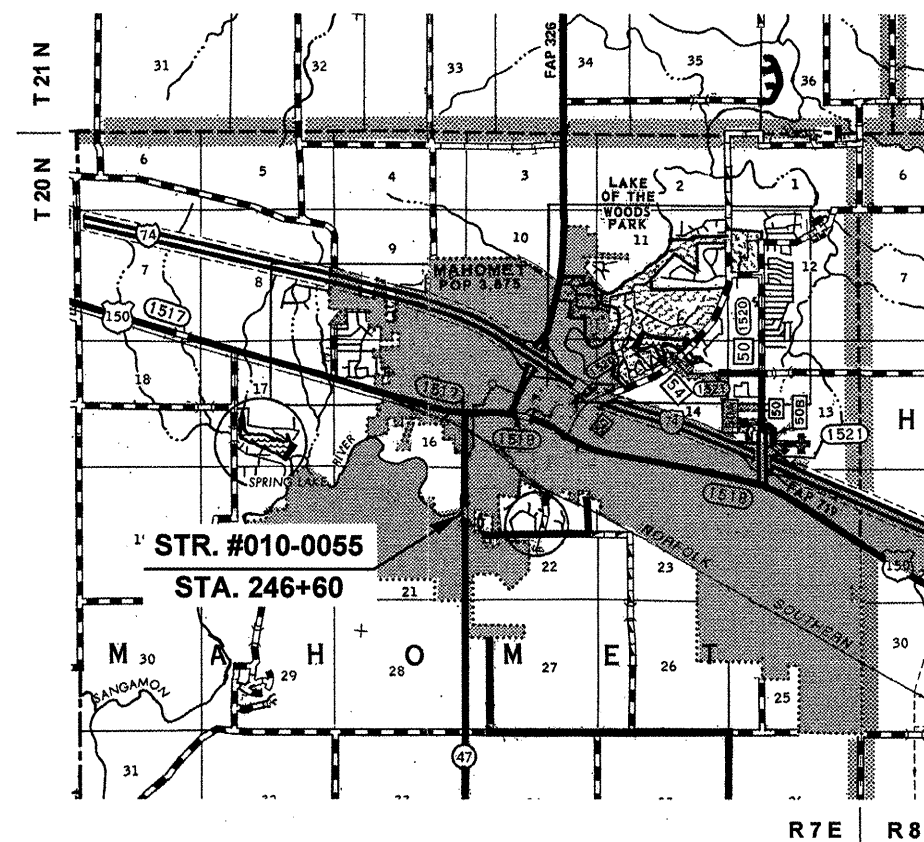

TOTAL LENGTH OF SECTION & PROJECT = 361.7 FEET = 0.069 MILES  
NET LENGTH OF SECTION & PROJECT = 361.7 FEET = 0.069 MILES

STATE OF ILLINOIS  
DEPARTMENT OF TRANSPORTATION  
DIVISION OF HIGHWAYS

SUBMITTED 3/16 20 08  
Joseph W. Crowley  
DEPUTY DIRECTOR OF HIGHWAYS, REGION 3 ENGINEER

May 9, 20 08  
Eric Estern  
INTERIM ENGINEER OF DESIGN AND ENVIRONMENT

May 9, 20 08  
Christine M. Reed  
DIRECTOR OF HIGHWAYS, CHIEF ENGINEER

**PRINTED BY THE AUTHORITY  
OF THE STATE OF ILLINOIS**