

SEC. 1, T 13 N, R 12 W, 2ND PM

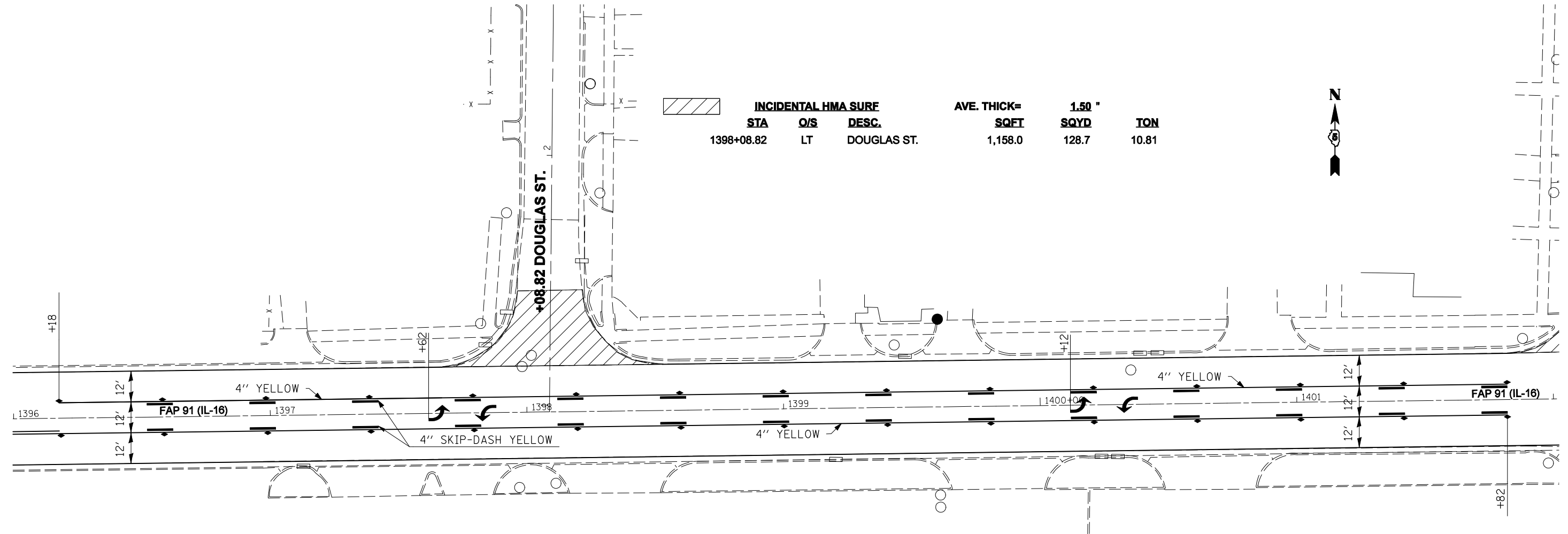

INCIDENTAL HMA SURF			AVE. THICK=	1.50 "	
STA	O/S	DESC.	SQFT	SQYD	TON
1398+08.82	LT	DOUGLAS ST.	1,158.0	128.7	10.81



SEC. 12, T 13 N, R 12 W, 2ND PM

FILE NAME =	USER NAME = sheehyom	DESIGNED -	REVISED -	<b>STATE OF ILLINOIS DEPARTMENT OF TRANSPORTATION</b>	<b>PLAN SHEET PAVING COLD MILLING IL-133 TO LOWER-T IN PARIS</b>	F.A.P. RTE.	SECTION	COUNTY	TOTAL SHEETS	SHEET NO.
ct:\projects\d500807 (v8)\70638tr\pimg.dgn	DRAWN -	REVISED -	91			• 1 RS-4 & 101 RS-6	EDGAR	35	22	
PLOT SCALE = 40.0000 ' / IN.	CHECKED -	REVISED -	CONTRACT NO. 70638							
PLOT DATE = 3/26/2008	DATE -	REVISED -	ILLINOIS FED. AID PROJECT							
				SCALE:	SHEET NO. OF SHEETS	STA.	TO STA.			