

F.A.I. RTE.	SECTION	COUNTY	TOTAL SHEETS	SHEET NO.
74	(20-1)RS-2	DEWITT	97	32
STA. 665+00		TO STA. 680+00		
FED. ROAD DIST. NO.	ILLINOIS	FED. AID PROJECT		

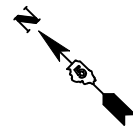

SEE DETAIL FOR MILLING TRANSITION  
AT REST AREA RAMPS, 2 1/4" - 3 3/4"  
SHEET 57 OF 97

SEE DETAIL FOR HMA  
SURFACE REMOVAL-BUTT JOINT  
AT REST AREA RAMPS  
SHEET 57 OF 97

- HOT-MIX ASPHALT SURFACE  
REMOVAL-BUTT JOINT
- MILLING TRANSITION AREA  
3 3/4" - 2 1/4"

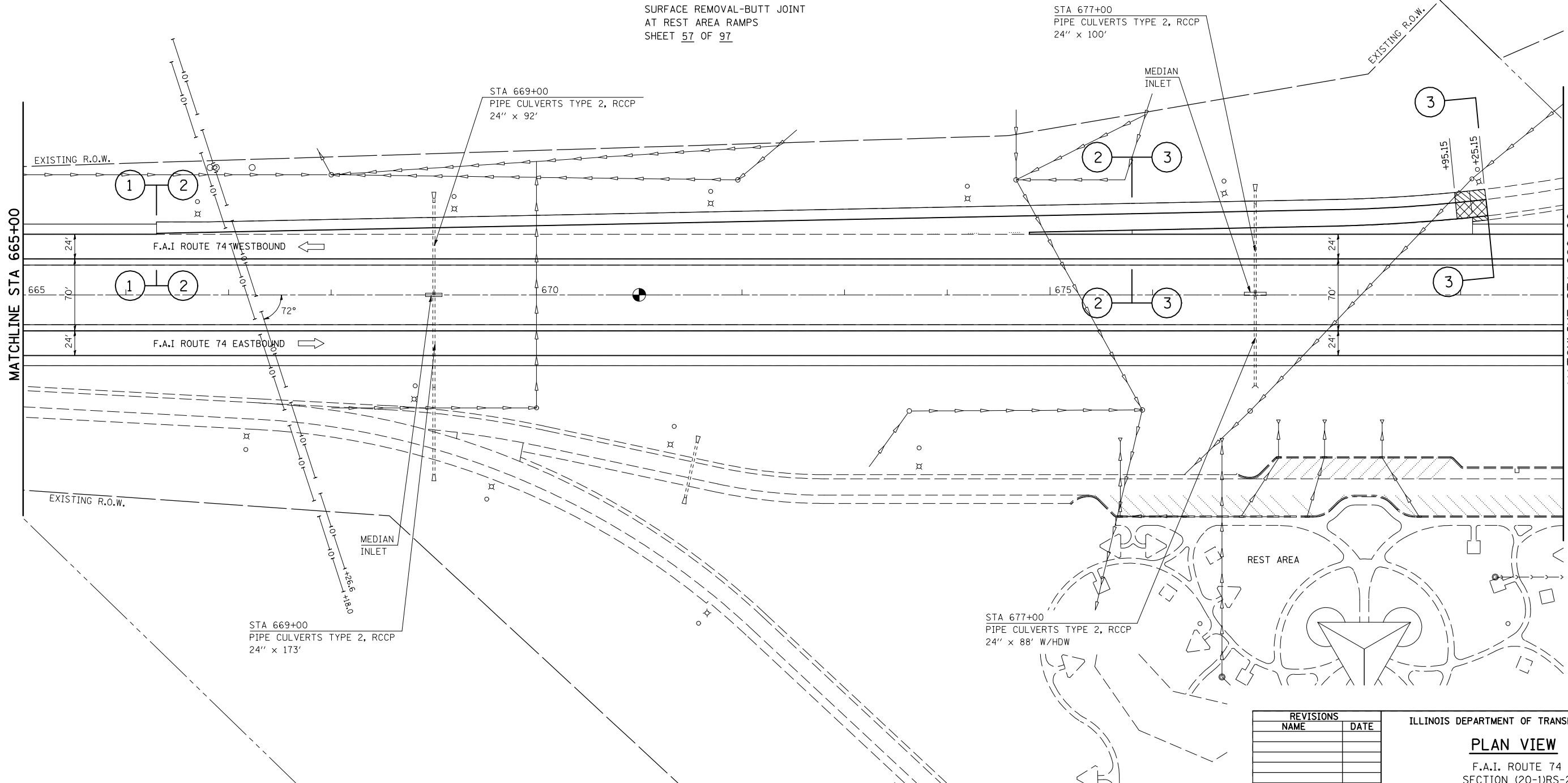

PLOT DATE = 3/28/2008  
FILE NAME = c:\projects\4582285 (v8)\reference\70475.dgn  
PLOT SCALE = 1/85,8824 / IN.  
USER NAME = collierb

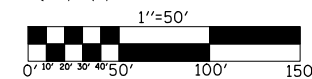

REVISIONS	
NAME	DATE

ILLINOIS DEPARTMENT OF TRANSPORTATION

**PLAN VIEW**

F.A.I. ROUTE 74  
SECTION (20-1)RS-2  
DEWITT COUNTY

SCALE: VERT. 1"=50'  
HORIZ. 1"=50'  
DATE: 06/24/05

DRAWN BY: JRP  
CHECKED BY: