

F.A.I. RTE.	SECTION	COUNTY	TOTAL SHEETS	SHEET NO.
74	(20-1)RS-2	DEWITT	97	30
STA. 635+00		TO STA. 650+00		
FED. ROAD DIST. NO.	ILLINOIS	FED. AID PROJECT		

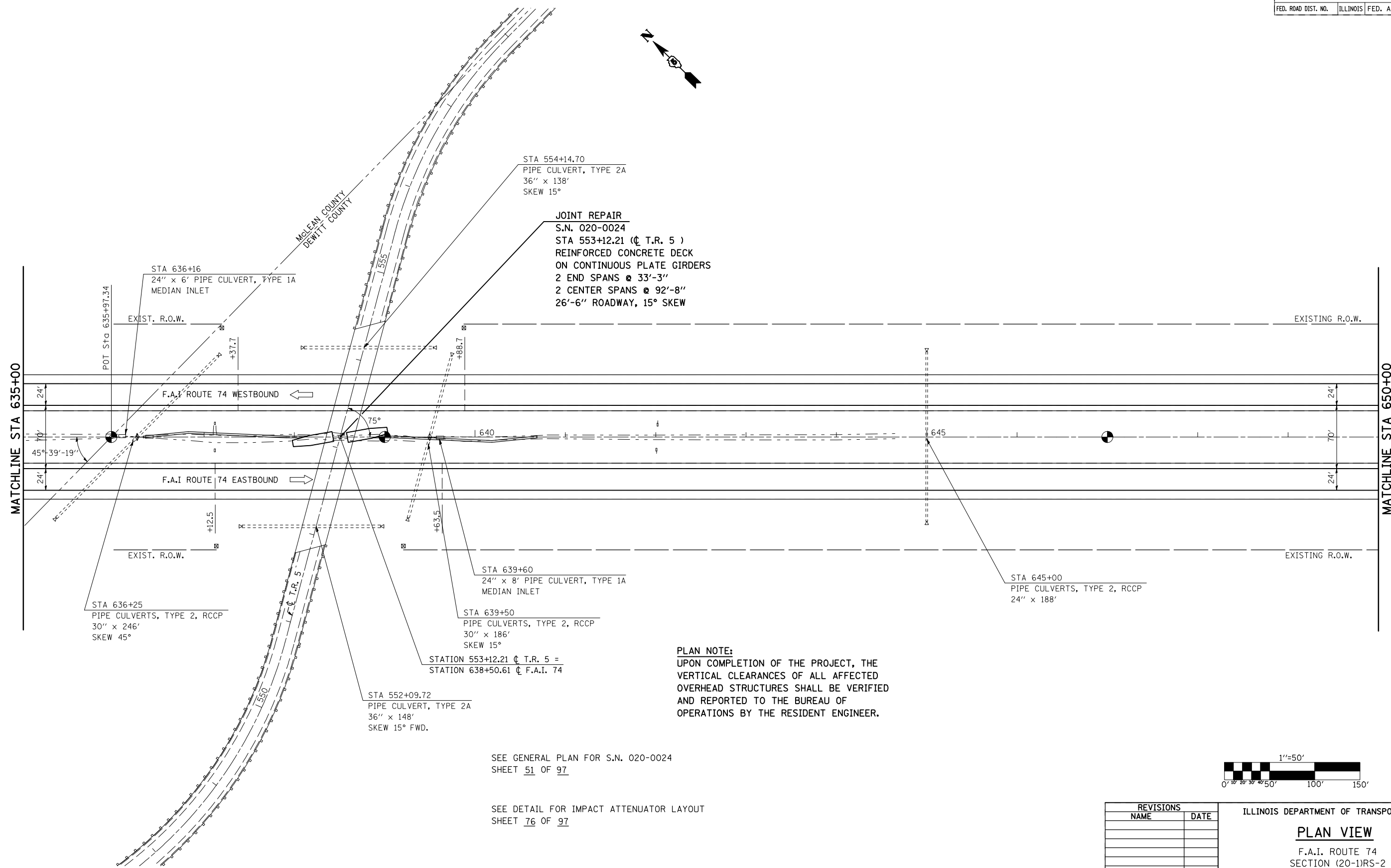

JOINT REPAIR
 S.N. 020-0024
 STA 553+12.21 (C T.R. 5)
 REINFORCED CONCRETE DECK
 ON CONTINUOUS PLATE GIRDERS
 2 END SPANS @ 33'-3"
 2 CENTER SPANS @ 92'-8"
 26'-6" ROADWAY, 15° SKEW

PLAN NOTE:
 UPON COMPLETION OF THE PROJECT, THE
 VERTICAL CLEARANCES OF ALL AFFECTED
 OVERHEAD STRUCTURES SHALL BE VERIFIED
 AND REPORTED TO THE BUREAU OF
 OPERATIONS BY THE RESIDENT ENGINEER.

SEE GENERAL PLAN FOR S.N. 020-0024
 SHEET 51 OF 97

SEE DETAIL FOR IMPACT ATTENUATOR LAYOUT
 SHEET 76 OF 97

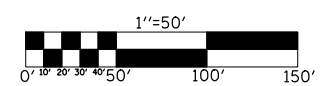

REVISIONS	
NAME	DATE

ILLINOIS DEPARTMENT OF TRANSPORTATION

PLAN VIEW

F.A.I. ROUTE 74
 SECTION (20-1)RS-2
 DEWITT COUNTY

SCALE: VERT. 1"=50'
 HORIZ. 1"=50'
 DATE: 06/24/05

DRAWN BY: JRP
 CHECKED BY:

PLOT DATE = 3/28/2008
 FILE NAME = c:\projects\4592295 (v8)\reference\70475.dgn
 PLOT SCALE = 1/8"=50' / IN.
 USER NAME = collierb