

Benchmark: Centerline Rdwy. at Bk. N. Abutment, Sta. 664+54.75, Elev. 548.20
 Existing Structure: Built as SBI Route 121 - Sec. 108 B & C in 1932 Sta. 667+55
 SBI Route 121 - Sec. 108 B-I in 1970 Sta. 667+55
 FAI-155 (Frontage Road) Sec. 108 C-1 in 1993 Sta. 667+55
 SBI Route 121 - Sec. 108 B-I in 1998 Sta. 667+55.

Proposed Improvement: Existing P.P.C. Deck Beams are to be removed and replaced and the substructure repaired. The road will be closed to traffic during construction.

STATE OF ILLINOIS
 DEPARTMENT OF TRANSPORTATION

ROUTE NO.	SECTION	COUNTY	DATE	SHEET	SHEET NO.
F.A.P. 744	108B-I-2	TAZEWELL	29	8	20 SHEETS
FED. ROAD DIST. NO. 7	ILLINOIS	FED. AID PROJECT			

Contract # 68485

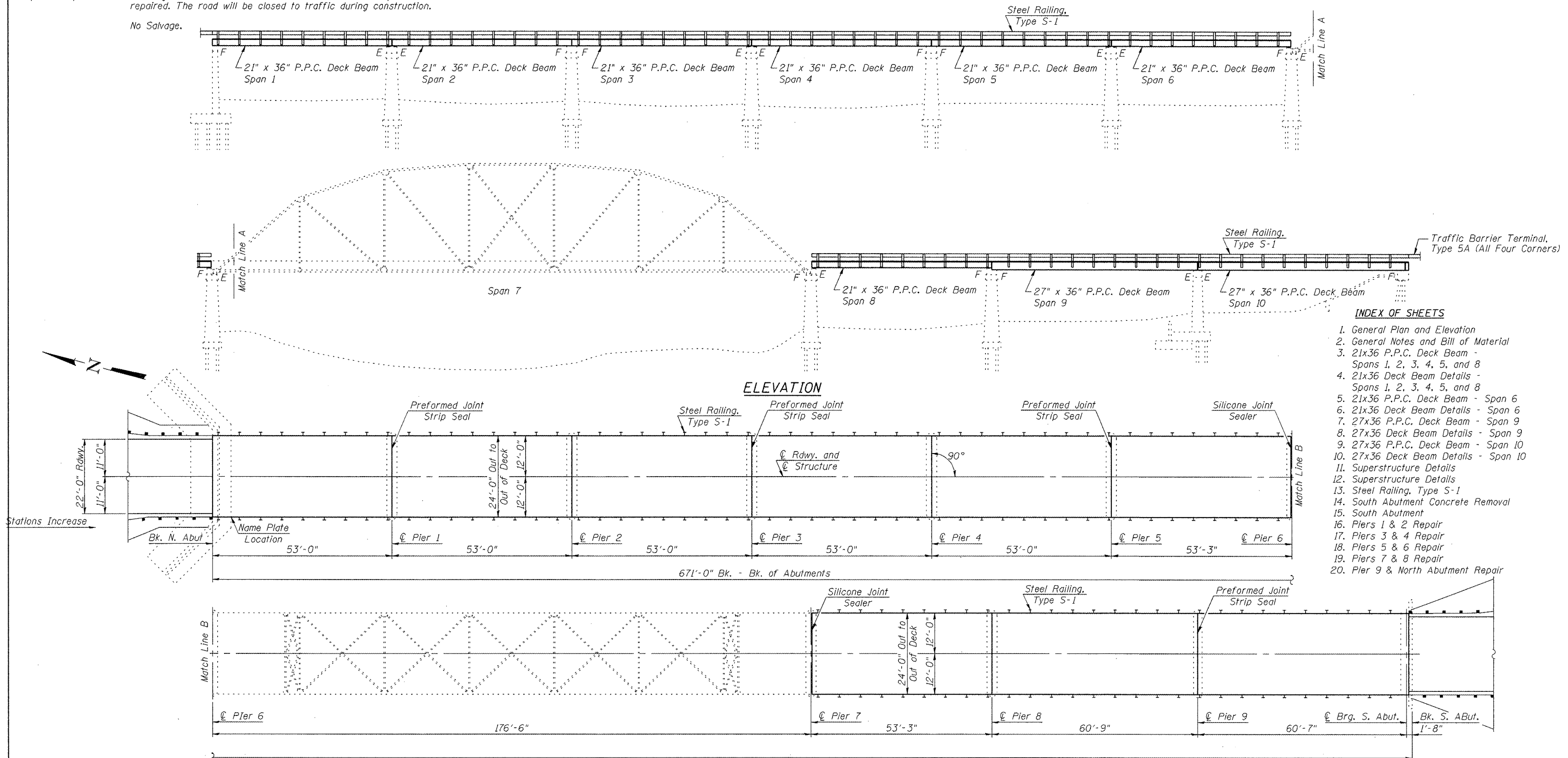

- INDEX OF SHEETS**
1. General Plan and Elevation
 2. General Notes and Bill of Material
 3. 21x36 P.P.C. Deck Beam - Spans 1, 2, 3, 4, 5, and 8
 4. 21x36 Deck Beam Details - Spans 1, 2, 3, 4, 5, and 8
 5. 21x36 P.P.C. Deck Beam - Span 6
 6. 21x36 Deck Beam Details - Span 6
 7. 27x36 P.P.C. Deck Beam - Span 9
 8. 27x36 Deck Beam Details - Span 9
 9. 27x36 P.P.C. Deck Beam - Span 10
 10. 27x36 Deck Beam Details - Span 10
 11. Superstructure Details
 12. Superstructure Details
 13. Steel Railing, Type S-1
 14. South Abutment Concrete Removal
 15. South Abutment
 16. Piers 1 & 2 Repair
 17. Piers 3 & 4 Repair
 18. Piers 5 & 6 Repair
 19. Piers 7 & 8 Repair
 20. Pier 9 & North Abutment Repair

DESIGNED -	200
CHECKED -	EXAMINED
DRAWN -	PASSED
CHECKED -	ENGINEER OF BRIDGES AND STRUCTURES

APPROVED
 For Structural Adequacy Only
Ralph E. Anderson
 Engineer of Bridges & Structures



PLAN

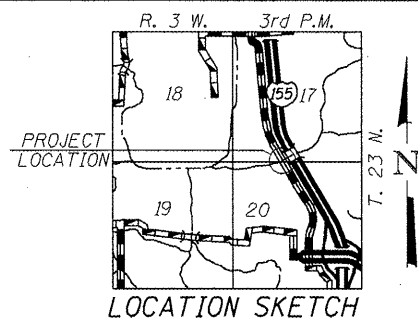

STA. 667+55.00
 REBUILT 20 BY
 STATE OF ILLINOIS
 F.A.S. Route 477 SEC. 108B-I-2
 LOADING HL-93
 STRUCTURE NO. 090-0087

NAME PLATE
 See Std. 515001

Attach new name plate to back side of 12" rail element. Existing Name Plate shall be removed, cleaned, and relocated adjacent to new Name Plate. Cost included with Name Plates

GENERAL PLAN AND ELEVATION
F.A.S. ROUTE 744 (OLD IL 121)
OVER MACKINAW RIVER
SECTION 108B-I-2
TAZEWELL COUNTY
STATION 667+55.00
STRUCTURE NO. 090-0087