

ROUTE NO.	SECTION	COUNTY	TOTAL SHEETS	SHEET NO.
VAR	*	VAR	66	52
FED. ROAD DIST. NO. 4		ILLINOIS	FED. AID PROJECT	

**\* D4 SCOUR MITIGATION 2006**

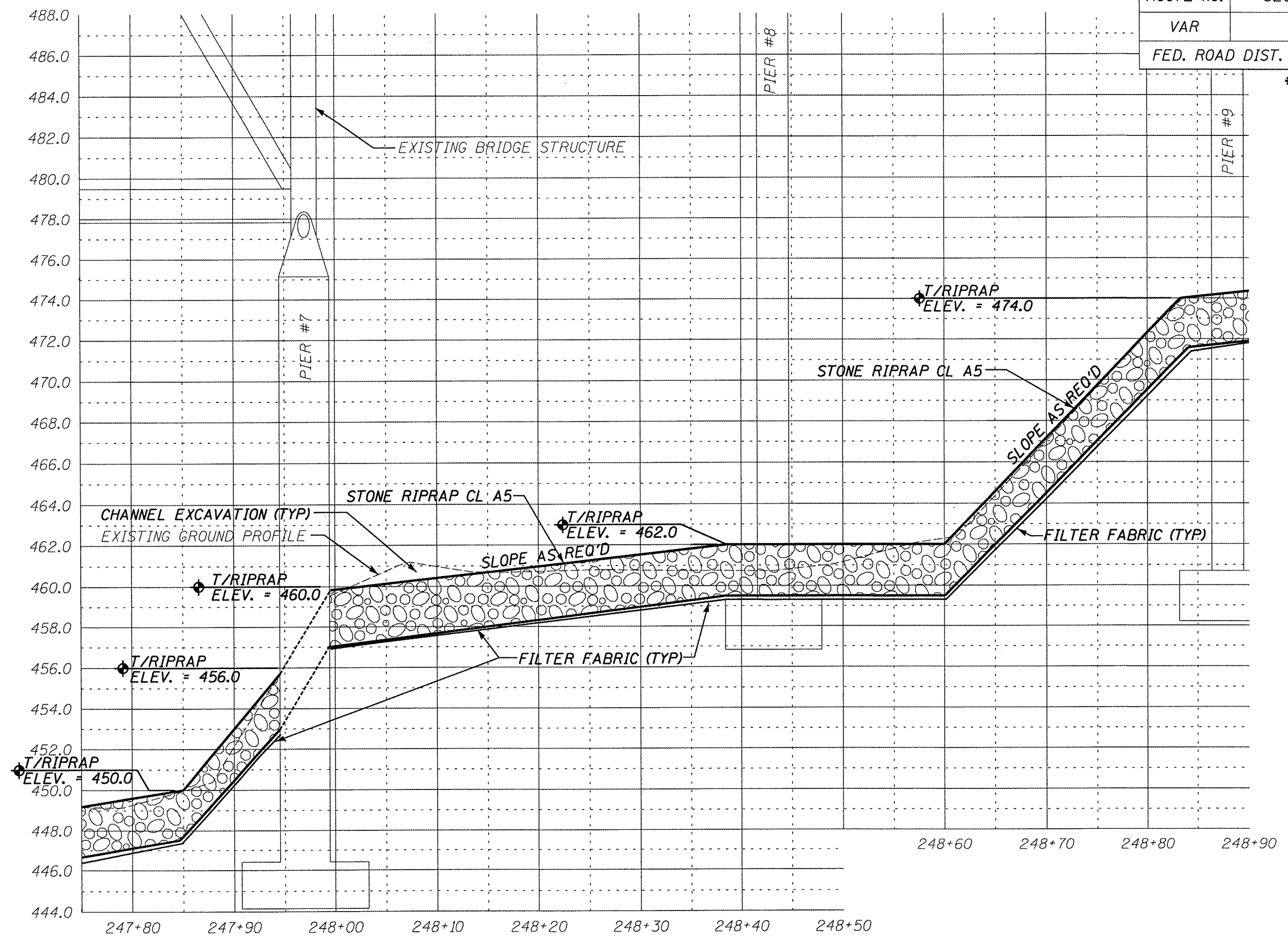

ILLINOIS DEPARTMENT OF TRANSPORTATION  
 SITE CROSS SECTION  
 S.N. 072-0037  
 F.A.P. 669 (IL RTE. 116) OVER  
 BN & CNW R.R., KICKAPOO CREEK  
 & CH 77 F.A. RTE. 669  
 PEORIA COUNTY  
 SCALE: VERT. 1" = 5' HORIZ. 1" = 10' SHEET 11 OF 15