

LEGEND

- R.O.W.
- PROPOSED R.O.W. LINE
- CONSTRUCTION LIMITS
- CONCRETE ABUTMENT
- STREAM CENTERLINE
- EXISTING REVETMENT
- GABION
- PROP SLOPE MATTRESS
- AERIAL ELECTRIC
- ELECTRIC POLE
- UNDERGROUND GAS LINE
- EXISTING FENCE

INDICATES CENTER OF STRUCTURE AT
C OF ROADWAY



ROUTE NO.	SECTION	COUNTY	TOTAL SHEETS	SHEET NO.
VAR	*	VAR	66	25
FED. ROAD DIST. NO. 4		ILLINOIS	FED. AID PROJECT	

* D4 SCOUR MITIGATION 2006

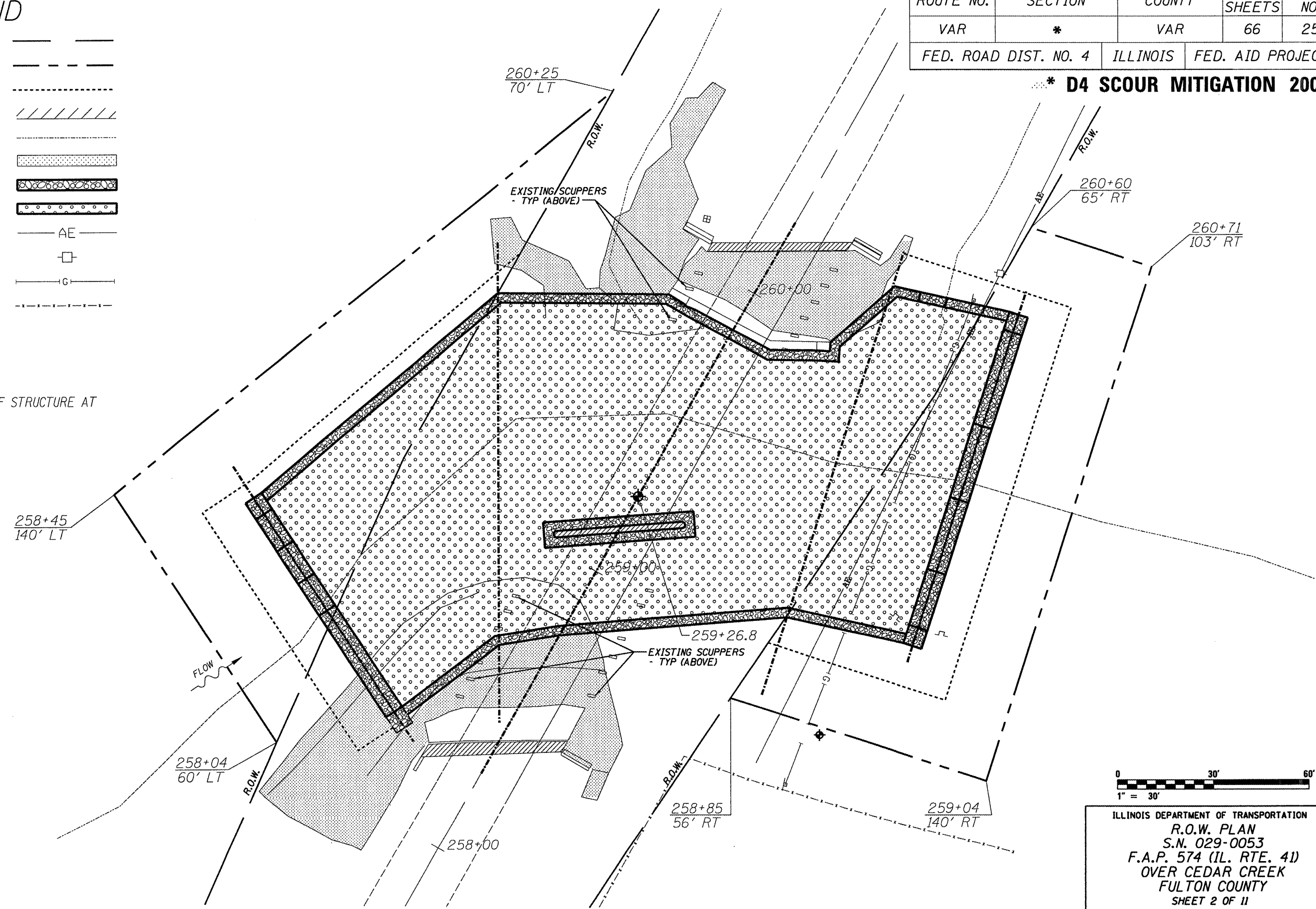

ILLINOIS DEPARTMENT OF TRANSPORTATION
 R.O.W. PLAN
 S.N. 029-0053
 F.A.P. 574 (IL. RTE. 41)
 OVER CEDAR CREEK
 FULTON COUNTY
 SHEET 2 OF 11

SCALE: 1" = 30'