

**SIDE VIEW**

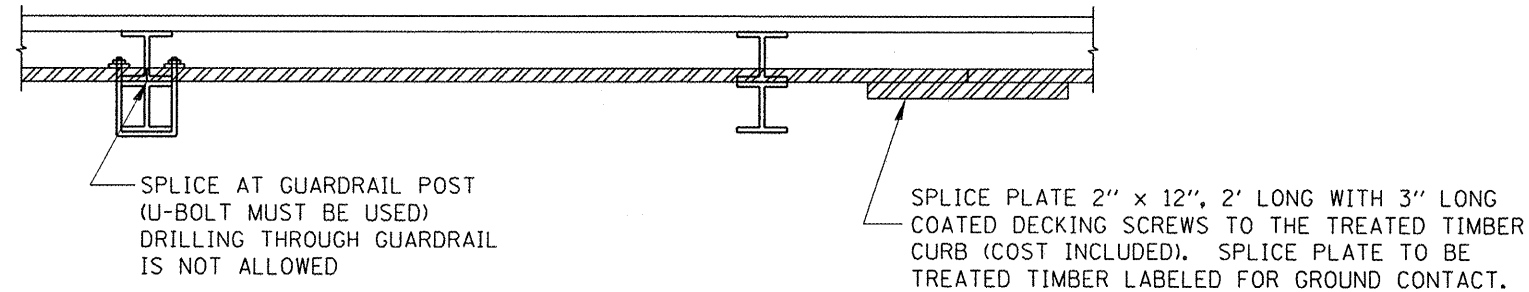

**TOP VIEW**

**NOTE:**

THE TIMBER CURB SHALL BUTT TOGETHER AT THE GUARDRAIL POST OR SPLICED AS SHOWN ON THE DETAIL.

THE TIMBER CURB SHALL BE COMMERCIALY AVAILABLE TREATED LUMBER, LABELED FOR GROUND CONTACT.

THE PRICE FOR TIMBER CURB SHALL INCLUDE THE U-BOLTS ATTACHING THE TREATED TIMBER TO THE GUARDRAIL POSTS, TREATED TIMBER, AND REMOVING DAMAGED LUMBER.

BITUMINOUS CURB REPAIR SHALL BE MEASURED AND PAID FOR AT THE CONTRACT UNIT PRICE PER FOOT.

BITUMINOUS CURB REPAIR SHALL BE IN ACCORDANCE WITH SECTION 408 OF THE STANDARD SPECIFICATIONS.

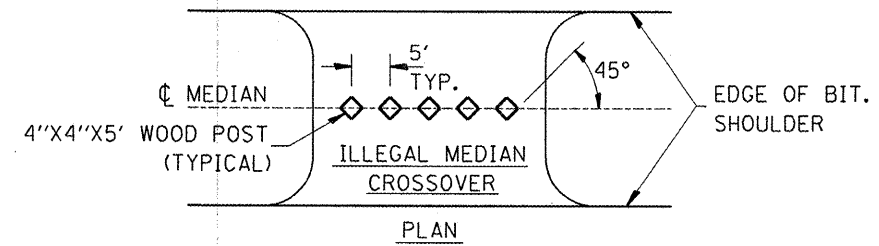

**PLAN**

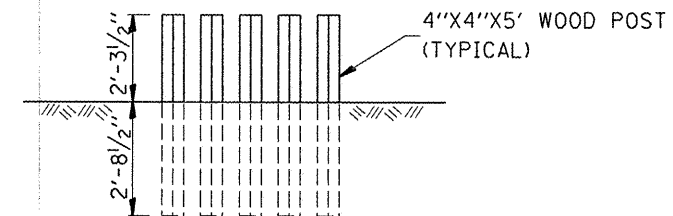

**ELEVATION**

**GUARD POST DETAIL**

**TIMBER CURB & BITUMINOUS CURB REPAIR**

• D-3 HIGHWAY DAMAGE REPAIR 2009

FILE NAME =	USER NAME = schwankerg	DESIGNED -	REVISED -
c:\projects\d366812\d366812-sht-details.dgn		DRAWN -	REVISED -
	PLOT SCALE = 103.1218 / IN.	CHECKED -	REVISED -
	PLOT DATE = May 21, 2008 - 03:34:38 PM	DATE -	REVISED -

**STATE OF ILLINOIS  
DEPARTMENT OF TRANSPORTATION**

**TIMBER CURB & BITUMINOUS CURB REPAIR  
& GUARD POST DETAIL**

SCALE: SHEET NO. OF SHEETS STA. TO STA.

F.A. RTE.	SECTION	COUNTY	TOTAL SHEETS	SHEET NO.
VAR.	*	VAR.	36	8
FED. ROAD DIST. NO. ILLINOIS FED. AID PROJECT			CONTRACT NO. 66812	