

TRAFFIC SIGNAL LEGEND

PROPOSED	EXISTING	PROPOSED	EXISTING
CONTROLLER CABINET		PEDESTRIAN PUSHBUTTON DETECTOR	
SERVICE INSTALLATION		DETECTOR LOOP	
SIGNAL HEAD		CAST IRON JUNCTION BOX	
SIGNAL HEAD WITH BACKPLATE		EMERGENCY VEHICLE LIGHT DETECTOR	
SIGNAL HEAD, PEDESTRIAN		CONFIRMATION BEACON	
SIGNAL POST		SIGNAL HEAD OPTICALLY PROGRAMMED	
MAST ARM ASSEMBLY AND POLE, STEEL		CONDUIT SPLICE	
MAST ARM ASSEMBLY AND POLE, ALUMINUM		WOOD POLE	
COMBINATION MAST ARM ASSEMBLY AND POLE, STEEL WITH LUMINAIRE		RACEWAY FOR MAGNETIC DETECTOR, TYPE I OR TYPE II	
UNIT DUCT		VEHICLE DETECTOR, NON COMPENSATED MAGNETIC TYPE	
COMMON TRENCH		RAILROAD CONTROL CABINET	
HANDHOLE		TELEPHONE CONNECTION	
HEAVY DUTY HANDHOLE		ILLUMINATED SIGN "NO LEFT TURN"	
DOUBLE HANDHOLE		ILLUMINATED SIGN "NO RIGHT TURN"	
G.S. CONDUIT IN TRENCH (T) OR PUSHED (P)		UNINTERRUPTABLE POWER SUPPLY	
		DOME CAMERA (PAN/TILT/ZOOM)	
		VEHICLE DETECTION CAMERA	

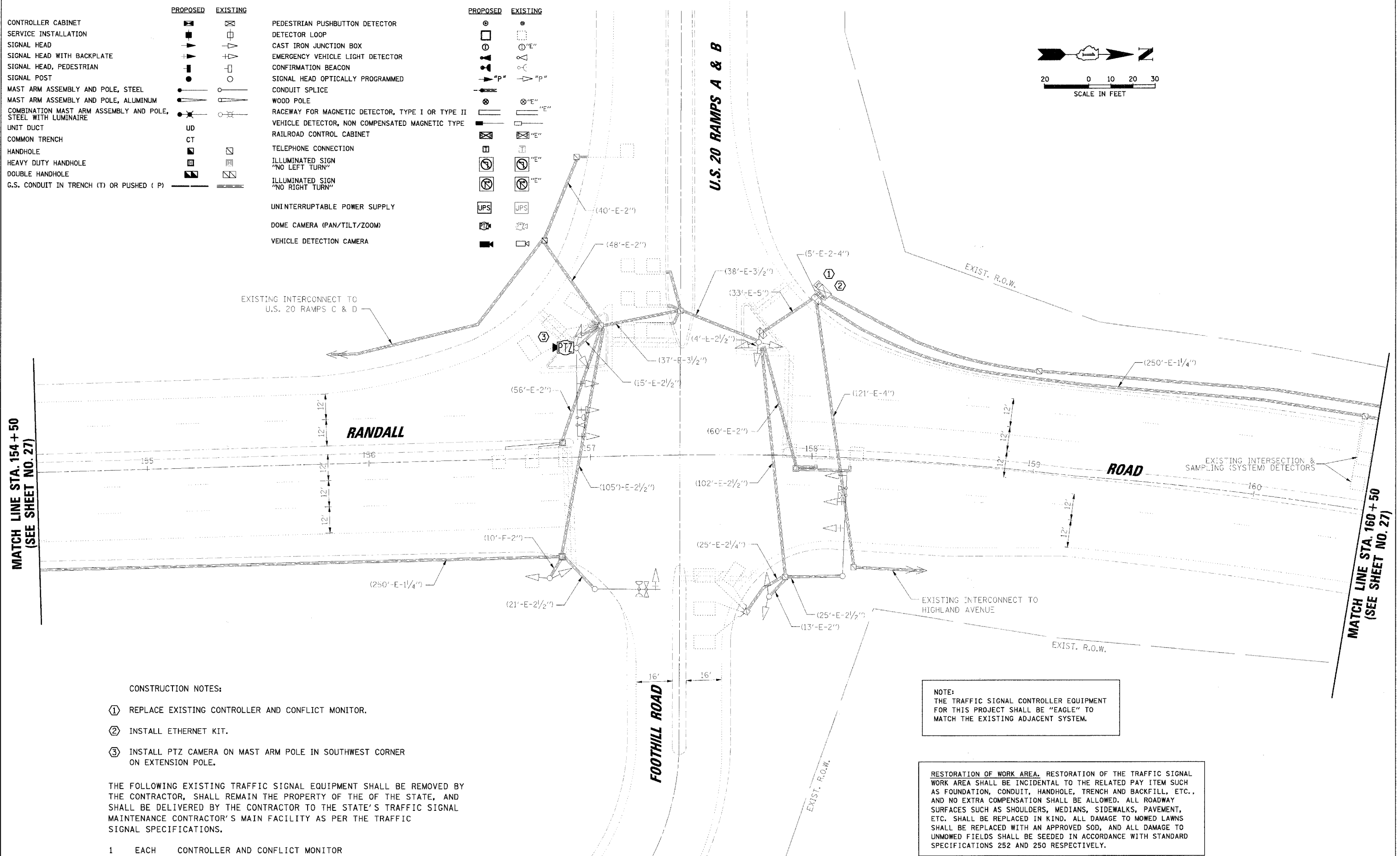
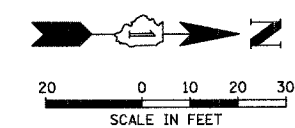

- CONSTRUCTION NOTES:
- REPLACE EXISTING CONTROLLER AND CONFLICT MONITOR.
 - INSTALL ETHERNET KIT.
 - INSTALL PTZ CAMERA ON MAST ARM POLE IN SOUTHWEST CORNER ON EXTENSION POLE.

THE FOLLOWING EXISTING TRAFFIC SIGNAL EQUIPMENT SHALL BE REMOVED BY THE CONTRACTOR, SHALL REMAIN THE PROPERTY OF THE OF THE STATE, AND SHALL BE DELIVERED BY THE CONTRACTOR TO THE STATE'S TRAFFIC SIGNAL MAINTENANCE CONTRACTOR'S MAIN FACILITY AS PER THE TRAFFIC SIGNAL SPECIFICATIONS.

- EACH CONTROLLER AND CONFLICT MONITOR

NOTE:
THE TRAFFIC SIGNAL CONTROLLER EQUIPMENT FOR THIS PROJECT SHALL BE "EAGLE" TO MATCH THE EXISTING ADJACENT SYSTEM.

RESTORATION OF WORK AREA. RESTORATION OF THE TRAFFIC SIGNAL WORK AREA SHALL BE INCIDENTAL TO THE RELATED PAY ITEM SUCH AS FOUNDATION, CONDUIT, HANDHOLE, TRENCH AND BACKFILL, ETC., AND NO EXTRA COMPENSATION SHALL BE ALLOWED. ALL ROADWAY SURFACES SUCH AS SHOULDERS, MEDIANS, SIDEWALKS, PAVEMENT, ETC. SHALL BE REPLACED IN KIND. ALL DAMAGE TO MOWED LAWNS SHALL BE REPLACED WITH AN APPROVED SOD, AND ALL DAMAGE TO UNMOWED FIELDS SHALL BE SEEDED IN ACCORDANCE WITH STANDARD SPECIFICATIONS 252 AND 250 RESPECTIVELY.

DATE	BY	DATE	BY
DATE	BY	DATE	BY
DATE	BY	DATE	BY
DATE	BY	DATE	BY

CHRISTOPHER B. BURKE ENGINEERING LTD.
3575 West Higgins Road, Suite 600
Rosemont, Illinois 60018
(847) 823-0500

MATCH LINE STA. 154 + 50
(SEE SHEET NO. 27)

MATCH LINE STA. 160 + 50
(SEE SHEET NO. 27)