

DATE: \_\_\_\_\_ BY: \_\_\_\_\_  
 SURVEYED: \_\_\_\_\_ CHECKED: \_\_\_\_\_  
 PLOTTED: \_\_\_\_\_ RT. OF WAY CHECKED: \_\_\_\_\_  
 NOTE BOOK: \_\_\_\_\_ NO. \_\_\_\_\_  
 PLAN: \_\_\_\_\_  
 SURVEYED: \_\_\_\_\_ CHECKED: \_\_\_\_\_  
 PLOTTED: \_\_\_\_\_ RT. OF WAY CHECKED: \_\_\_\_\_  
 NOTE BOOK: \_\_\_\_\_ NO. \_\_\_\_\_  
 PROFILE: \_\_\_\_\_  
 SURVEYED: \_\_\_\_\_ CHECKED: \_\_\_\_\_  
 PLOTTED: \_\_\_\_\_ RT. OF WAY CHECKED: \_\_\_\_\_  
 NOTE BOOK: \_\_\_\_\_ NO. \_\_\_\_\_  
 STRUCTURE: \_\_\_\_\_ NOTATIONS: \_\_\_\_\_

**CHRISTOPHER B. BURKE ENGINEERING LTD.**  
 9575 West Higgins Road, Suite 600  
 Rosemont, Illinois 60018  
 (847) 823-0500

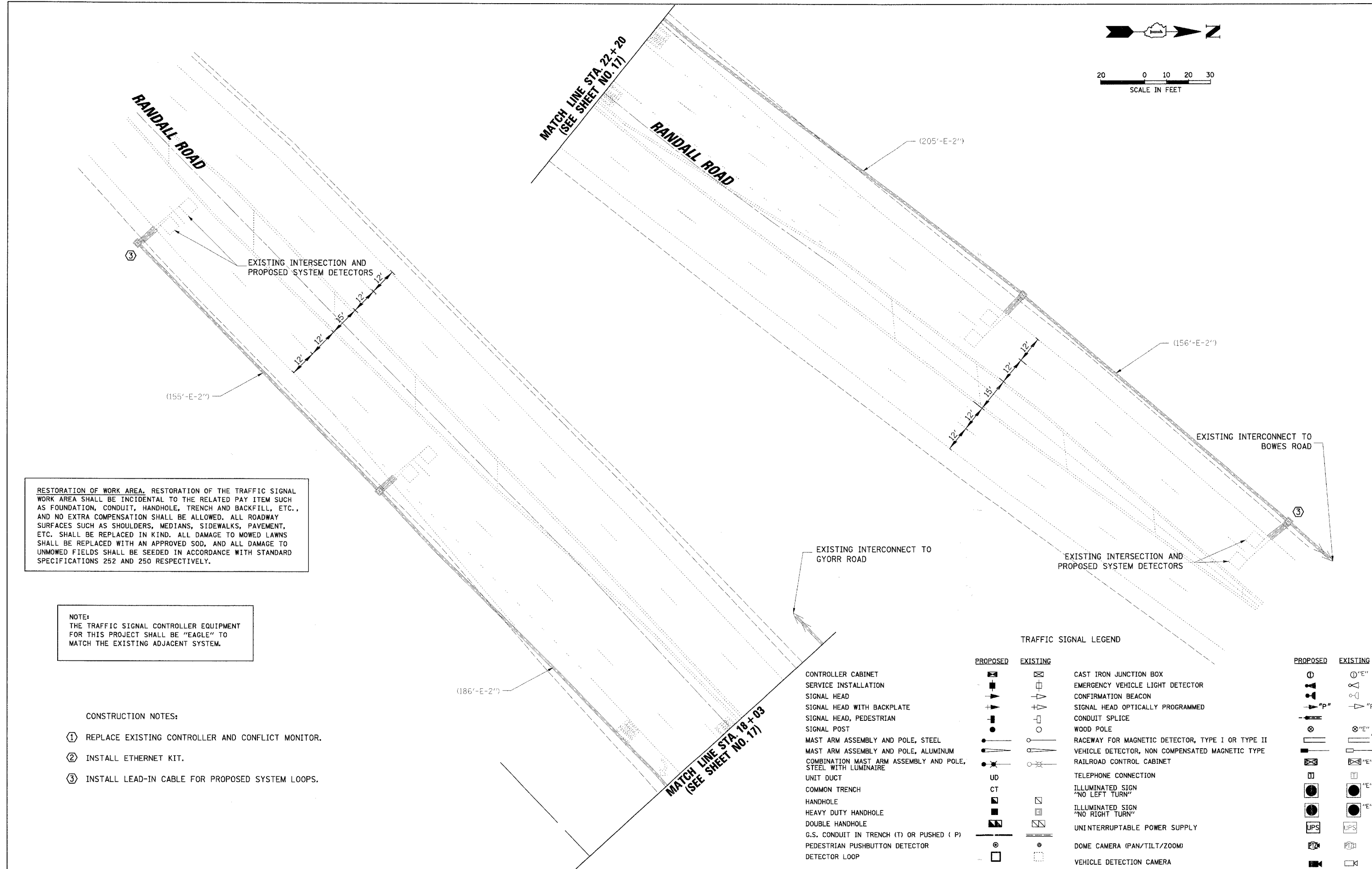
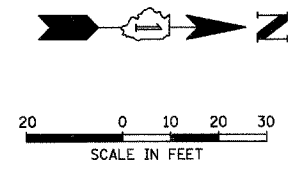

RESTORATION OF WORK AREA. RESTORATION OF THE TRAFFIC SIGNAL WORK AREA SHALL BE INCIDENTAL TO THE RELATED PAY ITEM SUCH AS FOUNDATION, CONDUIT, HANDHOLE, TRENCH AND BACKFILL, ETC., AND NO EXTRA COMPENSATION SHALL BE ALLOWED. ALL ROADWAY SURFACES SUCH AS SHOULDERS, MEDIANS, SIDEWALKS, PAVEMENT, ETC. SHALL BE REPLACED IN KIND. ALL DAMAGE TO MOWED LAWNS SHALL BE REPLACED WITH AN APPROVED SOD, AND ALL DAMAGE TO UNMOWED FIELDS SHALL BE SEED IN ACCORDANCE WITH STANDARD SPECIFICATIONS 252 AND 250 RESPECTIVELY.

NOTE:  
 THE TRAFFIC SIGNAL CONTROLLER EQUIPMENT FOR THIS PROJECT SHALL BE "EAGLE" TO MATCH THE EXISTING ADJACENT SYSTEM.

- CONSTRUCTION NOTES:
- ① REPLACE EXISTING CONTROLLER AND CONFLICT MONITOR.
  - ② INSTALL ETHERNET KIT.
  - ③ INSTALL LEAD-IN CABLE FOR PROPOSED SYSTEM LOOPS.

		TRAFFIC SIGNAL LEGEND	
PROPOSED	EXISTING	PROPOSED	EXISTING