

QUANTITY
 4 (100) LINE = 64.1 ft. (19.7 m)
 21.1 sq. ft. (1.97 sq. m)

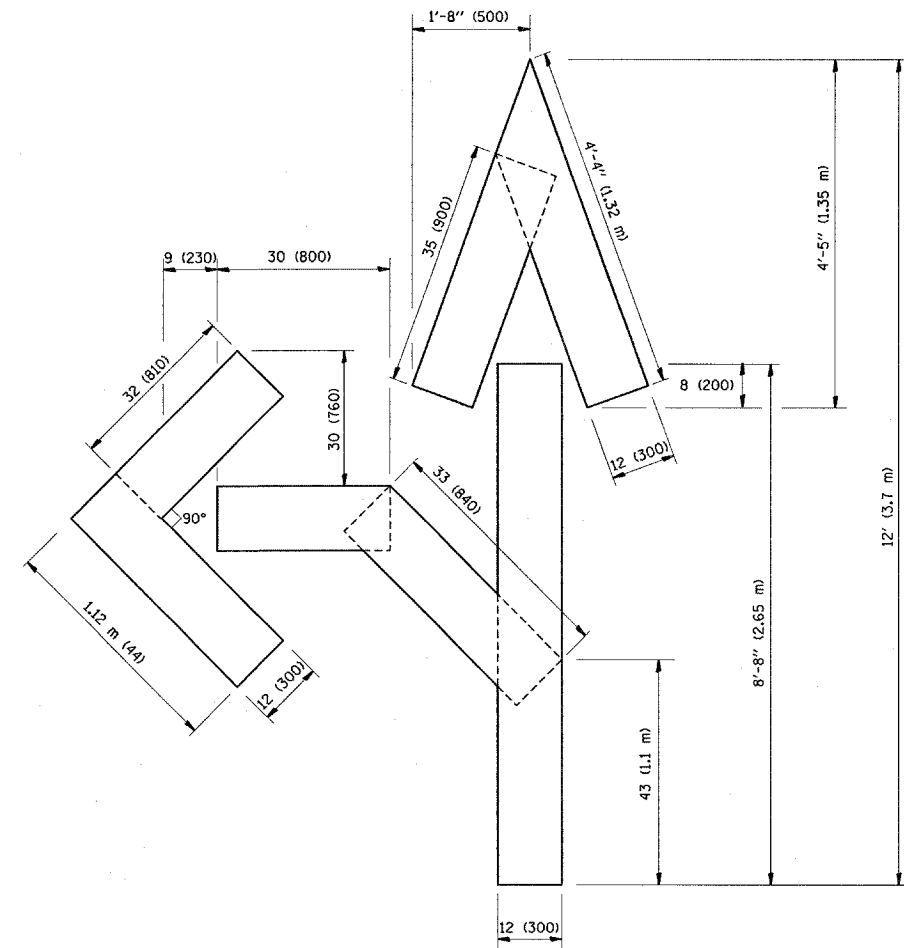

QUANTITY
 4 (100) LINE = 82.5 ft. (25.3 m)
 27.5 sq. ft. (2.53 sq. m)

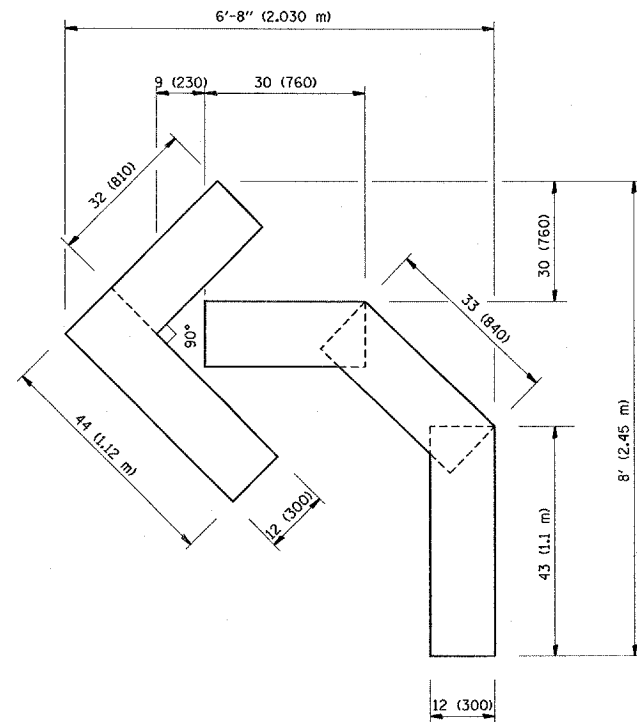

QUANTITY
 4 (100) LINE = 45.5 ft. (13.9 m)
 15.2 sq. ft. (1.39 sq. m)

All dimensions are in Inches (millimeters) unless otherwise shown.

FILE NAME =	USER NAME = wilgreendp	DESIGNED -	REVISED -T. RAMMACHER 06-05-96
\\dist\dfs2\users\wilgreendp\Desktop\IL	176 (US 14 TO IL 3D DETAILS)to16.dgn	DRAWN -	REVISED -T. RAMMACHER 11-04-97
	PLOT SCALE = 49.9999 ' / IN.	CHECKED -	REVISED -T. RAMMACHER 03-02-98
	PLOT DATE = 4/7/2008	DATE - 09-18-94	REVISED -E. GOMEZ 08-28-00

**STATE OF ILLINOIS
 DEPARTMENT OF TRANSPORTATION**

**PAVEMENT MARKING LETTERS AND SYMBOLS
 FOR TRAFFIC STAGING**

SCALE: NONE SHEET NO. 23 OF 26 SHEETS STA. TO STA.

F.A.P. RTE.	SECTION	COUNTY	TOTAL SHEETS	SHEET NO.
335	I20RS-4	MCHENRY	26	23
TC-16			CONTRACT NO. 60B62	
FED. ROAD DIST. NO. 1 ILLINOIS FED. AID PROJECT				