

| | | | |
|-----------------------|-----------|---------------------------|-----------------|
| CONTRACT NO. 60A49 | | | |
| F.A.U. RTE. | SECTION | COUNTY | TOTAL SHEET NO. |
| 1321 | 0711 RS-2 | COOK | 38 22 |
| STA. | | TO STA. | |
| FED. ROAD DIST. NO. 1 | | ILLINOIS FED. AID PROJECT | |

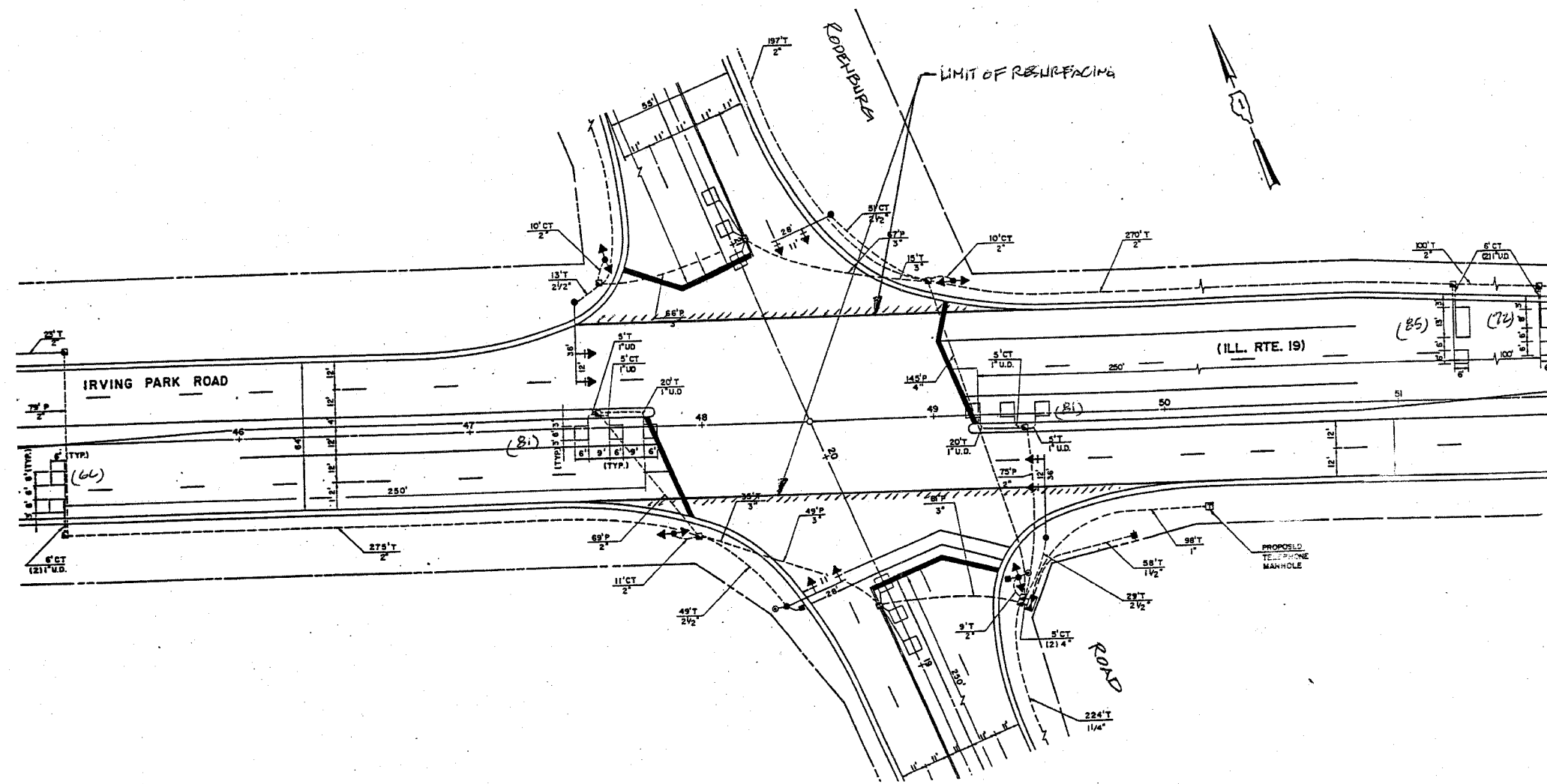

REPLACE ALL DETECTOR LOOPS AS SHOWN

(WITHIN THE RESURFACING LIMITS)

| CODE NO. | QUANTITY | UNIT | ITEM |
|----------|----------|------|---------------------------|
| | 385 | Foot | Detector Loop Replacement |

NOTE:

THIS PLAN IS FOR THE PURPOSE OF REPLACING THE DETECTOR LOOPS ONLY. ALL OTHER INFORMATION SHOWN IS NOT RELATED AND WILL BE DISREGARDED.

PLOT DATE = 9/29/2005
 FILE NAME = c:\projects\10862208\design\endp
 PLOT SCALE = 50.0000 / 1" = 100'
 USER NAME = gelbannb

| REVISIONS | | DATE |
|-----------|--|------|
| NAME | | |
| | | |
| | | |
| | | |
| | | |
| | | |
| | | |
| | | |
| | | |
| | | |
| | | |

ILLINOIS DEPARTMENT OF TRANSPORTATION

**FAU 1321: ILL 19 (IRVING PARK ROAD)
WISE ROAD TO COOK-DUPAGE COUNTY LINE
DETECTOR LOOP REPLACEMENT
ILL RTE 19 (IRVING PARK ROAD)
@ RODENBURG ROAD**

SCALE: VERT. _____
HORIZ. _____
DATE _____

DRAWN BY _____
CHECKED BY _____