

F.A.I. RTE.	SECTION	COUNTY	TOTAL SHEETS	SHEET NO.
55		WILL	608	271
STA.		TO STA.		
FED. ROAD DIST. NO. 1		ILLINOIS	FED. AID PROJECT	
		(26, 26HB-1&114) R-2	CONTRACT NO. 60363	

NOTE:  
 ALL EXISTING SIGNS TO BE REMOVED SHALL BECOME PROPERTY OF THE CONTRACTOR, EXCEPT AS NOTED IN THE SIGNING INVENTORY. SIGNS PLACED BY THE HEARTLAND DEVELOPER SHALL BE REMOVED WITH THE APPROVAL OF THE ENGINEER AND THE HEARTLAND DEVELOPER.

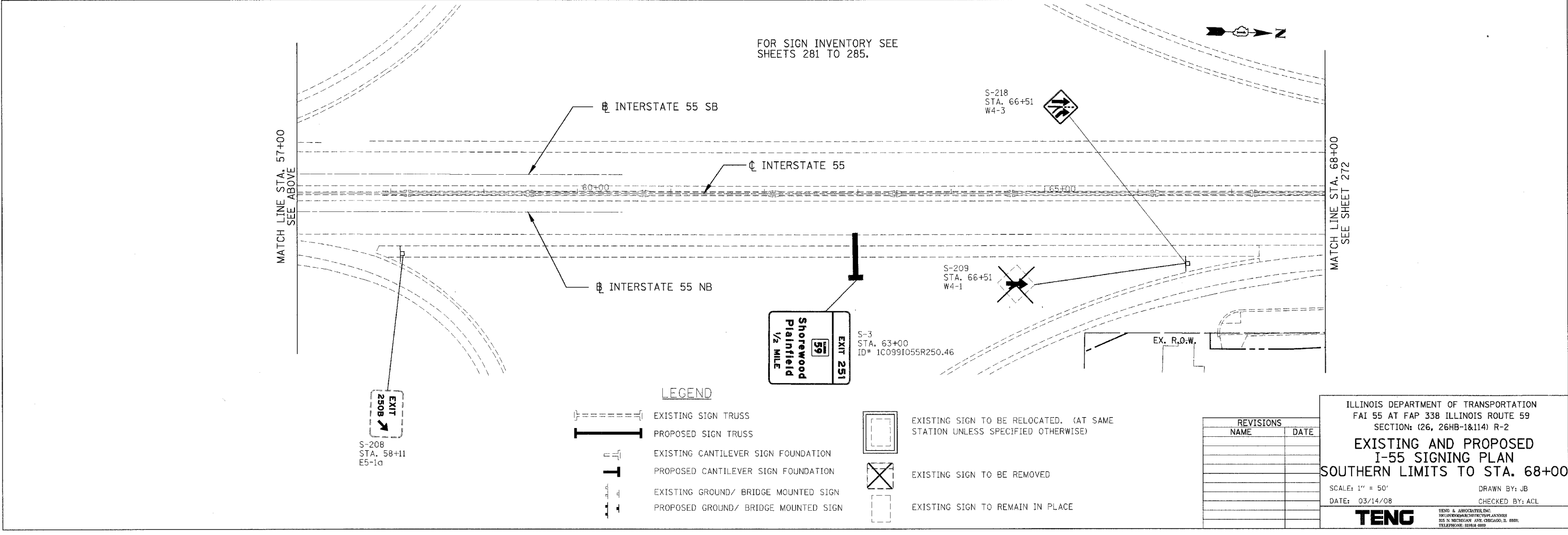
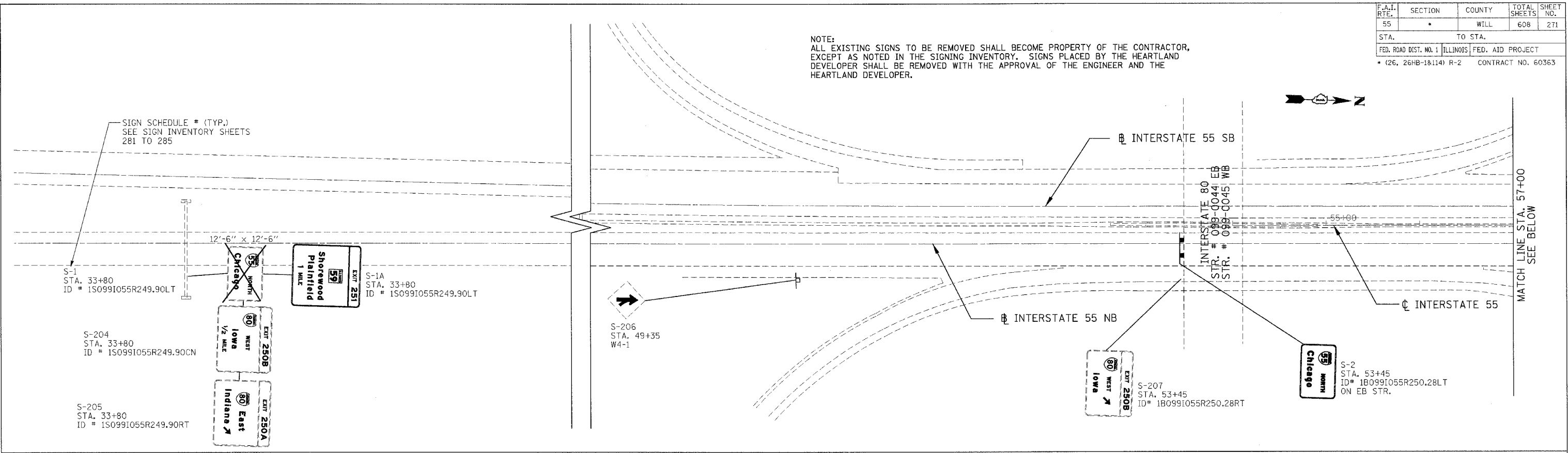

**LEGEND**

	EXISTING SIGN TRUSS		EXISTING SIGN TO BE RELOCATED. (AT SAME STATION UNLESS SPECIFIED OTHERWISE)
	PROPOSED SIGN TRUSS		EXISTING SIGN TO BE REMOVED
	EXISTING CANTILEVER SIGN FOUNDATION		EXISTING SIGN TO REMAIN IN PLACE
	PROPOSED CANTILEVER SIGN FOUNDATION		
	EXISTING GROUND/ BRIDGE MOUNTED SIGN		
	PROPOSED GROUND/ BRIDGE MOUNTED SIGN		

REVISIONS	
NAME	DATE

ILLINOIS DEPARTMENT OF TRANSPORTATION  
 FAI 55 AT FAP 338 ILLINOIS ROUTE 59  
 SECTION: (26, 26HB-1&114) R-2  
**EXISTING AND PROPOSED  
 I-55 SIGNING PLAN**  
 SOUTHERN LIMITS TO STA. 68+00  
 SCALE: 1" = 50'  
 DATE: 03/14/08  
 DRAWN BY: JB  
 CHECKED BY: ACL

**TENG**  
 TENG & ASSOCIATES, INC.  
 255 N. MICHIGAN AVE. CHICAGO, IL 60610  
 TELEPHONE: 312.924.2000

\*\*VAL TOORH6.DGN...S-208...S-209...S-218...S-3...S-1...S-204...S-205...S-206...S-207...S-2...EXIT 251...EXIT 250B...EXIT 250A...MATCH LINE STA. 57+00...MATCH LINE STA. 68+00...FOR SIGN INVENTORY SEE SHEETS 281 TO 285...SIGN SCHEDULE \* (TYP.) SEE SIGN INVENTORY SHEETS 281 TO 285...ILLINOIS DEPARTMENT OF TRANSPORTATION...SECTION: (26, 26HB-1&114) R-2...CONTRACT NO. 60363...DATE: 03/14/08...DRAWN BY: JB...CHECKED BY: ACL...