

**EXISTING**

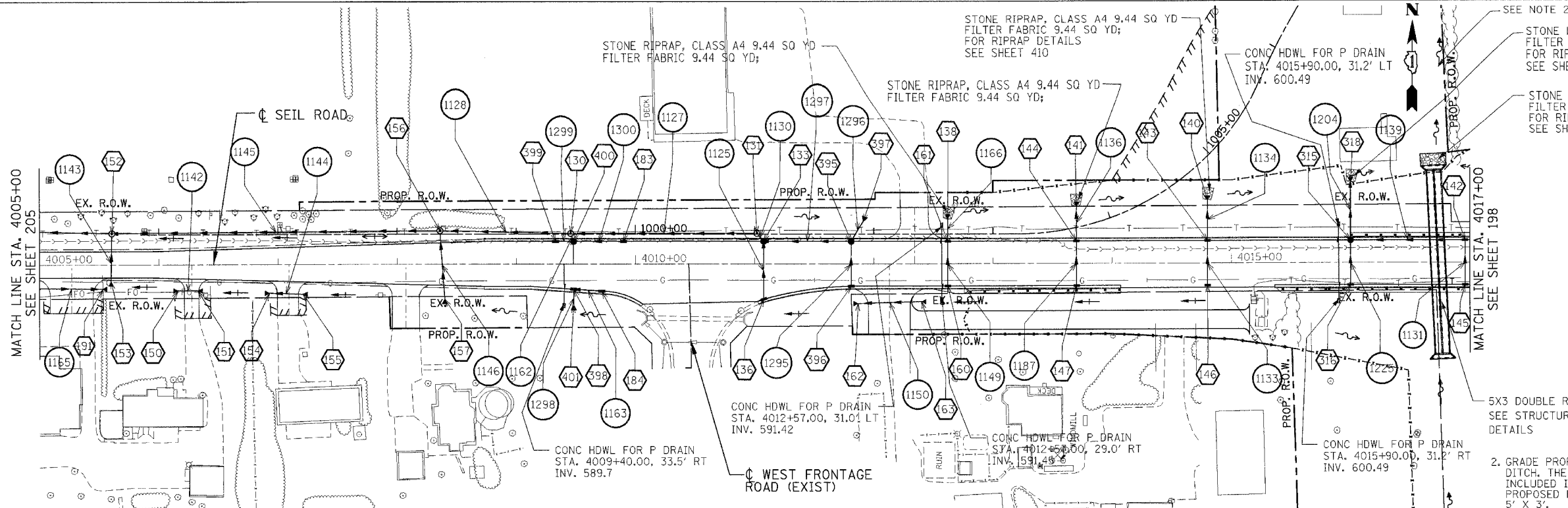

**PROPOSED**

- LEGEND**
- |  |                                   |  |                    |  |                          |  |  |  |                 |
|--|-----------------------------------|--|--------------------|--|--------------------------|--|--|--|-----------------|
|  | STRUCTURE NUMBER                  |  | EX. INLET          |  | PROP. INLET              |  | FILL STRUCTURE                                   |  | EX. FIBER OPTIC |
|  | PIPE NUMBER                       |  | EX. CATCH BASIN    |  | PROP. CATCH BASIN        |  | ADJUST STRUCTURE                                 |  | EX. TELEPHONE   |
|  | PIPE REMOVAL                      |  | EX. MANHOLE        |  | PROP. MANHOLE            |  | MOVE STRUCTURE                                   |  | EX. GAS         |
|  | CONCRETE HEADWALL FOR PIPE DRAINS |  | EX. STORM SEWER    |  | PROP. STORM SEWER        |  | ADJUST FRAME & LID                               |  | EX. WATER       |
|  |                                   |  | EX. SANITARY SEWER |  | PROP. DITCH              |  | RECONSTRUCT STR.                                 |  | EX. ELECTRIC    |
|  |                                   |  | EX. DITCH          |  | PROP. SWALE              |  | CLEAN STRUCTURE                                  |  | EX. CABLE TV    |
|  |                                   |  | REMOVE STRUCTURE   |  | PROP. FLARED END SECTION |  | PROP. PIPE UNDERDRAINS, 6" OR 4" (SEE SCHEDULES) |  |                 |

**NOTES:**  
 1. FOR STRUCTURE AND PIPE INFORMATION, SEE DRAINAGE SCHEDULES SHEET 216 TO 221.

REVISIONS	
NAME	DATE

ILLINOIS DEPARTMENT OF TRANSPORTATION  
 FAI 55 AT FAP 338 ILLINOIS ROUTE 59  
 SECTION: (26, 26HB-1&114) R-2

**EXISTING AND PROPOSED  
 SEIL RD DRAINAGE & UTILITIES  
 STA. 4005+00 TO STA. 4017+00**

SCALE: 1" = 50'  
 DATE: 03/14/08  
 DRAWN BY: MRK  
 CHECKED BY: TKL

**TENG**  
TENG & ASSOCIATES, INC.  
 ENGINEERS/ARCHITECTS/PLANNERS  
 305 N. MICHIGAN AVE., CHICAGO, IL 60601  
 TELEPHONE: 312.644.6000

\\ALT00166.DGN, \\SURG001.DGN, \\SURG002.DGN, \\SURG003.DGN, \\SURG004.DGN, \\SURG005.DGN, \\SURG006.DGN, \\SURG007.DGN, \\SURG008.DGN, \\SURG009.DGN, \\SURG010.DGN, \\SURG011.DGN, \\SURG012.DGN, \\SURG013.DGN, \\SURG014.DGN, \\SURG015.DGN, \\SURG016.DGN, \\SURG017.DGN, \\SURG018.DGN, \\SURG019.DGN, \\SURG020.DGN, \\SURG021.DGN, \\SURG022.DGN, \\SURG023.DGN, \\SURG024.DGN, \\SURG025.DGN, \\SURG026.DGN, \\SURG027.DGN, \\SURG028.DGN, \\SURG029.DGN, \\SURG030.DGN, \\SURG031.DGN, \\SURG032.DGN, \\SURG033.DGN, \\SURG034.DGN, \\SURG035.DGN, \\SURG036.DGN, \\SURG037.DGN, \\SURG038.DGN, \\SURG039.DGN, \\SURG040.DGN, \\SURG041.DGN, \\SURG042.DGN, \\SURG043.DGN, \\SURG044.DGN, \\SURG045.DGN, \\SURG046.DGN, \\SURG047.DGN, \\SURG048.DGN, \\SURG049.DGN, \\SURG050.DGN, \\SURG051.DGN, \\SURG052.DGN, \\SURG053.DGN, \\SURG054.DGN, \\SURG055.DGN, \\SURG056.DGN, \\SURG057.DGN, \\SURG058.DGN, \\SURG059.DGN, \\SURG060.DGN