

F.A.I. RTE.	SECTION	COUNTY	TOTAL SHEETS	SHEET NO.
55		WILL	608	64
STA.	TO STA.			
FED. ROAD DIST. NO. 1	ILLINOIS	FED. AID PROJECT		
*(26, 26HB-1&114) R-2			CONTRACT NO. 60363	

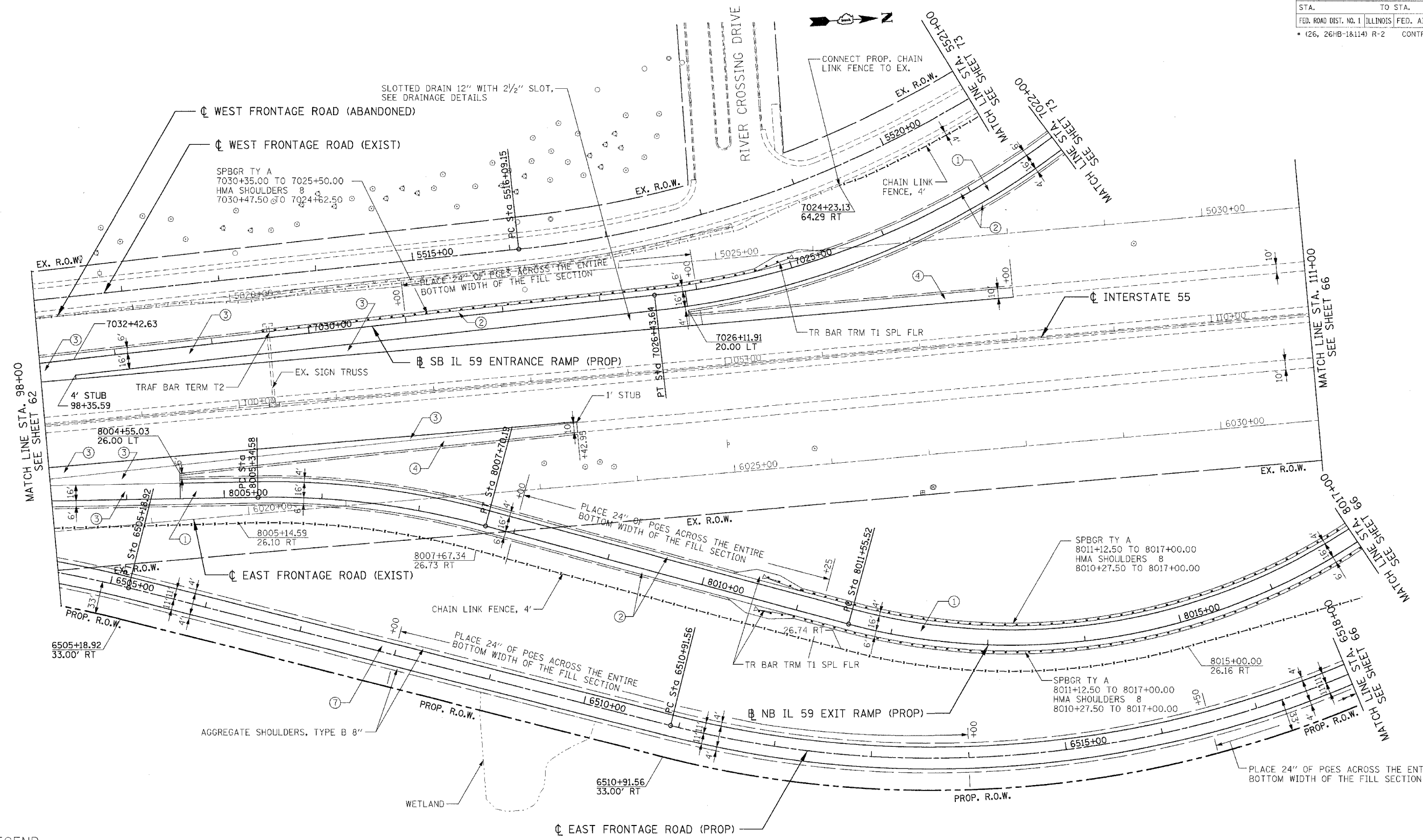

LEGEND

[Symbol]	PAVEMENT REMOVAL
[Symbol]	PAVED SHOULDER REMOVAL (INCLUDES GORE AREAS)
[Symbol]	DRIVEWAY PAVEMENT REMOVAL (INCL. PARKING LOTS)
[Symbol]	AGGREGATE REMOVAL TO BE PAID FOR AS EARTH EXCAVATION
[Symbol]	HOT-MIX ASPHALT SURFACE REMOVAL, 2" SEE SHEET 422 FOR DETAILS
[Symbol]	LINEAR REMOVALS
(6)	TREE REMOVAL (WITH DIAMETER)
[Symbol]	BUSH/ SHRUB REMOVAL (REMOVAL INCLUDED IN COST OF EARTHWORK)
(9)	TREE TRUNK PROTECTION (TTP)

1	NB & SB IL59 RAMPS PCC PVT 9¾ JOINTD STAB SUBBASE HMA 4 AGG SUBGRADE 12
2	HMA SHOULDERS 8 AGG SUBGRADE 12
3	I-55 AUX LANE WIDENING HMA PAVT FD 17 AGG SUBGRADE 12
4	HMA SHOULDERS 13 AGG SUBGRADE 12
5	IL ROUTE 59 PCC PVT 9¾ JOINTD AGG SUBGRADE 12

6	SEIL ROAD HMA PAVT FD 15¾ AGG SUBGRADE 12
7	EAST FRONTAGE ROAD HMA PAVT FD 9 AGG SUBGRADE 12
8	PCC DRIVEWAY PAVT 8
9	PCC DRIVEWAY PAVT 6

NOTES:
 1. SEE SHEET 216 TO SHEET 220 FOR DRAINAGE SCHEDULE.
 2. COST OF PLANTER REMOVAL SHALL BE INCLUDED IN THE COST OF PAVEMENT REMOVAL.
 3. SEE SHEET 421 FOR DRIVEWAY SCH. ALL IL59 DRIVEWAYS SHALL BE HMA BEYOND R.O.W. LIMITS EXCEPT AS NOTED.

REVISIONS	
NAME	DATE

3B OF 12

ILLINOIS DEPARTMENT OF TRANSPORTATION
 FAI 55 AT FAP 338 ILLINOIS ROUTE 59
 SECTION: (26, 26HB-1&114) R-2

**PROPOSED
 I-55 ROADWAY PLAN
 STA. 98+00 TO STA. 111+00**

SCALE: 1" = 50'
 DATE: 03/14/08
 DRAWN BY: JB
 CHECKED BY: ACL

TENG & ASSOCIATES, INC.
 ENGINEERING ARCHITECTURE PLANNING
 800 N. MICHIGAN AVENUE, CHICAGO, IL 60611
 TEL: 312.926.8800 FAX: 312.926.8801